



# KILGORE GRAND PARKWAY

BAYTOWN, TEXAS

## HIGHLIGHTS

- 522,135 SF
- Cross Dock
- 40' Clear Height
- 60' Speed Bays
- Frontage on Grand Parkway
- Close Proximity to Port of Houston
- Chambers County Tax Incentives



# KILGORE GRAND PARKWAY

BAYTOWN, TEXAS

## PROPOSED SITE PLAN

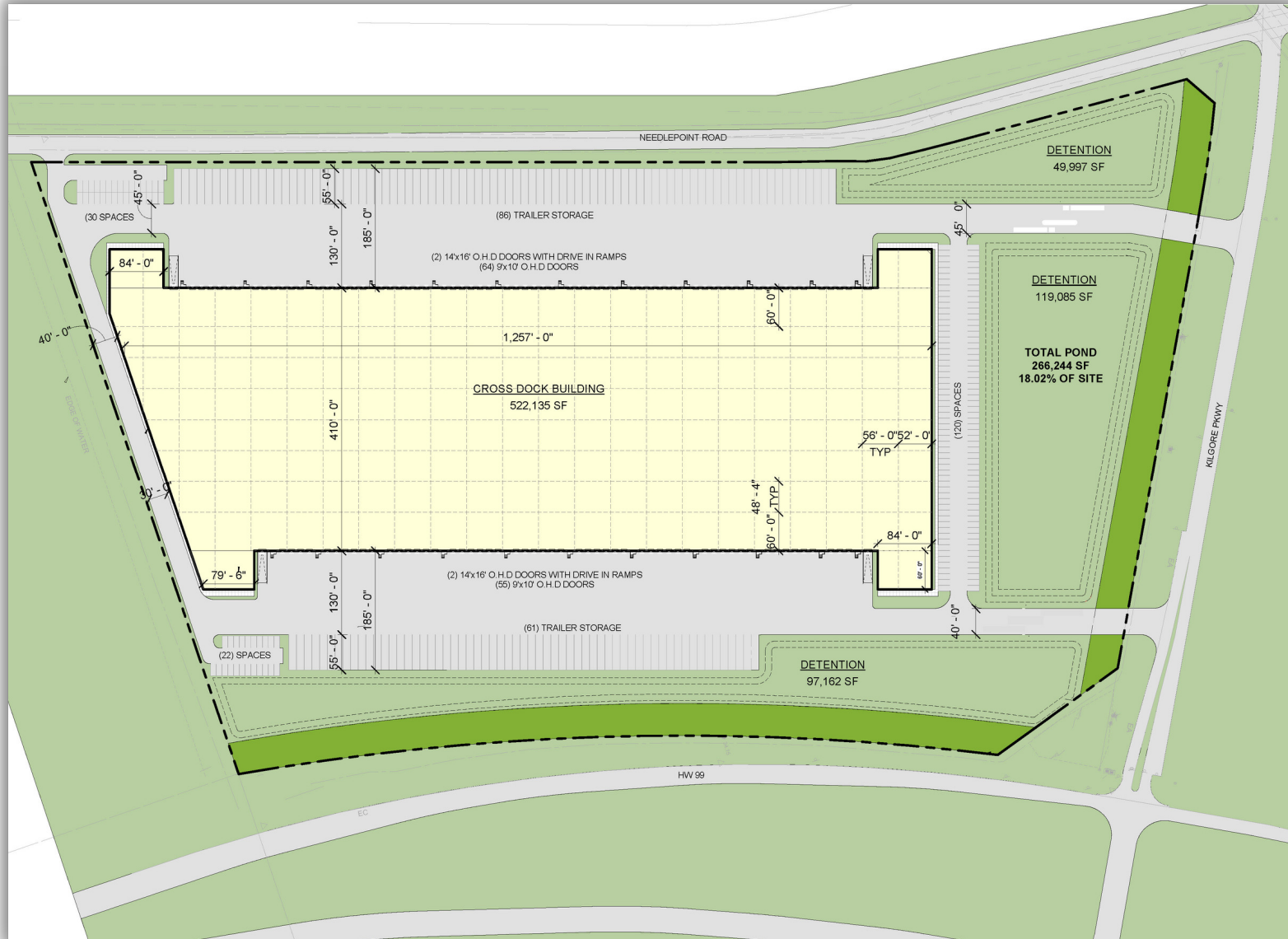



# KILGORE GRAND PARKWAY

## BAYTOWN, TEXAS

### LOCATION

Strategically located with frontage on Grand Parkway, 1 mile from I-10 in Southeast Houston. Close proximity to Port of Houston and container terminals.

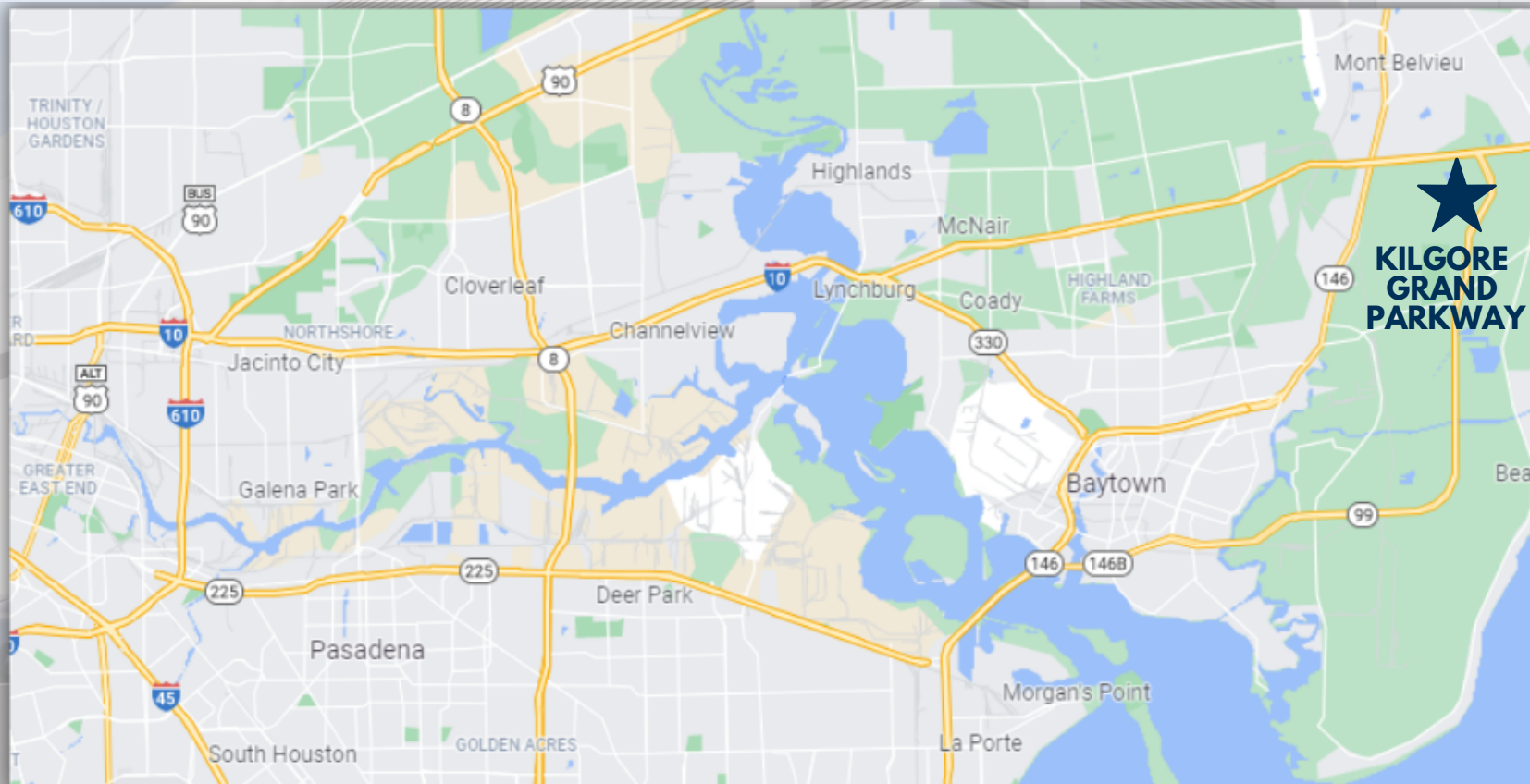

FOR MORE INFORMATION

**RICK KIGHT**  
Executive Vice President, Development  
The Avera Companies  
713.800.9647  
RKight@averacompanies.com

**B. KELLEY PARKER, III SIOR**  
Vice Chairman  
Cushman & Wakefield  
713.963.2896  
kelley.parker@cushwake.com

