

CAUTION



2 person

Do NOT unpack with only one person.
Desk is heavy and can tip over causing serious injury.
Always use two or more people to unpack and set up desk.
Immediately rotate feet to 45 degrees or more.



This device complies with part 15 of the FCC rules. Operation is subject to the following two conditions: (1) This device may not cause harmful interference, and (2) this device must accept any interference received, including interference that may cause undesired operation.

Note: This equipment has been tested and found to comply with the limits for a Class A digital device, pursuant to part 15 of the FCC Rules. These limits are designed to provide reasonable protection against harmful interference when the equipment is operated in a commercial environment. This equipment generates, uses, and can radiate radio frequency energy and, if not installed and used in accordance with the instruction manual, may cause harmful interference to radio communications. Operation of this equipment in a residential area is likely to cause harmful interference in which case the user will be required to correct the interference at his own expense.

Important: Changes or modifications to this product not authorized by AMQ could void your authority to operate the product.

CONTENTS

IMPORTANT SAFETY INSTRUCTIONS	3-5
WORKSURFACE REPLACEMENT	6-12
REAR PANEL SLOT REPLACEMENT	13-19
REAR HANDSET REPLACEMENT	20-30
FRONT & REAR CASTORS REPLACEMENT	31-41
FOOT LOCK SWITCH REPLACEMENT	42-52
POWER CORD REPLACEMENT	53-64

IMPORTANT SAFETY INSTRUCTIONS

READ ALL INSTRUCTIONS BEFORE USING THIS FURNISHING.

PLEASE SAVE THESE INSTRUCTIONS IN AN OBVIOUS PLACE FOR THE END USER AFTER ASSEMBLY.

WARNING



When using an electrical furnishing, basic precautions should always be followed, including the following:

WARNING – To reduce the risk of burns, fire, electric shock, or injury to persons:

Always unplug this furnishing from the electrical outlet before cleaning or servicing.

1. Close supervision is necessary when this furnishing is used by, or near children, invalids, or disabled persons.
2. Use this furnishing only for its intended use as described in these instructions. Do not use attachments not recommended by the manufacturer.
3. Never operate this furnishing if it has a damaged cord or plug, if it is not working properly, if it has been dropped or damaged, or dropped into water. Return the furnishing to a service center for examination and repair.
4. Keep the cord away from heated surfaces.
5. Do not use outdoors.
6. To disconnect, turn all controls to the off position, then remove plug from outlet.
7. MAX Loading - 10Amps. Do not overload integrated sockets.
8. For continued protection against risk of fire, replace only with same type and rating of fuse 250V, 10A.

WARNING



Do not adjust feet parallel with frame (0 degrees), desk may fall causing injury.
To move or store desk:

1. Adjust desk to lowest height position.
2. Keep feet at 90 degrees for improved stability
3. Feet may be adjusted to 45 degrees for moving through doors, or for storage

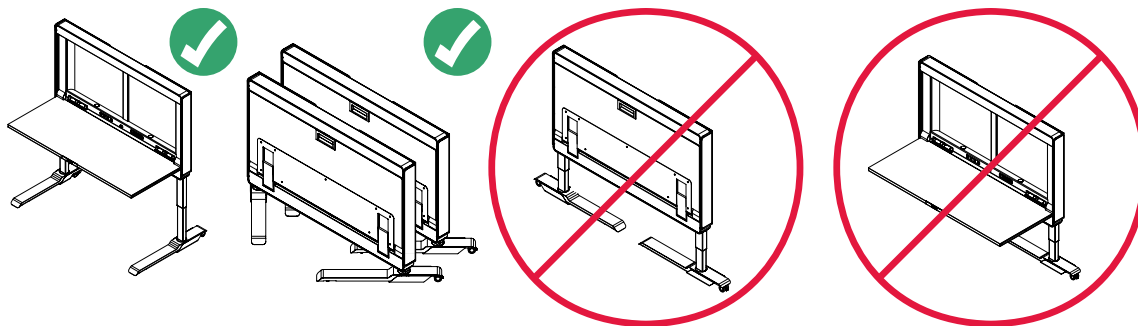



WARNING



RISK OF INJURY. Do not sit or stand on product. Use only as intended.
Inspect regularly. **STOP** using if product is damaged or has loose parts.
Only repair with AMQ authorized parts and methods.

⚠ CAUTION

	 2 person	<p>Do NOT unpack with only one person. Desk is heavy and can tip over causing serious injury. Always use two or more people to unpack and set up desk. Immediately rotate feet to 45 degrees or more.</p>
---	--	--

⚠ WARNING



Crush Hazard - Keep Clear



MAX ≤ 176 lb
80 kg



Read Directions and Manual first

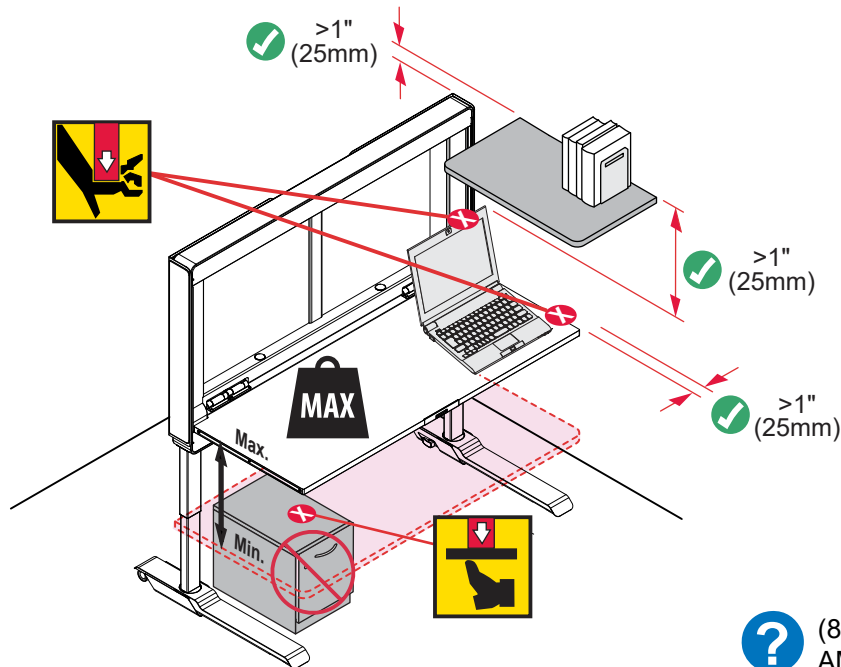

 (877) 801-0370
AMQSolutions.com

- **RISK OF DEATH OR SERIOUS INJURY.** Raising or lowering desk can trap, pinch or crush body parts or property. Not to be used in locations where children, or people with cognitive disabilities are anticipated to be present and not supervised.
- **CRUSH HAZARD - DO NOT PLACE FEET, LEGS OR OTHER BODY PARTS ON OBJECTS PLACED UNDER TABLE TOP OR BELOW MODESTY PANEL.**
- **DO NOT OPERATE THIS EQUIPMENT** Unless Properly Trained.
- **DO NOT ALLOW USE BY CHILDREN** or people unable to understand the risks and to safely adjust the desk height.
- **Maintain > 1" (25mm) gap above objects on desk at max. height and between the desk and adjacent objects.** Locate desk, accessories and nearby objects to allow movement of desktop through full range without pulling cords, trapping body parts or colliding with anything (shelves, electrical plugs and cords, door knobs, window sills, storage cabinets, etc.).

CAUTION



Do NOT install any kind of equipment like wire-tray, wire management systems, baskets and storage on or below the desk worksurface. FAILURE TO FOLLOW THESE INSTRUCTIONS COULD RESULT IN PROPERTY DAMAGE OR PERSONAL INJURY.

CAUTION

Crush Hazard - Keep hands and fingers away when closing or opening desk worksurface.

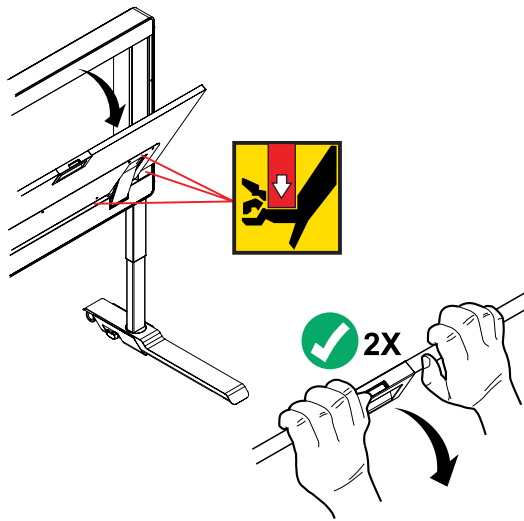

The desk must be positioned near an easily accessible power outlet.

GROUNDING INSTRUCTIONS (for grounded products only)

For products sold in North America and other 120V regions: the product is for use on a nominal 120-V circuit. These products use a grounded plug that looks like the plug illustrated in sketch A in Figure 1. Make sure that the product is connected to an outlet having the same configuration as the plug. No adapter should be used with this product.

Products with Grounded Plugs

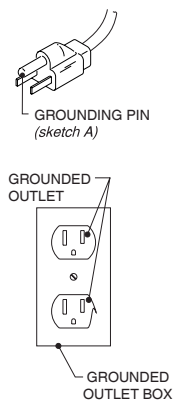
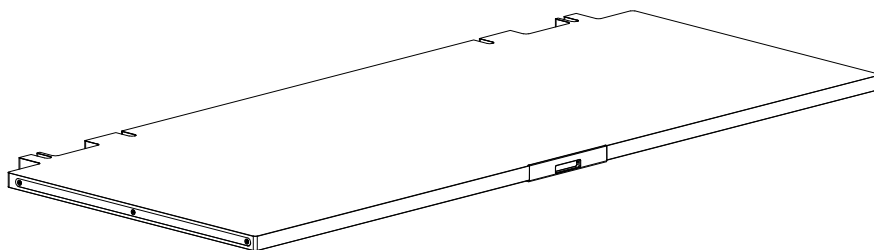

Figure 1
Grounding methods

WORKSURFACE REPLACEMENT



COMPONENTS



Worksurface

TOOL REQUIRED



Electric Drill
x 1

WORKSURFACE REPLACEMENT

Step 1

Use an electric drill to remove 9 screws on the Worksurface.

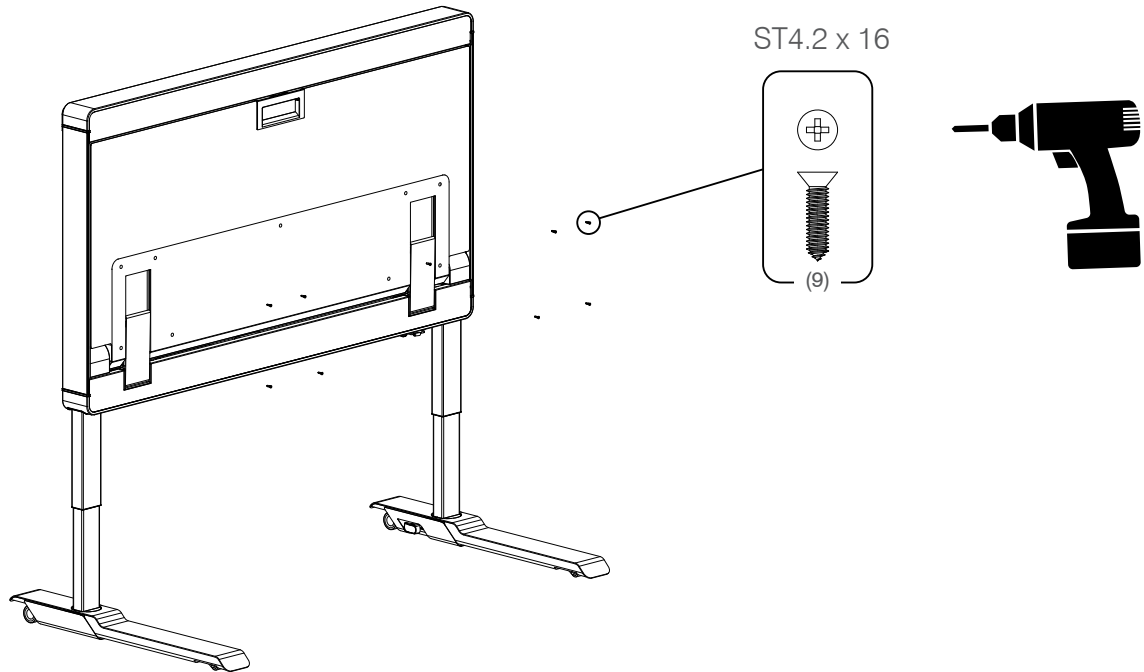

Step 2

Press and hold the Handle Button (1) and pull down the Worksurface (2).

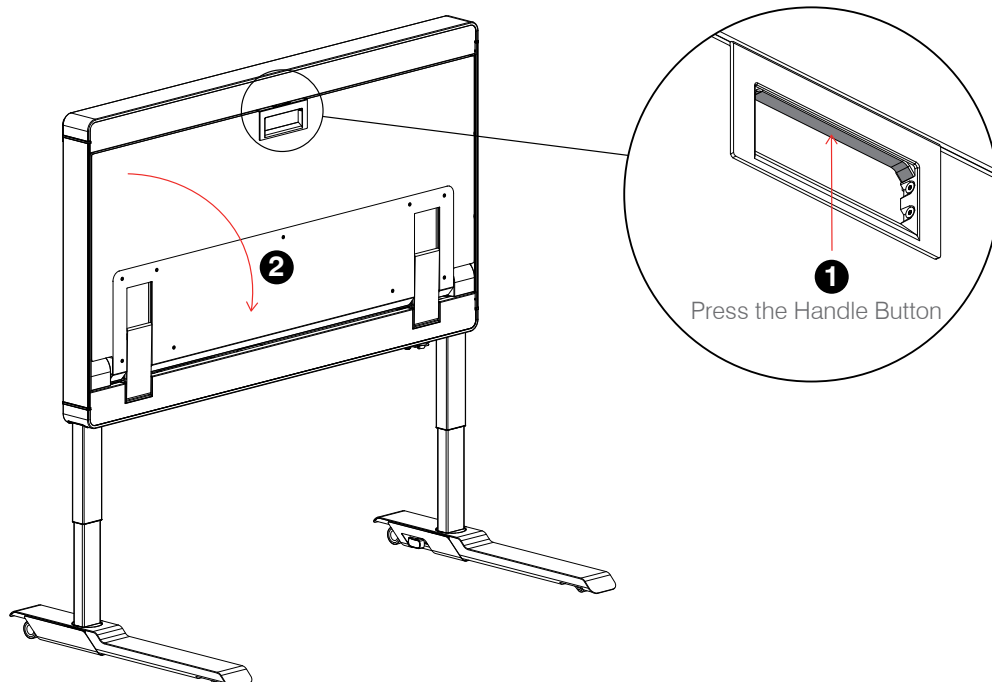

WORKSURFACE REPLACEMENT

Step 3

Press down the Worksurface until a “click” can be felt when the Worksurface is rotated to a horizontal position.

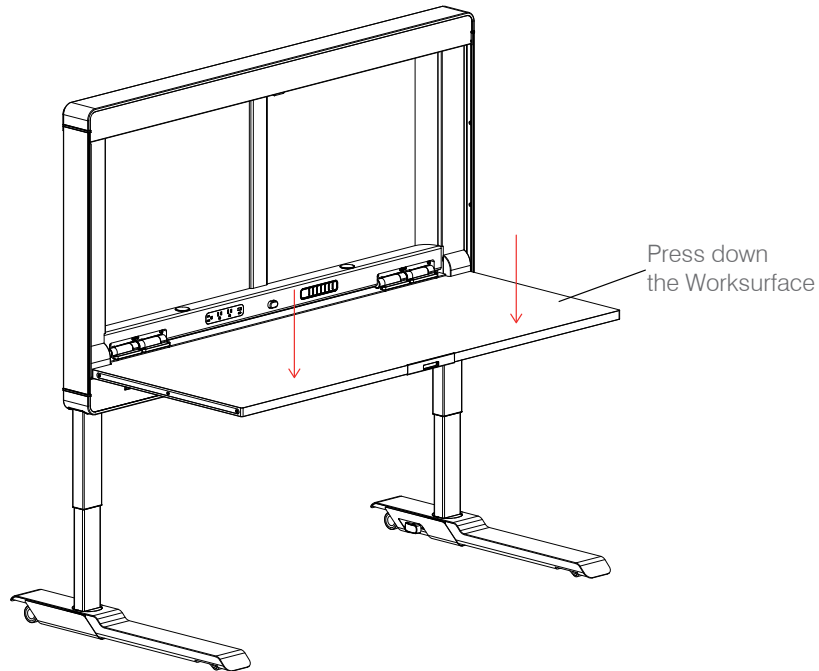

Step 4

Pull out the Worksurface.

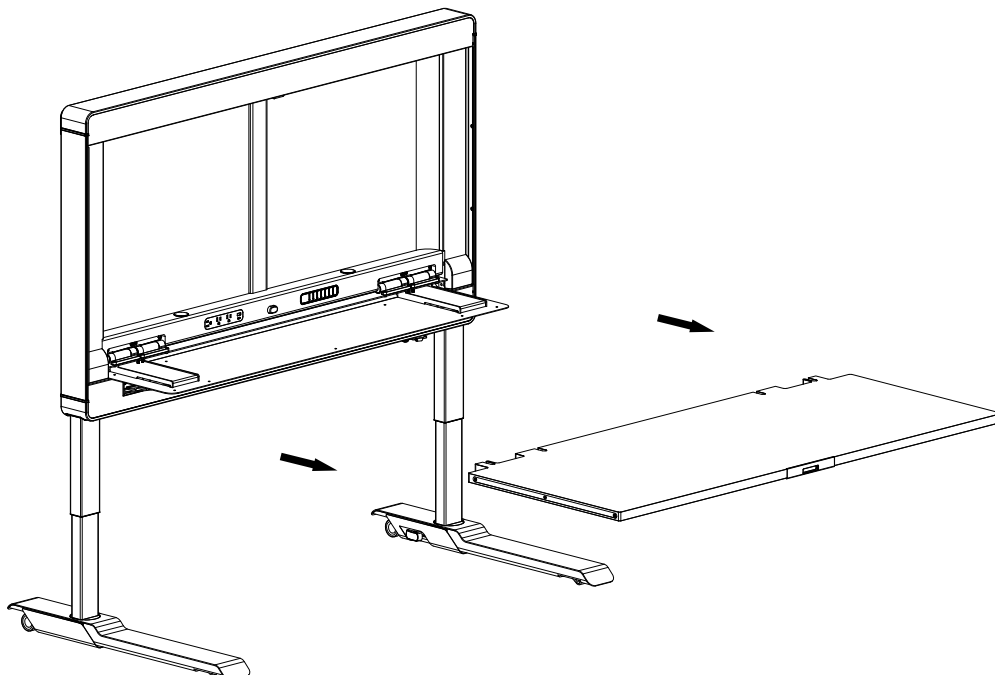

WORKSURFACE REPLACEMENT

Step 5

Replace the damaged Worksurface.

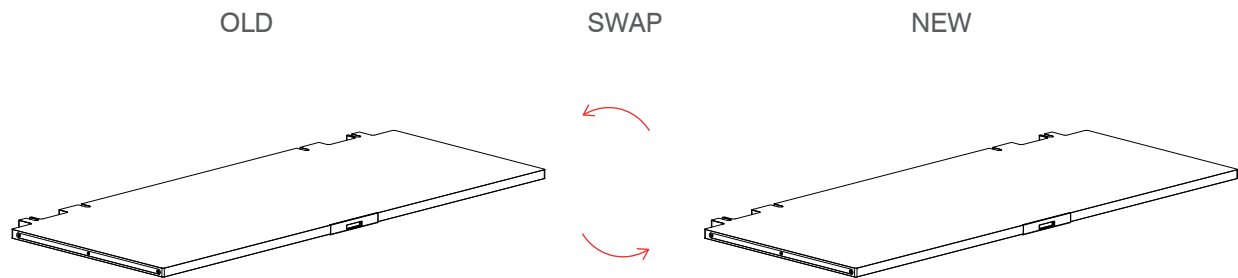

Step 6

Place the Worksurface on the cantilever plate, align the opening position and push it in to the end.

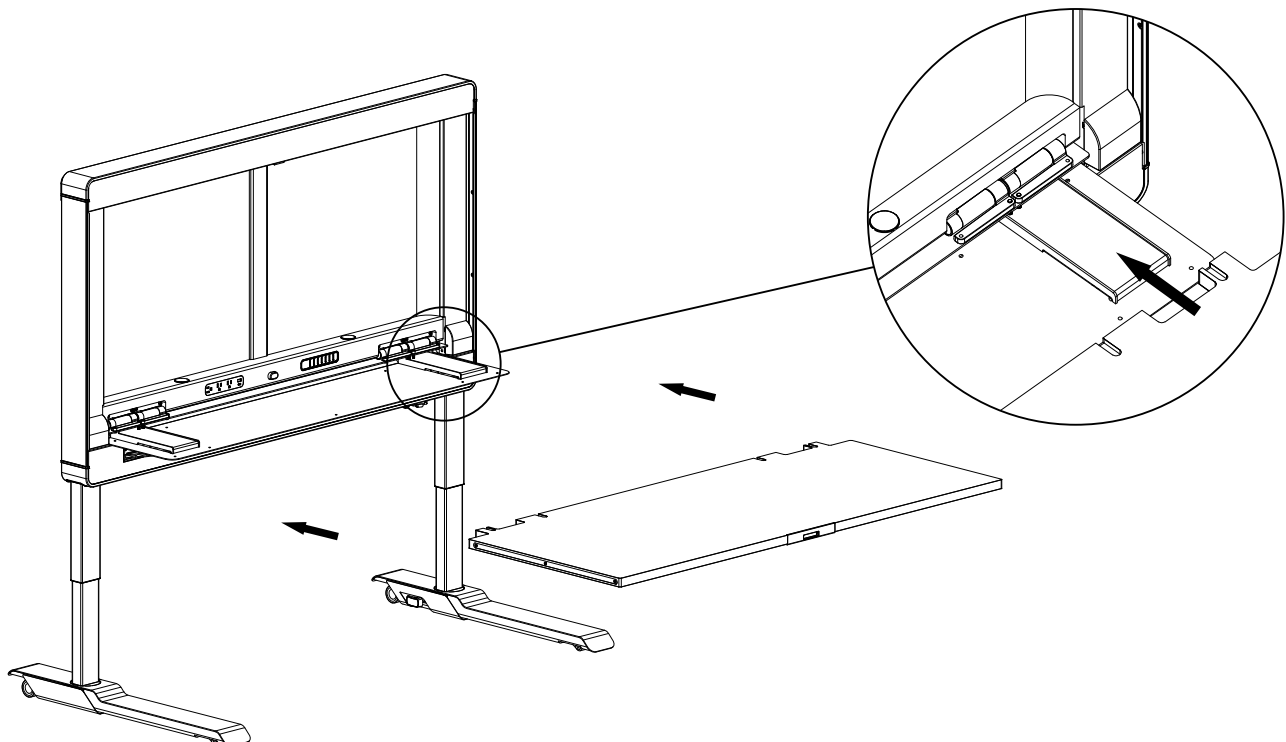

WORKSURFACE REPLACEMENT

Step 7

Note: To close the Worksurface, first press the Worksurface Lock Button, then lift the Worksurface to close it. A 'click' can be felt when the Worksurface is properly locked and secured.

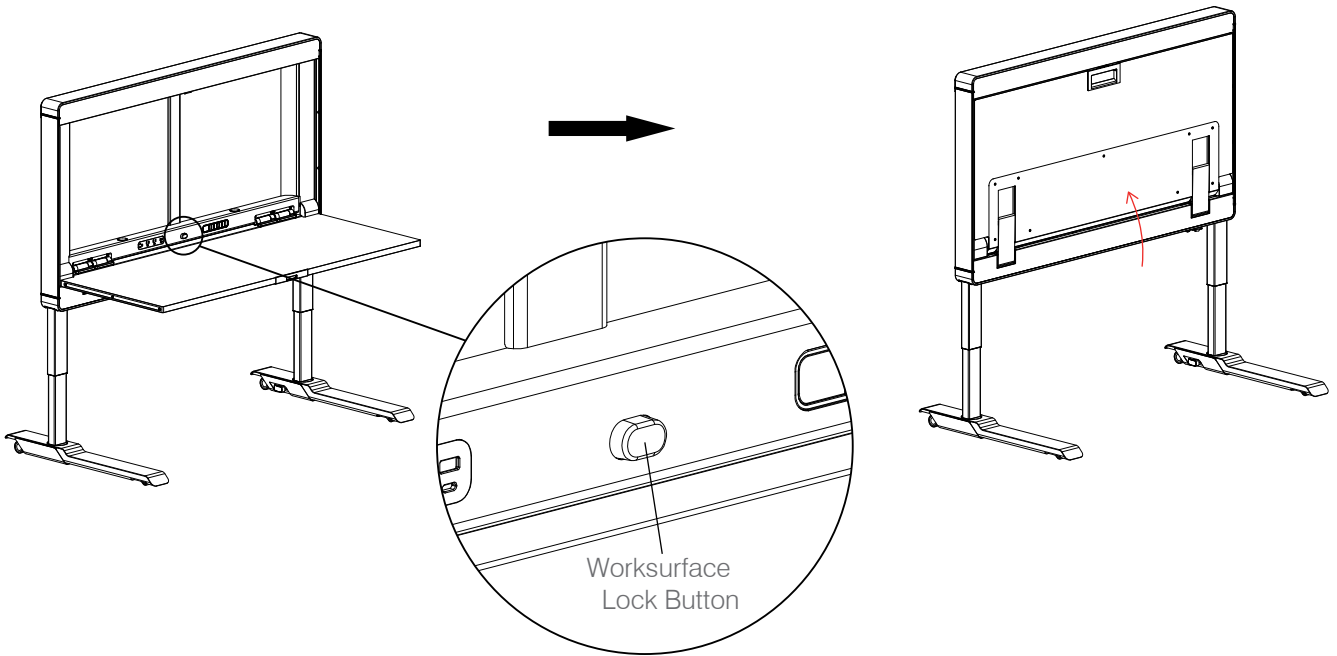

Step 8

Before securing the Worksurface to the Main Body with screws. Make sure there is no interference between the Worksurface & Main Body. Both side of the Worksurface & Main Body should have equal gaps and that the pre-pilot holes on the Worksurface are aligned with the holes on the Cantilever Plate.

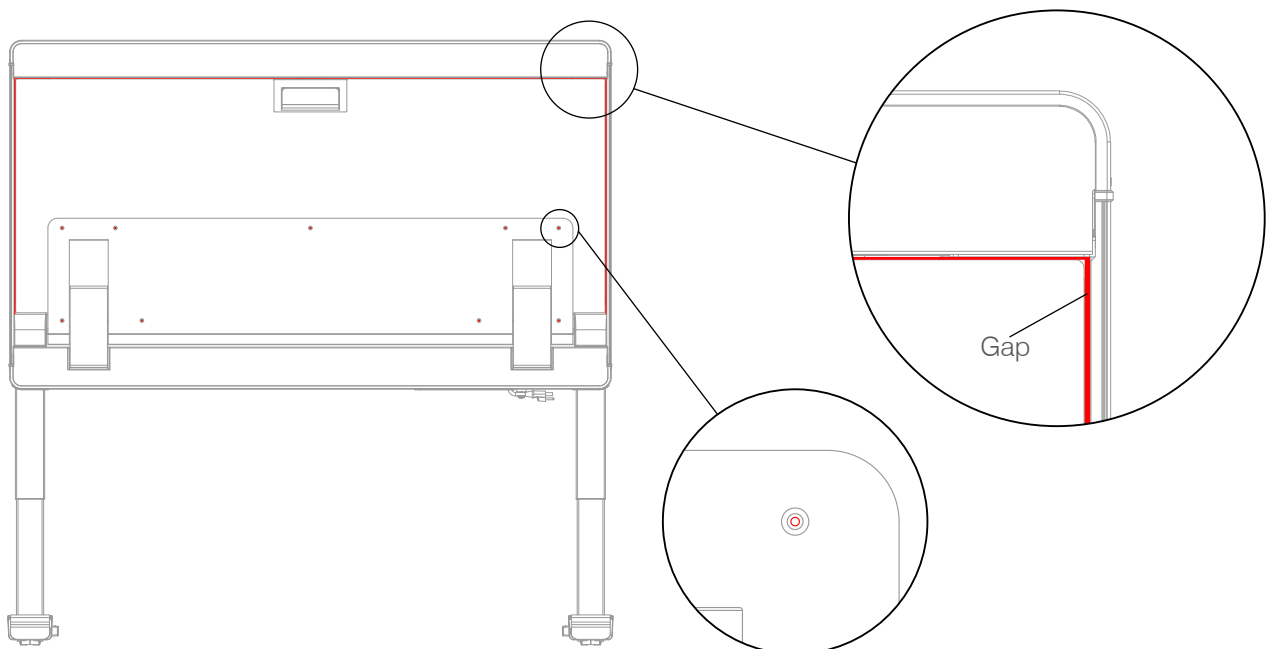

WORKSURFACE REPLACEMENT

Step 9

Use an electric drill to reinstall 9 screws(Torque : 1.4~1.8 N*m) to secure the Worksurface.

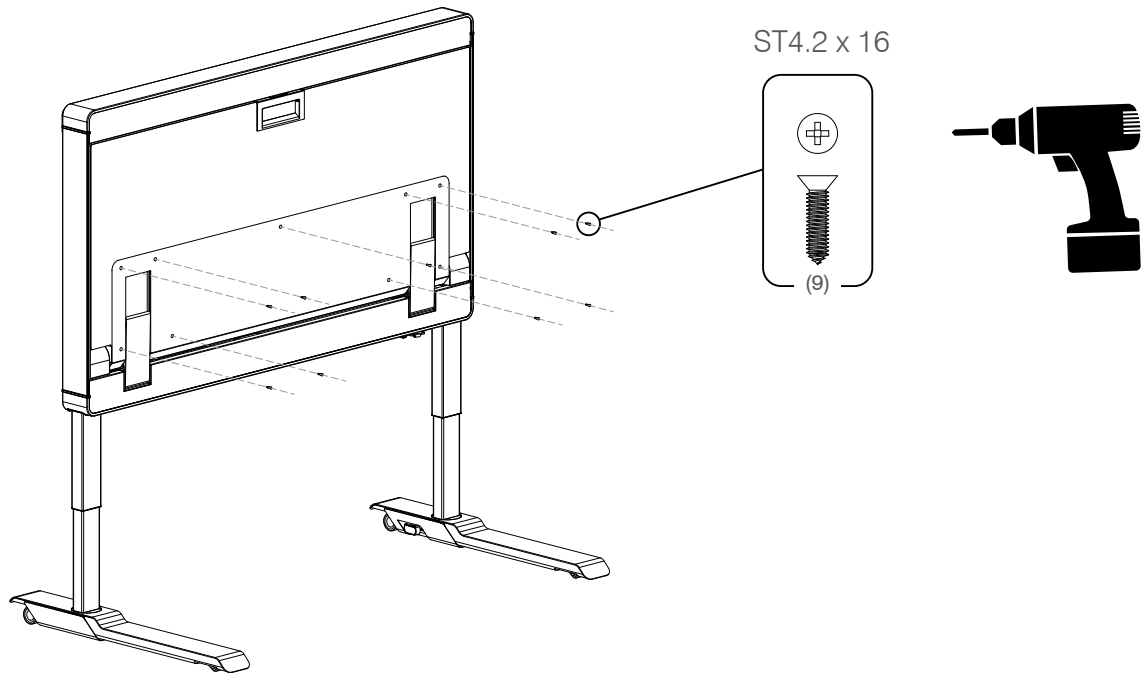

REAR PANEL SLOT REPLACEMENT



COMPONENTS

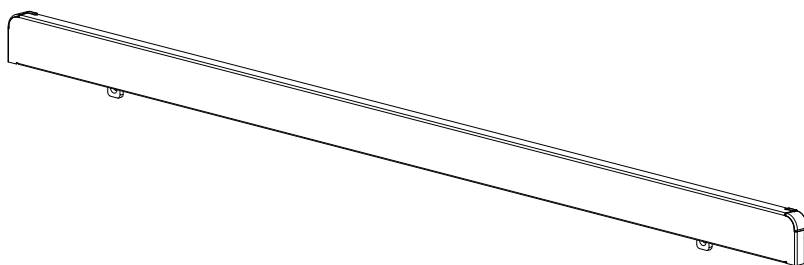

Rear Panel Slot

TOOL REQUIRED

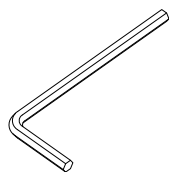

4mm Hex Key
x 1

REAR PANEL SLOT REPLACEMENT

Step 1

Whiteboard/Felt Tackboard can be unlocked by pressing the Push-Lock Buttons located on each side as indicated above.

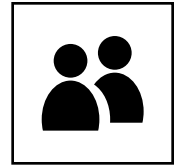

2 person

Notice : To avoid damage, 2 person is required while installing/removing the Whiteboard or Felt Tackboard.

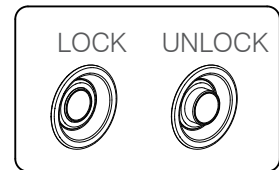
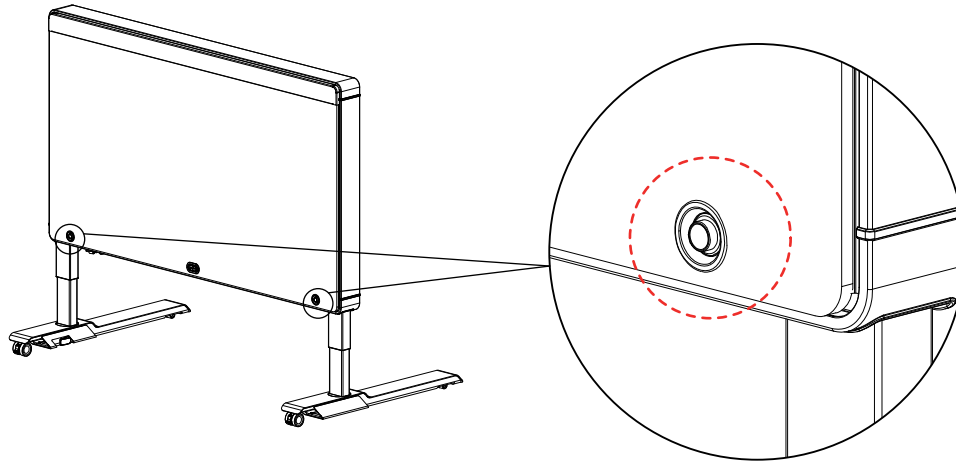

Step 2

Then pull the Whiteboard/Felt Tackboard outwards then downwards to remove it.

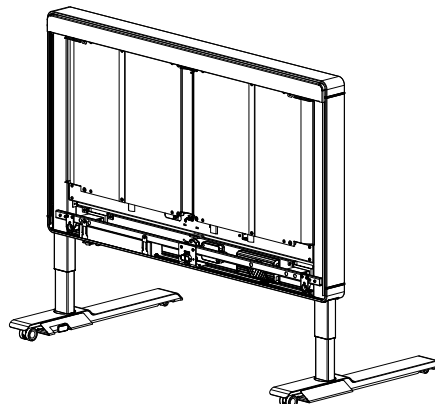
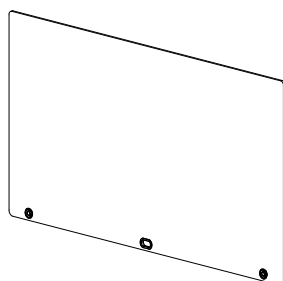
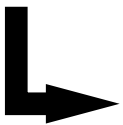
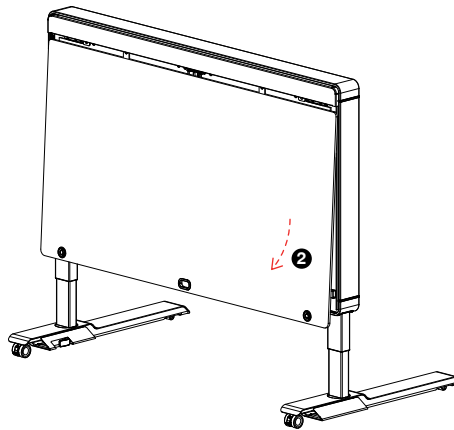
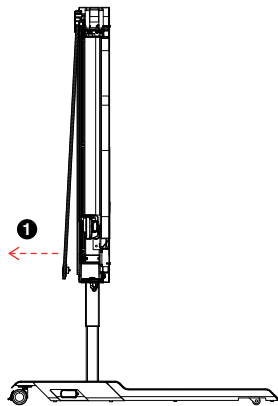

REAR PANEL SLOT REPLACEMENT

Step 3

Hold the Rear Panel Slot with your hand, Use a 4mm hex key to remove the two M6x14 screws.

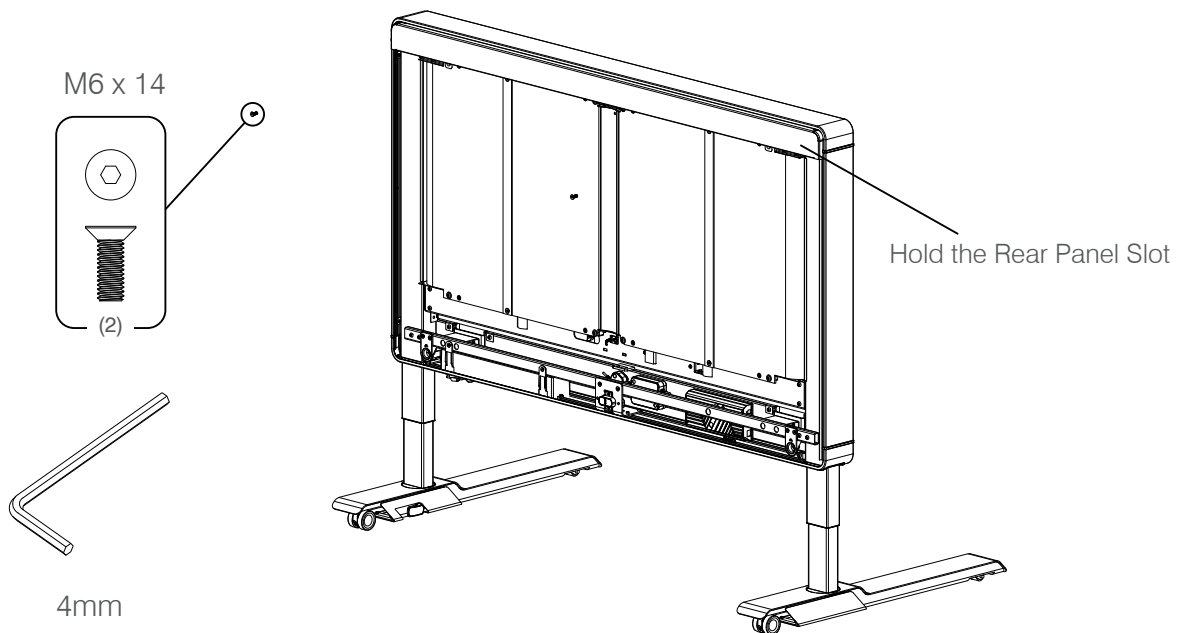
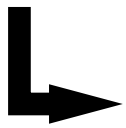
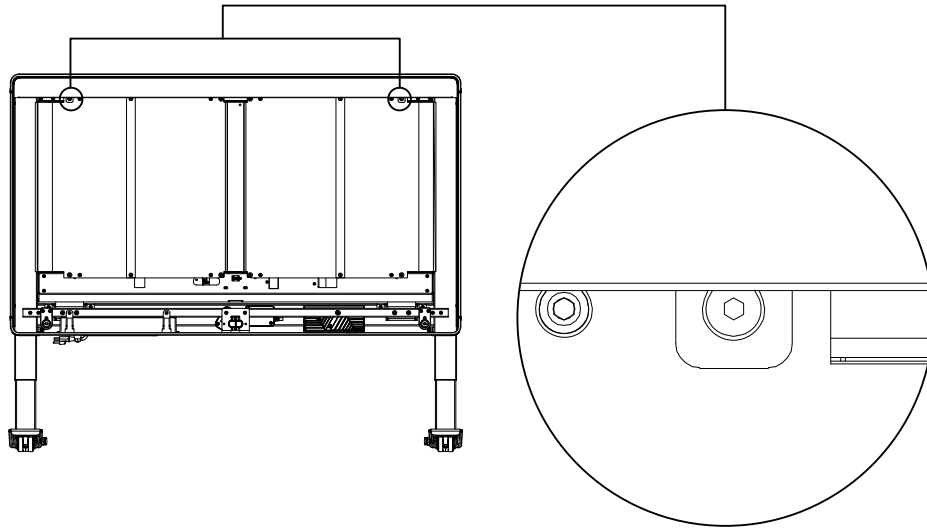

REAR PANEL SLOT REPLACEMENT

Step 4

Replace the damaged Rear Panel Slot.

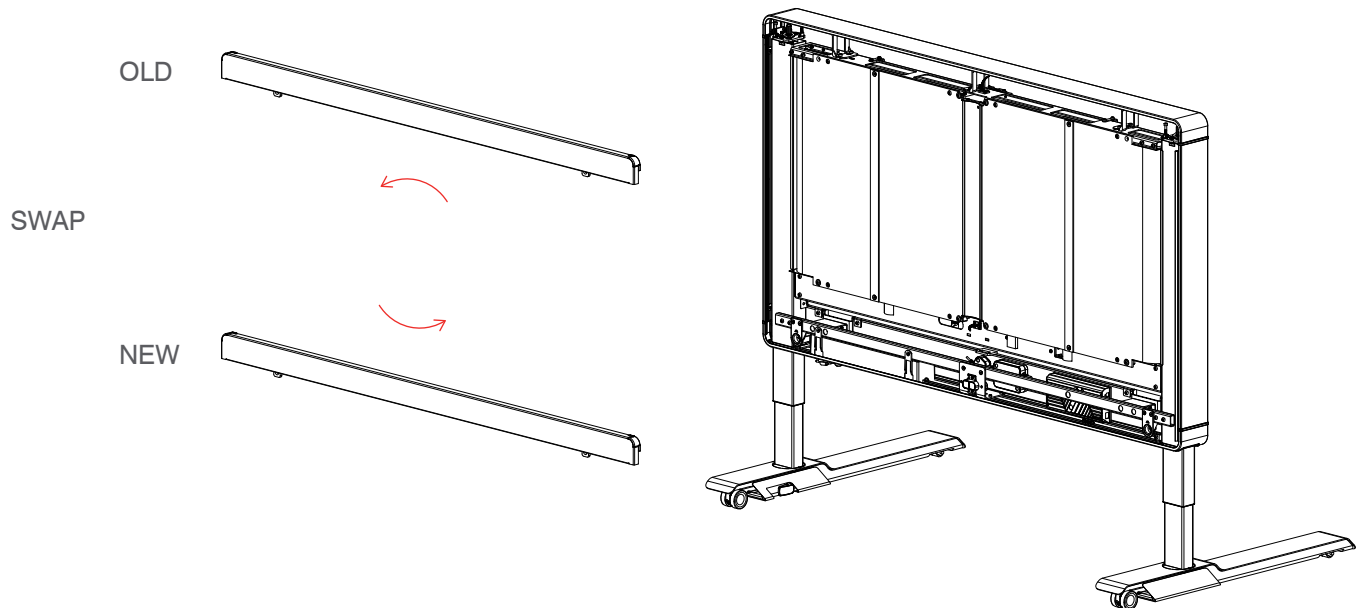

Step 5

Hold the Rear Panel Slot with your hand, Use a 4mm hex key to tightly the two M6x14 screws.

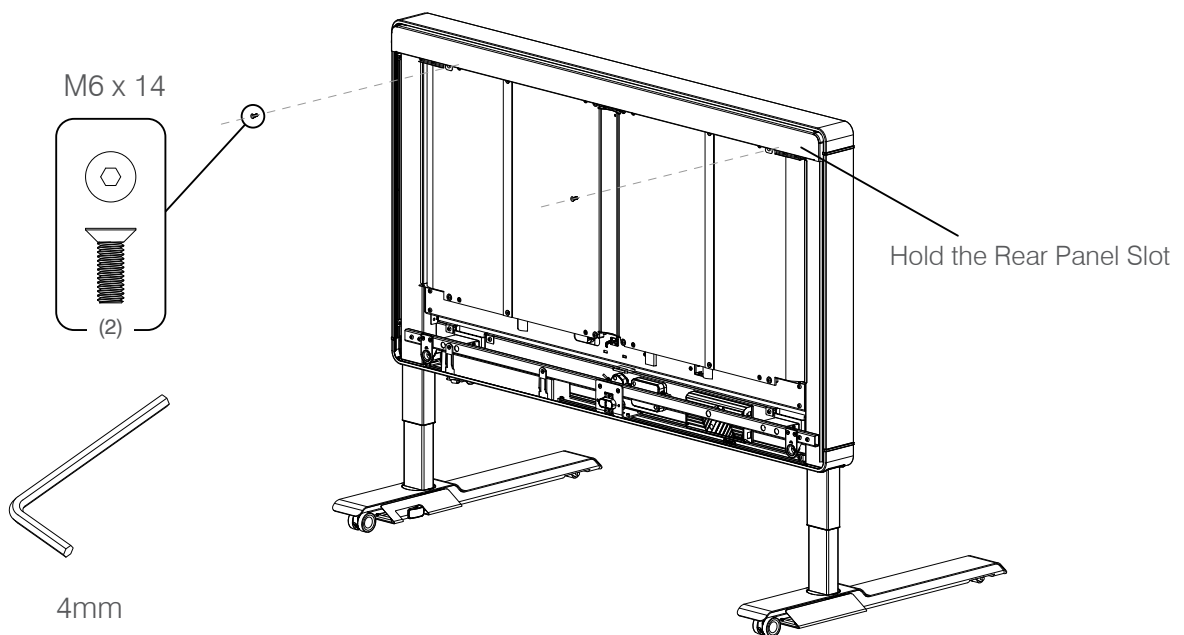

REAR PANEL SLOT REPLACEMENT

Step 6

Align the Whiteboard/Felt Tackboard into the Rear Panel Slot above at a slightly tilted angle.

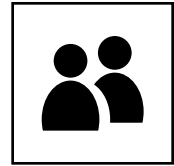

2 person

Notice : To avoid damage, 2 person is required while installing/removing the Whiteboard or Felt Tackboard.

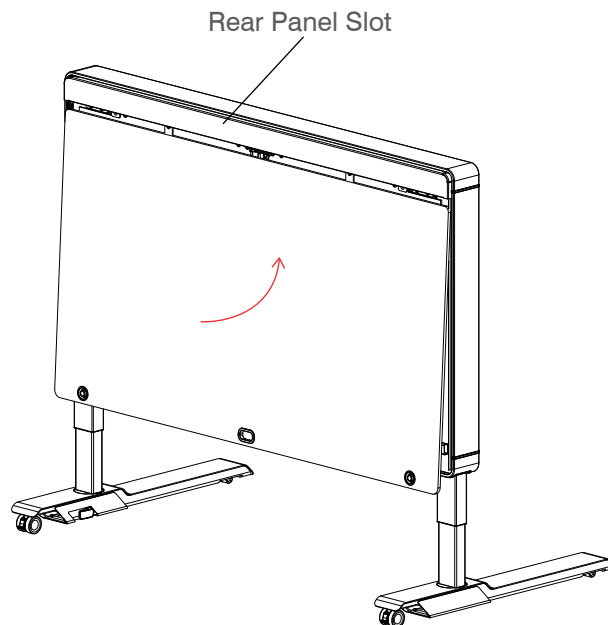

Step 7

Insert the Whiteboard/Felt Tackboard into the Rear Panel Slot at an angle with a straight trajectory.

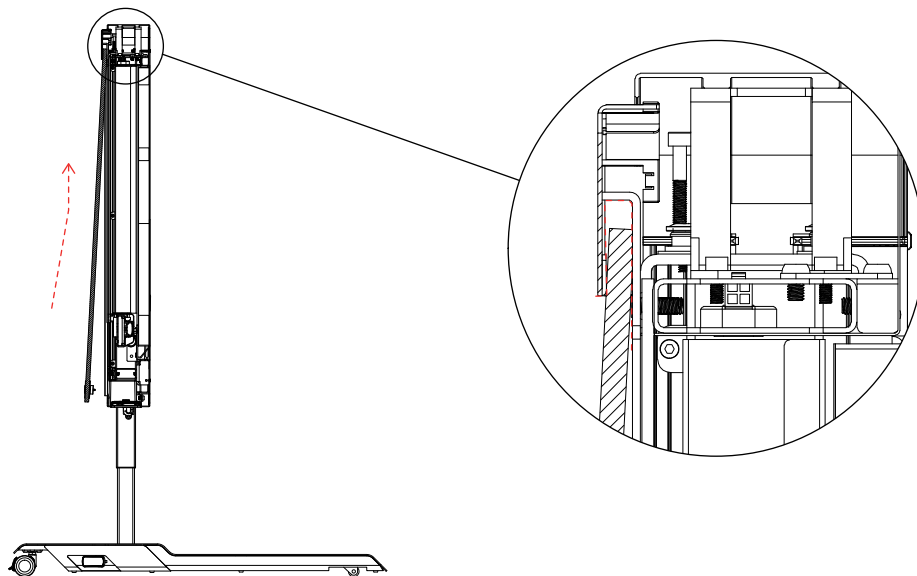

REAR PANEL SLOT REPLACEMENT

Step 8

1. Ensure that the Rear Handset is aligned to the Handset Bezel opening. Press the Handset Bezel against the frame to ensure that it is magnetically engaged.
2. Ensure that the Push-Lock is aligned with the Push-Lock Socket. Flatten the Whiteboard/Felt Tackboard against the frame then press the Push-Lock Button on both sides to lock it in place.

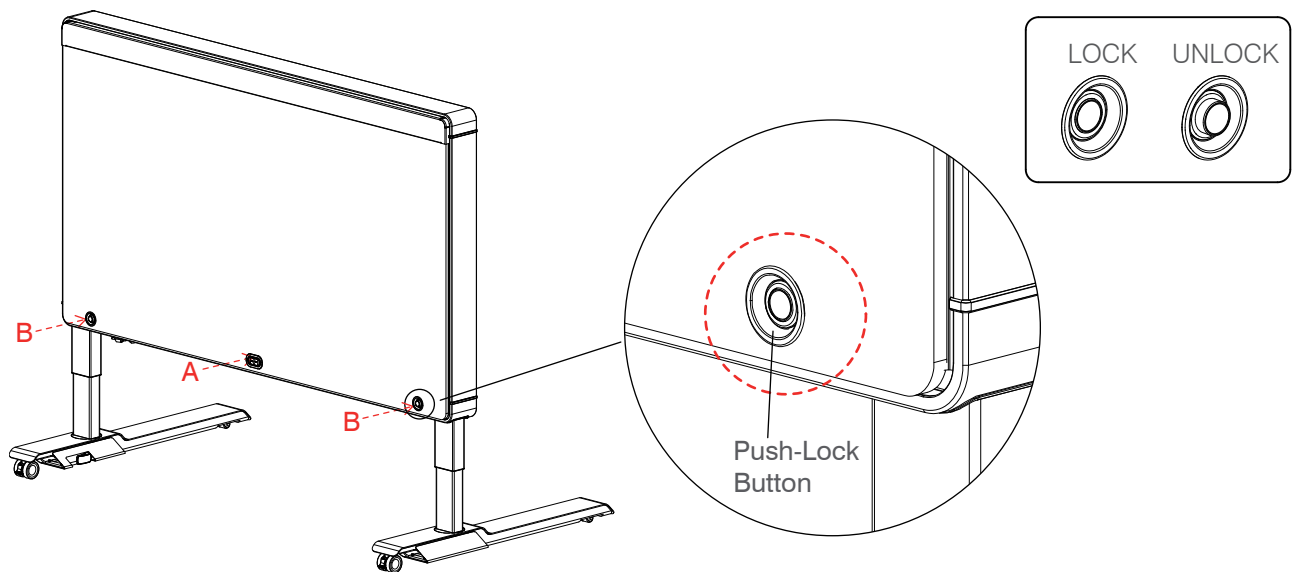

Whiteboard/Felt Tackboard can be locked or unlocked by pressing the Push-Lock Button.

REAR HANDSET REPLACEMENT

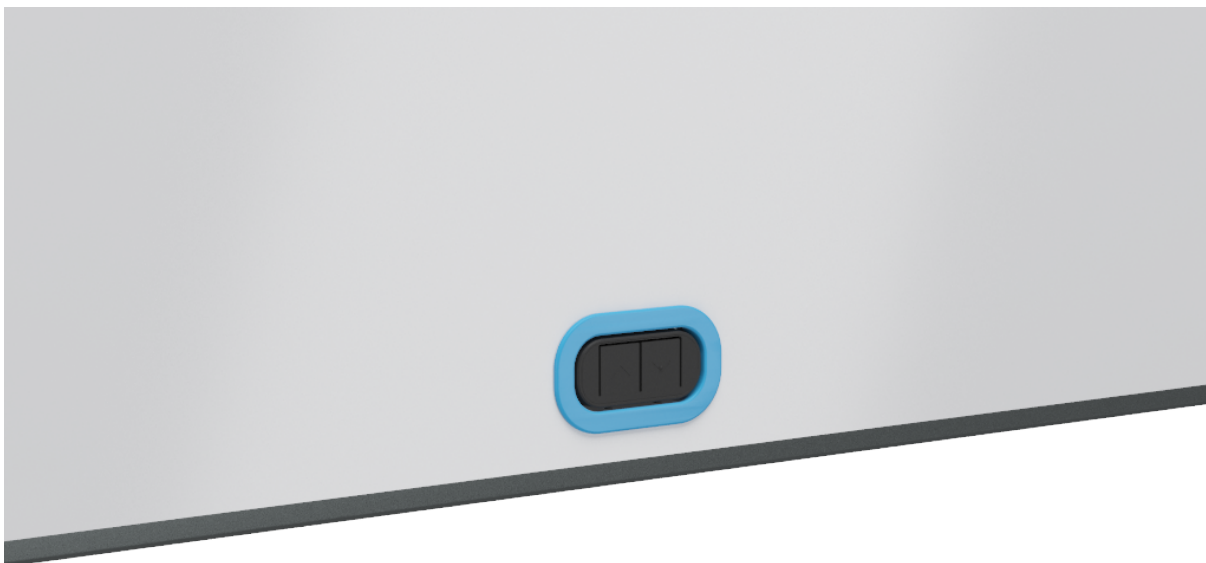

COMPONENTS

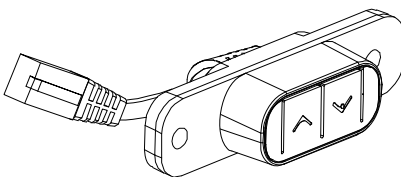

Rear Handset

TOOLS REQUIRED

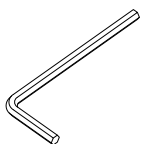

3mm Hex Key
x 1

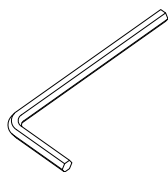

4mm Hex Key
x 1

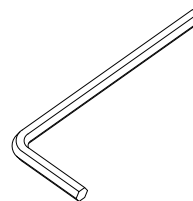

5mm Hex Key
x 1

REAR HANDSET REPLACEMENT

Step 1

Whiteboard/Felt Tackboard can be unlocked by pressing the Push-Lock Buttons located on each side as indicated above.

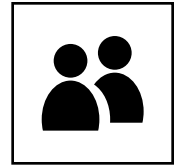

2 person

Notice : To avoid damage, 2 person is required while installing/removing the Whiteboard or Felt Tackboard.

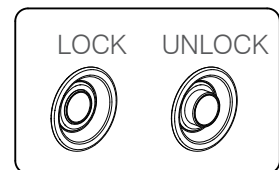
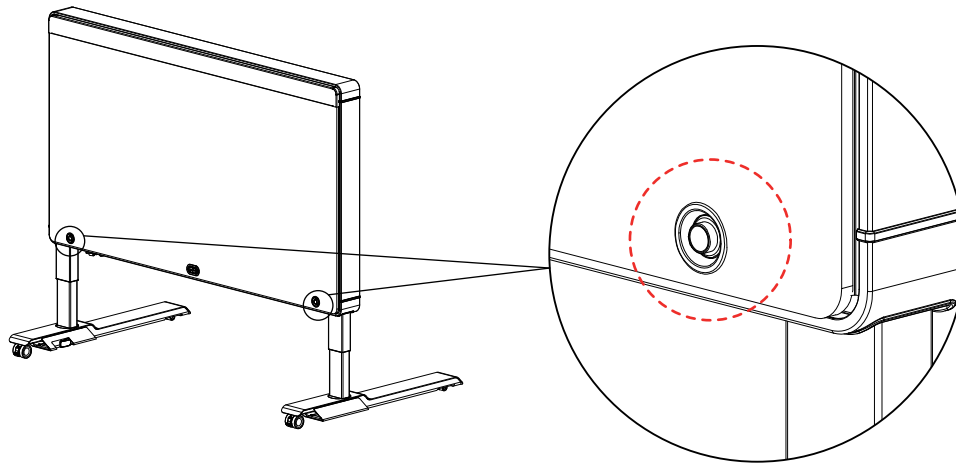

Step 2

Then pull the Whiteboard/Felt Tackboard outwards then downwards to remove it.

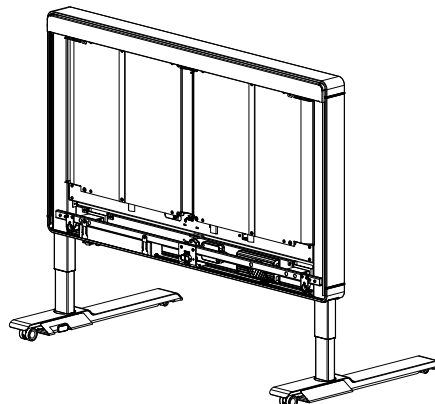
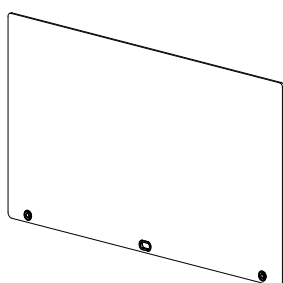
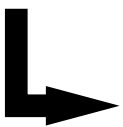
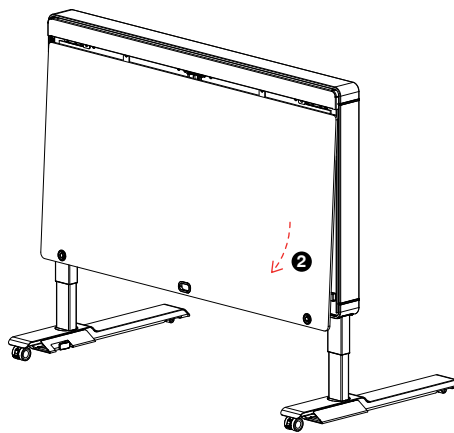
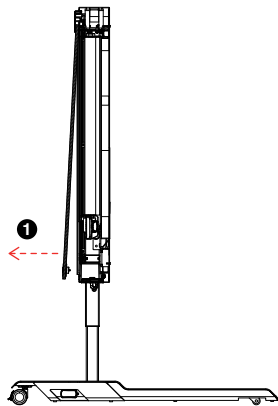

REAR HANDSET REPLACEMENT

Step 3

Remove the 12 screws from the Rear Beam as shown in the figure below.

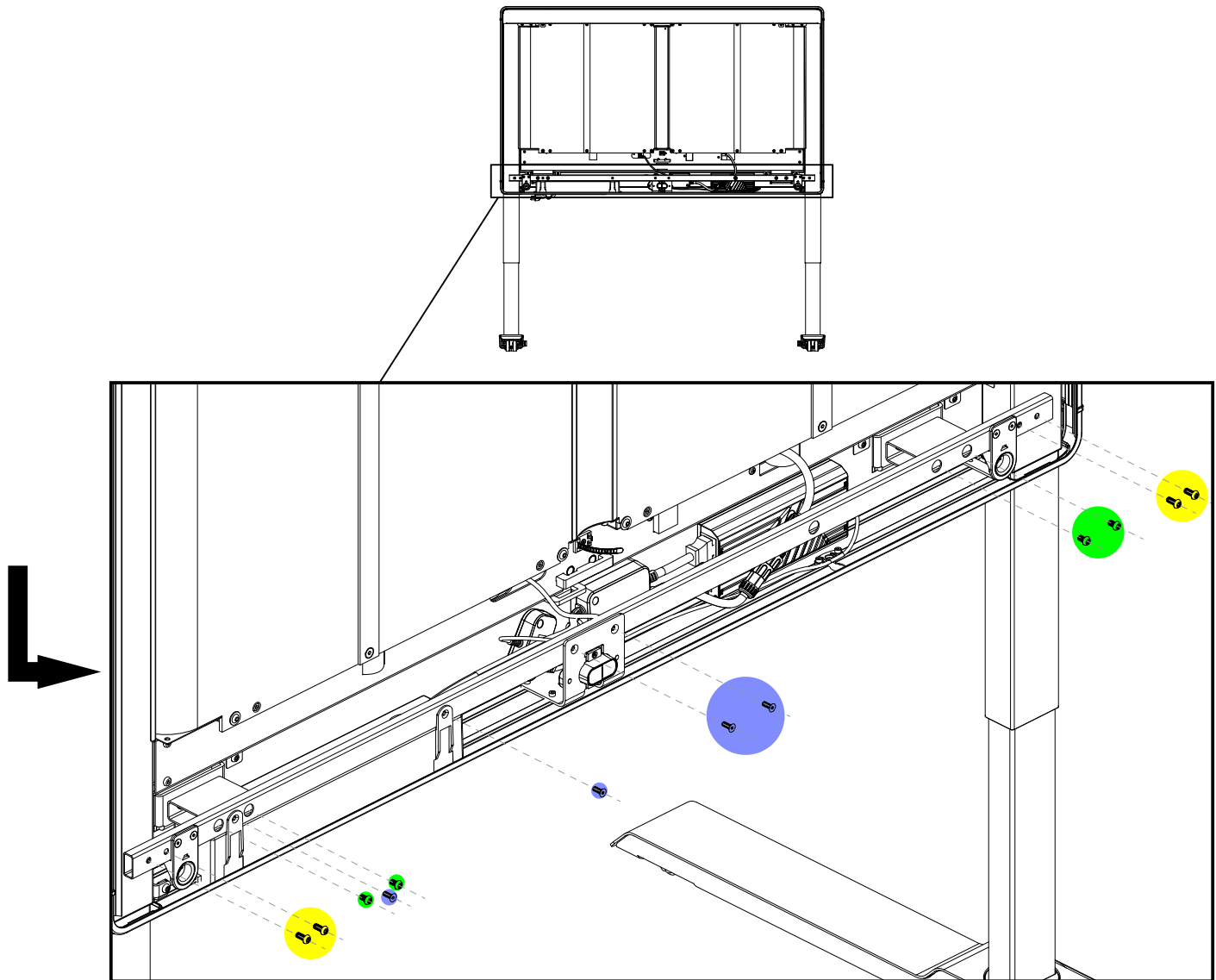

M6 x 14

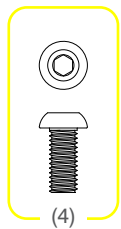

(4)

M5 x 14

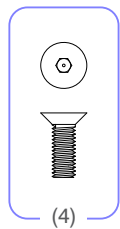

(4)

M6 x 10

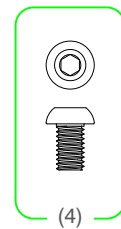

(4)

REAR HANDSET REPLACEMENT

Step 4

Remove the Rear Beam.

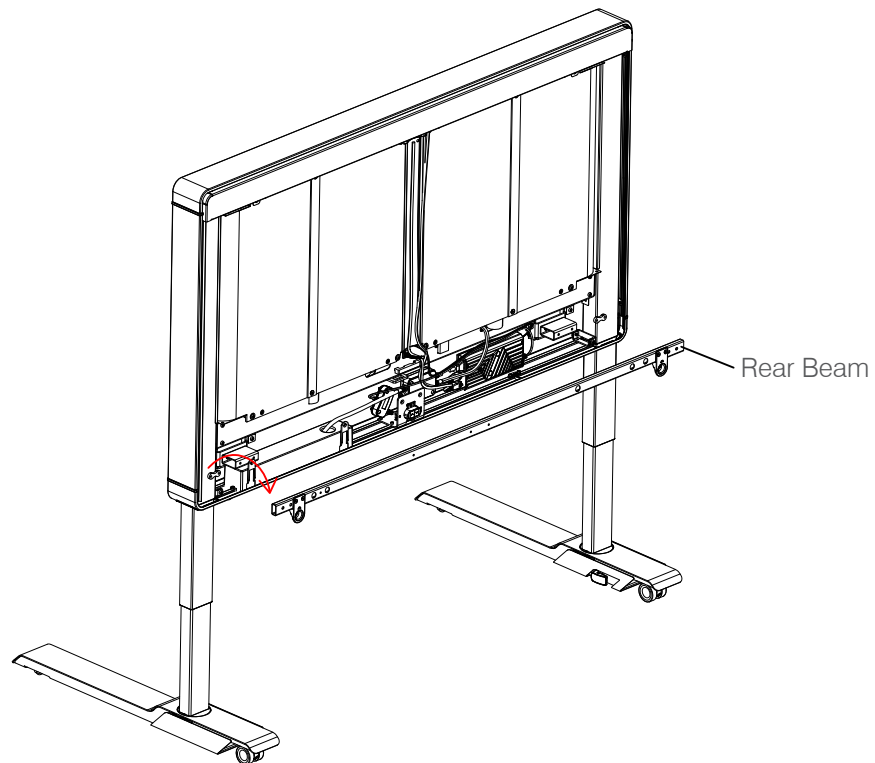

Step 5

Unplug the Rear Handset Connector.

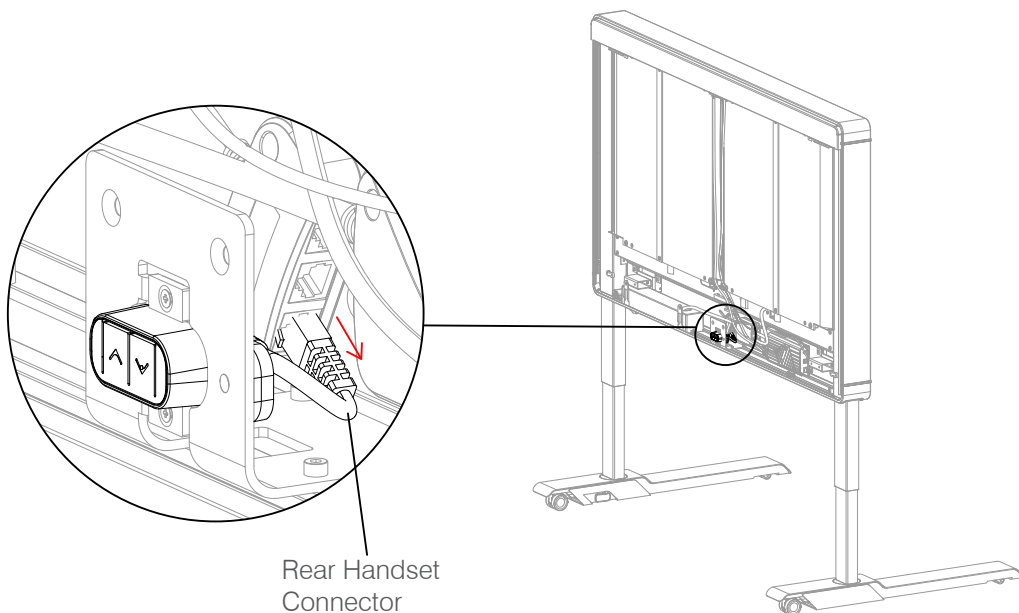

REAR HANDSET REPLACEMENT

Step 6

Use a 4mm hex key to remove the two M6x10 screws.

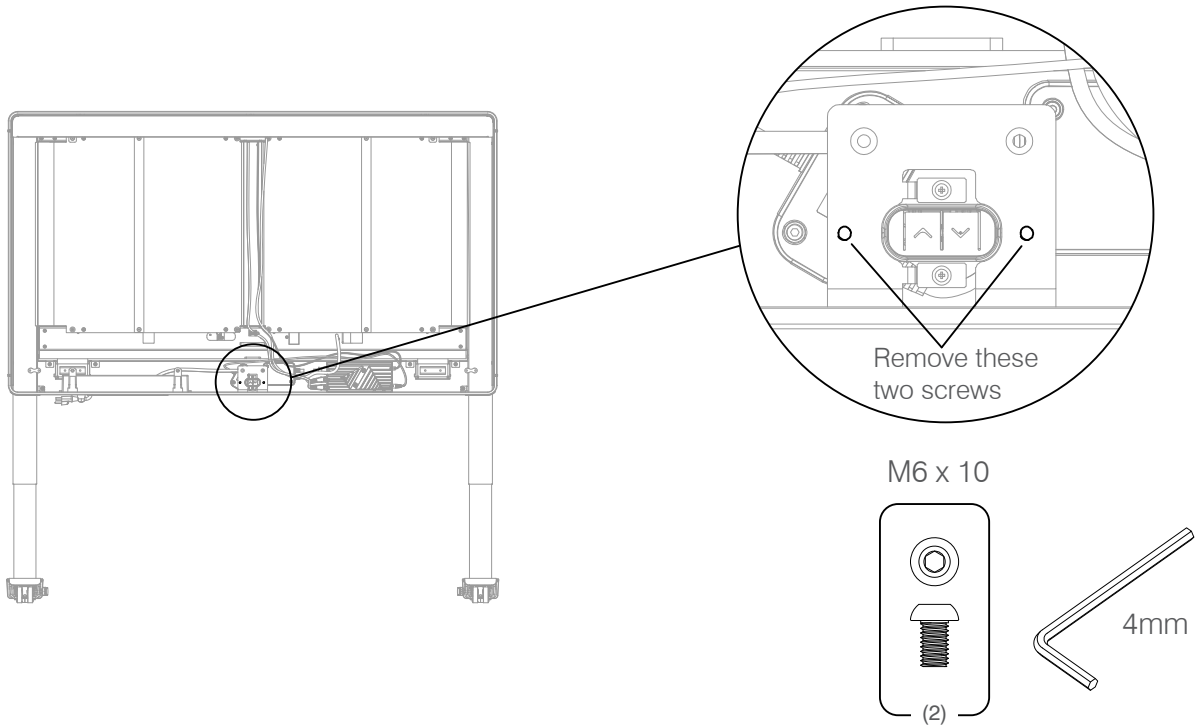

Step 7

Replace the damaged Rear Handset.

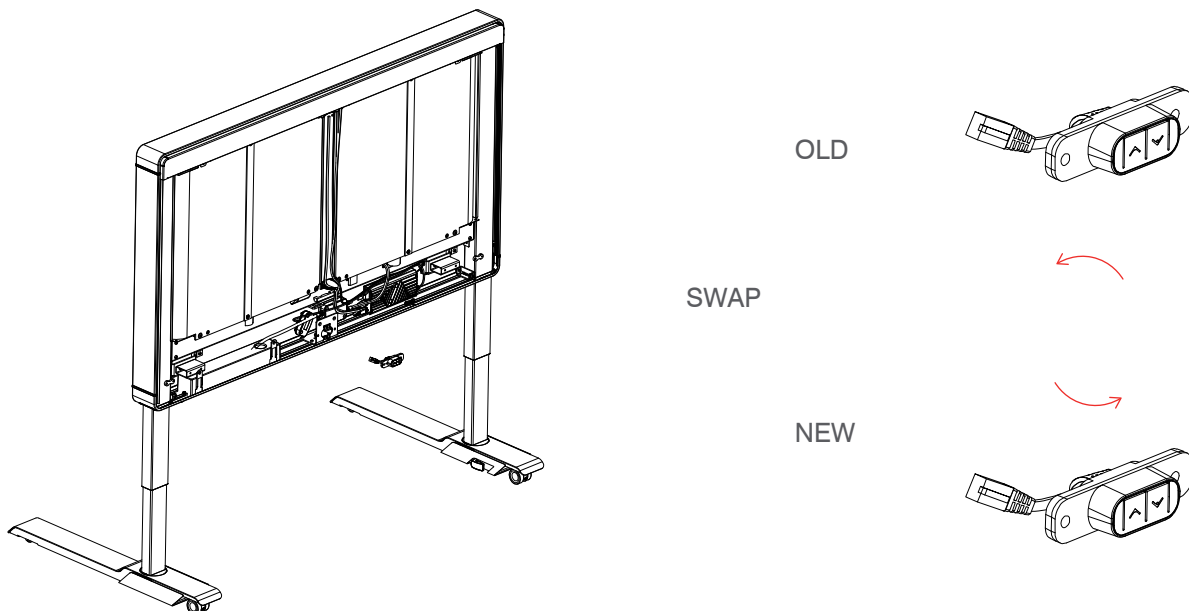

REAR HANDSET REPLACEMENT

Step 8

Reinstall the new handset on the handset bracket and reconnect the wires.

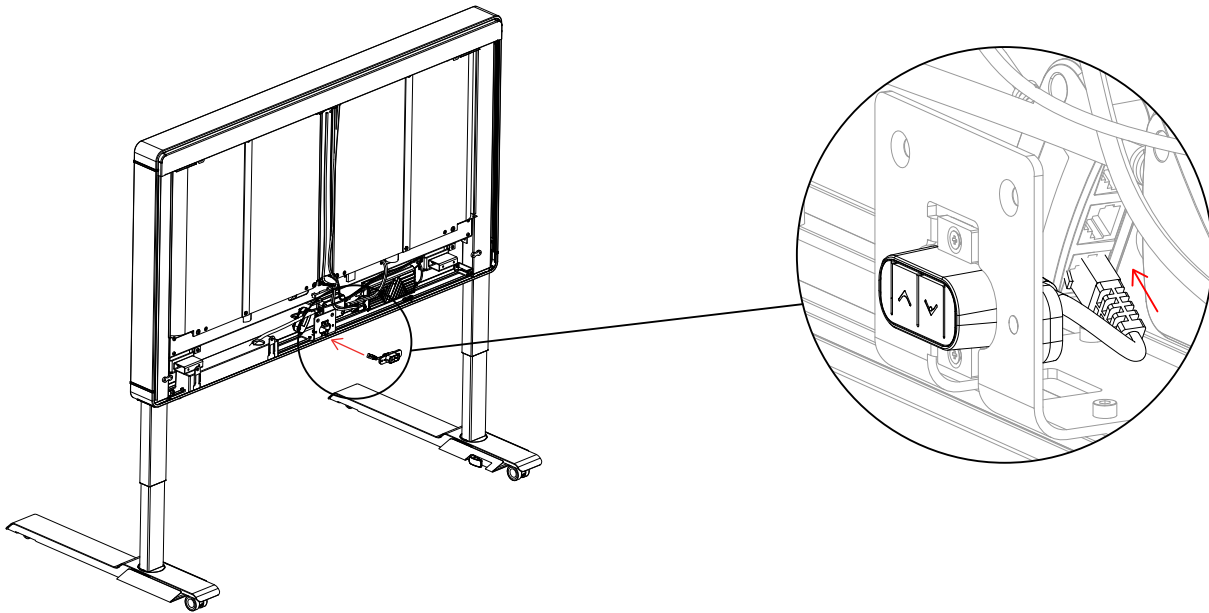

Step 9

Use a 4mm hex key to tightly the two M6x10 screws.

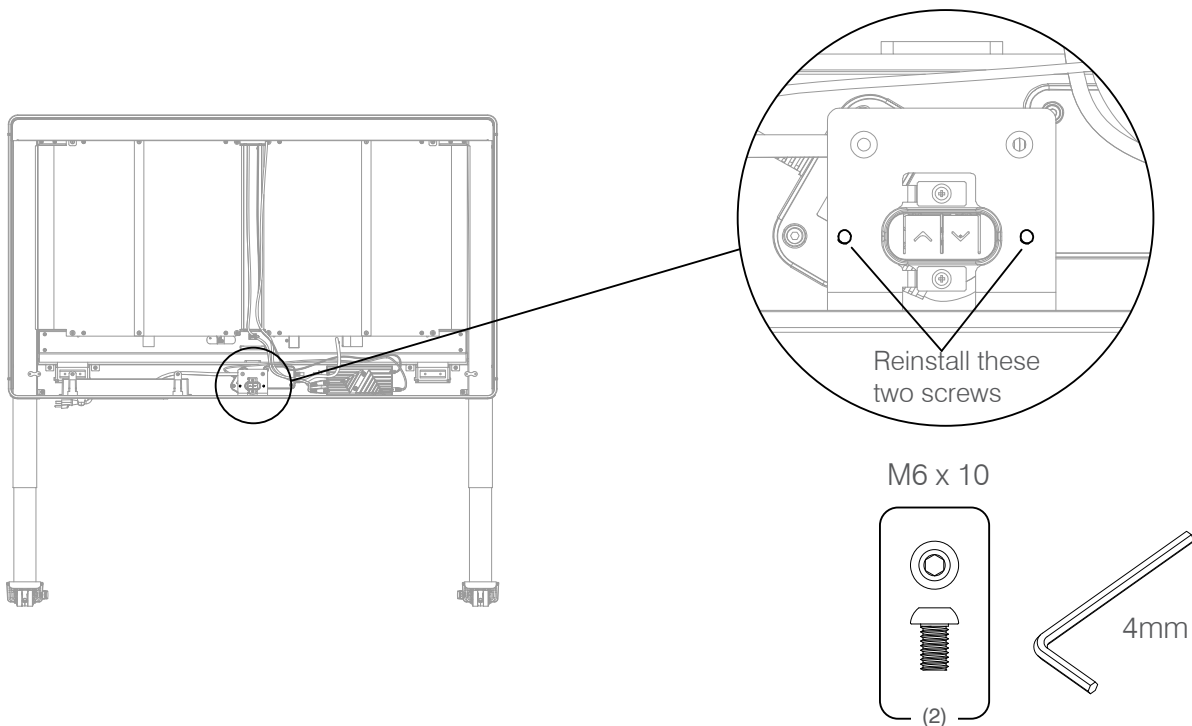

REAR HANDSET REPLACEMENT

Step 10

Connect the power supply and check if the Amobi Desk can operate normally. When everything is ok, reinstall the Rear Beam.

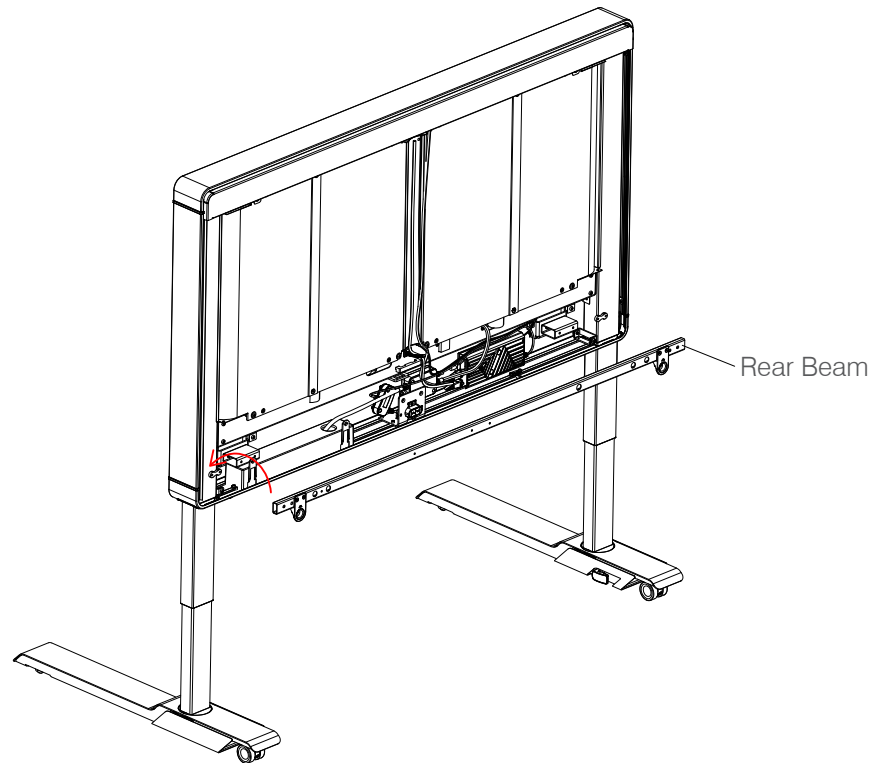

REAR HANDSET REPLACEMENT

Step 11

Use a 4mm hex key to tightly the four M6x14 screws and four M6x10 screws.
Use a 3mm hex key to tightly the four M5x14 screws.

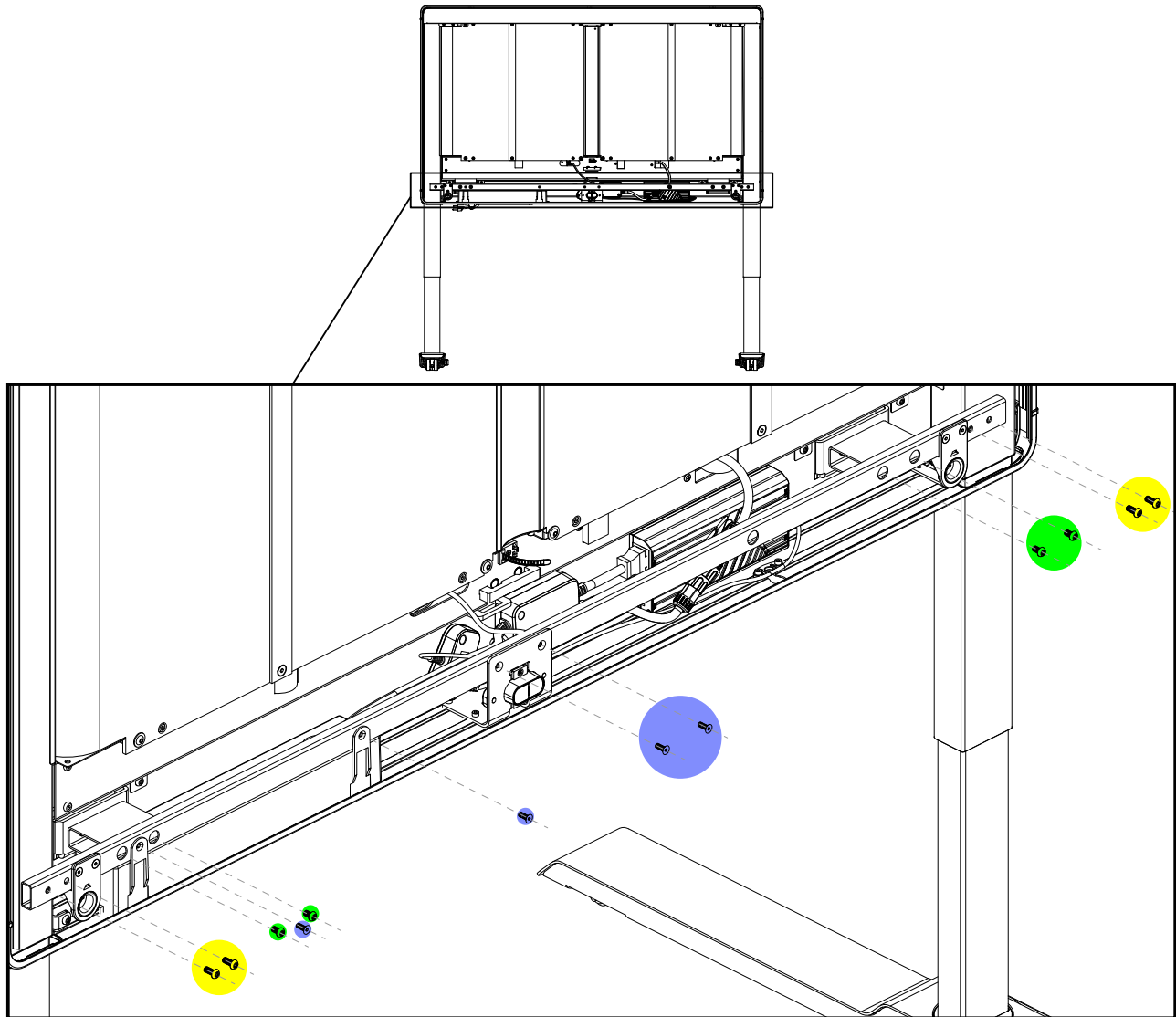

M6 x 14

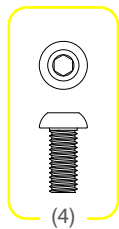

(4)

M5 x 14

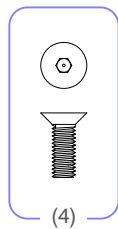

(4)

M6 x 10

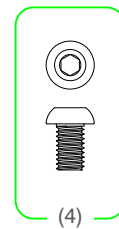

(4)

REAR HANDSET REPLACEMENT

Step 12

Align the Whiteboard/Felt Tackboard into the Rear Panel Slot above at a slightly tilted angle.

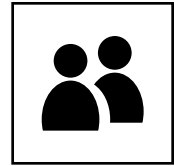

2 person

Notice : To avoid damage, 2 person is required while installing/removing the Whiteboard or Felt Tackboard.

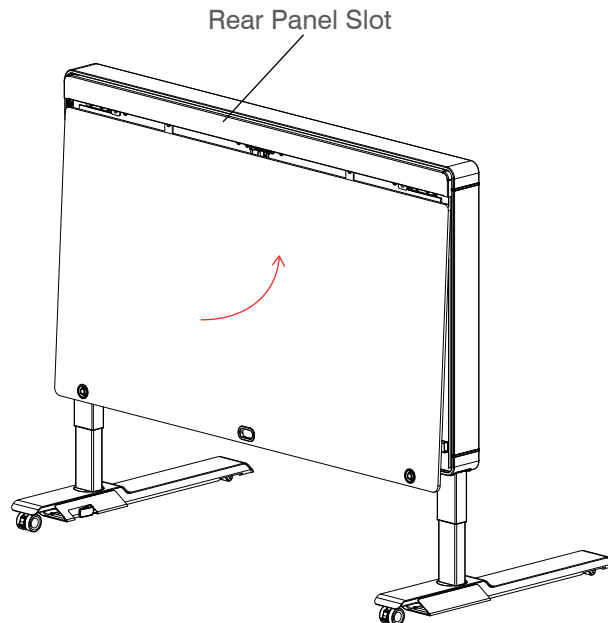

Step 13

Insert the Whiteboard/Felt Tackboard into the Rear Panel Slot at an angle with a straight trajectory.

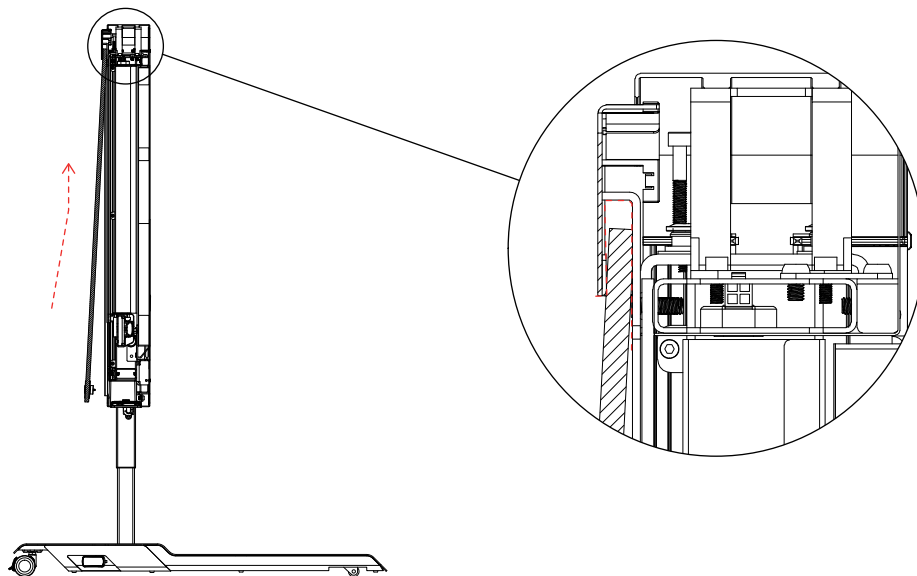

REAR HANDSET REPLACEMENT

Step 14

1. Ensure that the Rear Handset is aligned to the Handset Bezel opening. Press the Handset Bezel against the frame to ensure that it is magnetically engaged.
2. Ensure that the Push-Lock is aligned with the Push-Lock Socket. Flatten the Whiteboard/Felt Tackboard against the frame then press the Push-Lock Button on both sides to lock it in place.

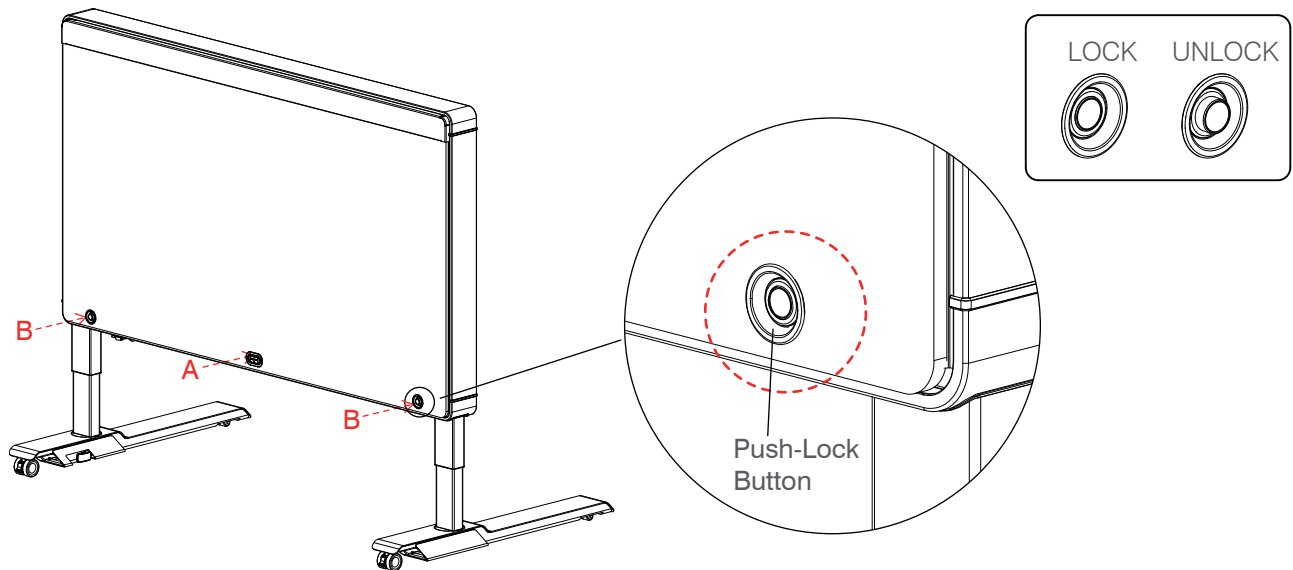

Whiteboard/Felt Tackboard can be locked or unlocked by pressing the Push-Lock Button.

FRONT & REAR CASTORS REPLACEMENT

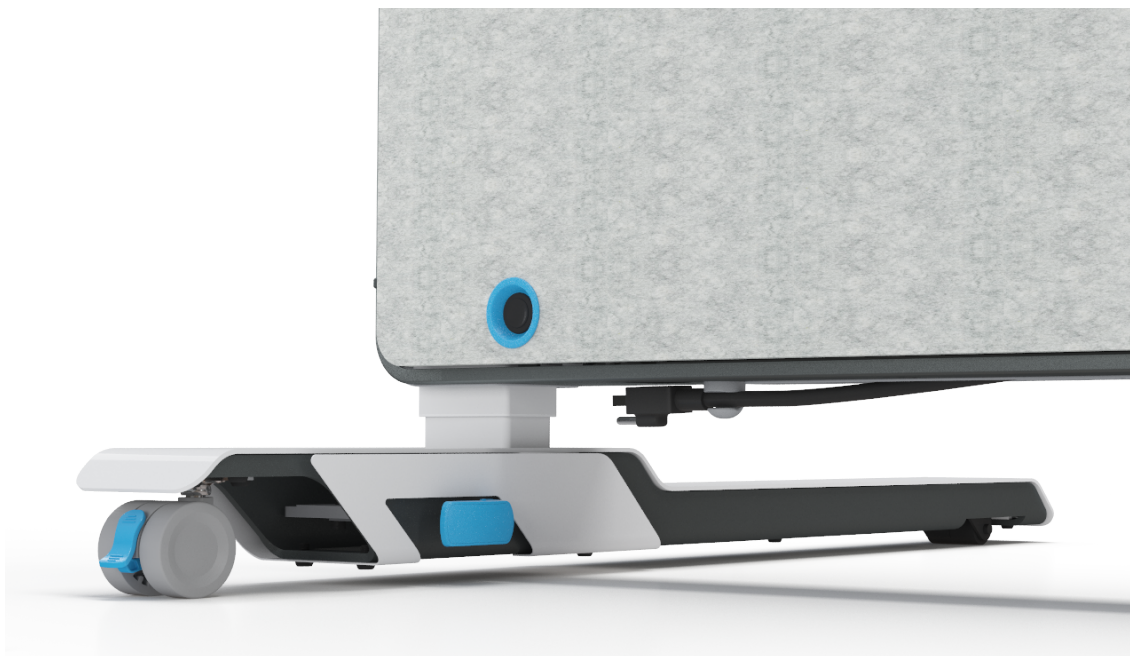

COMPONENTS

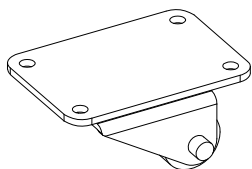

Front Caster

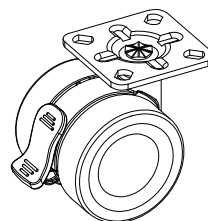

Rear Caster

TOOL REQUIRED

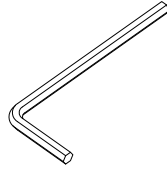

4mm Hex Key
x 1

FRONT & REAR CASTORS REPLACEMENT

Step 1

Whiteboard/Felt Tackboard can be unlocked by pressing the Push-Lock Buttons located on each side as indicated above.

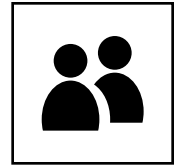

2 person

Notice : To avoid damage, 2 person is required while installing/removing the Whiteboard or Felt Tackboard.

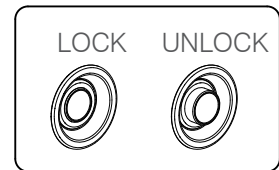
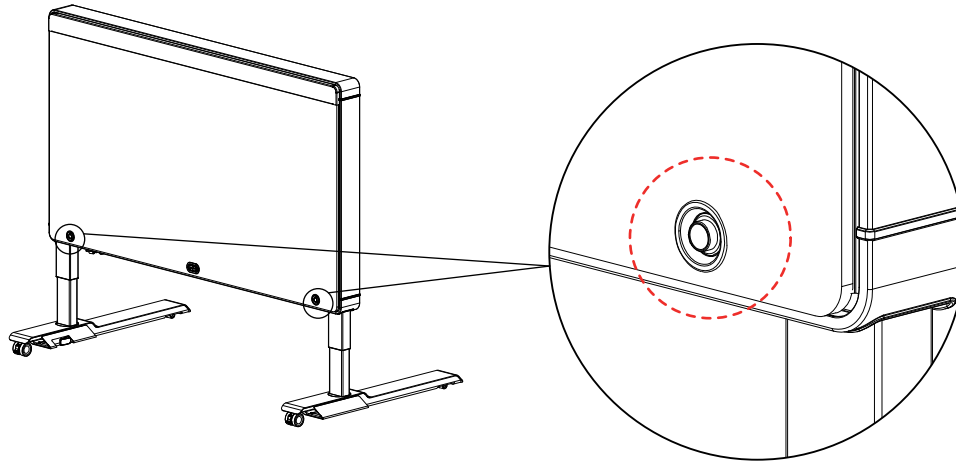

Step 2

Then pull the Whiteboard/Felt Tackboard outwards then downwards to remove it.

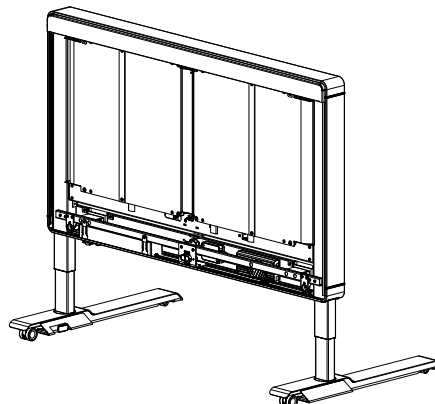
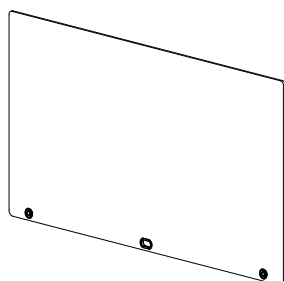
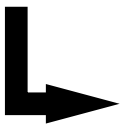
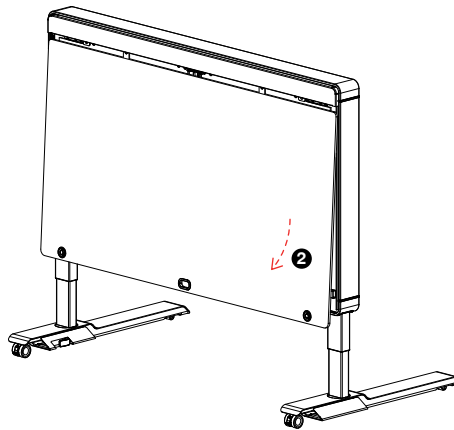
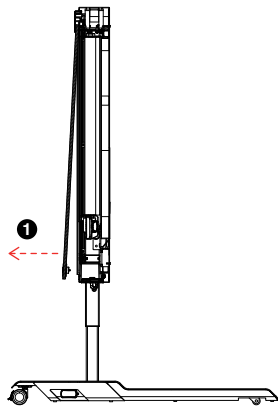

FRONT & REAR CASTORS REPLACEMENT

Step 3

Lower the Amobi Desk to its lowest position and unplug the power cable from the power supply.

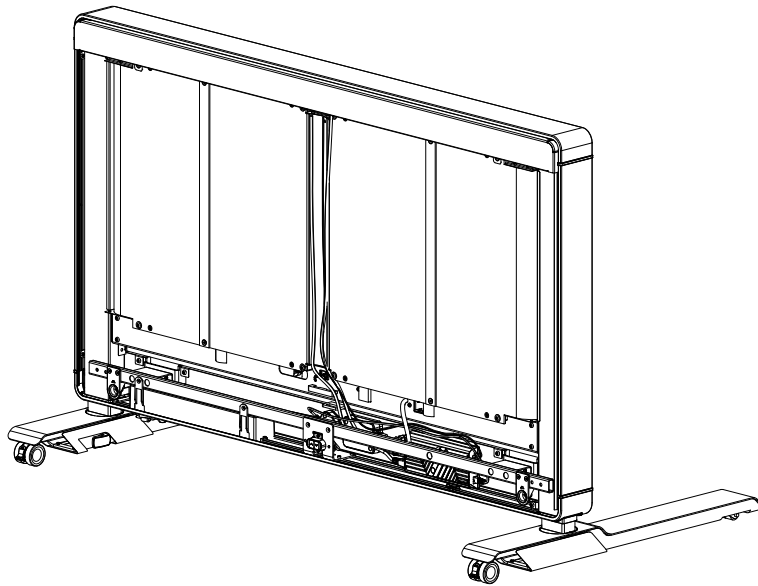

Step 4

Prepare a bench with soft cushion, as shown in the picture below.

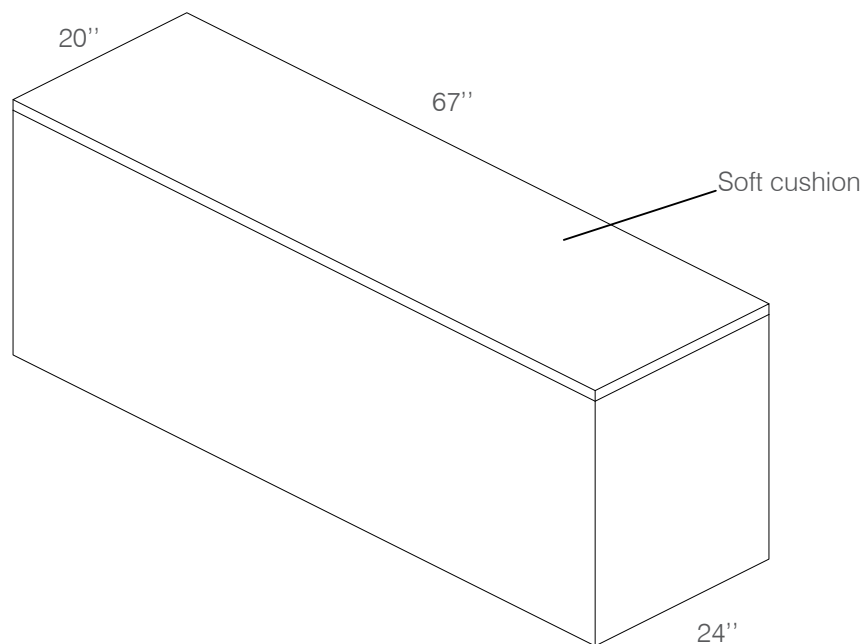

FRONT & REAR CASTORS REPLACEMENT

Step 5

Lay the Amobi Desk with its Worksurface facing downwards on the cushion, exposing the rear section of the Amobi Desk upwards.

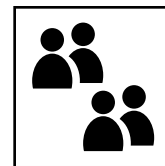

4 person

Notice: It will take 4 person to tilt the Amobi Desk into a horizontal position like the diagram below.

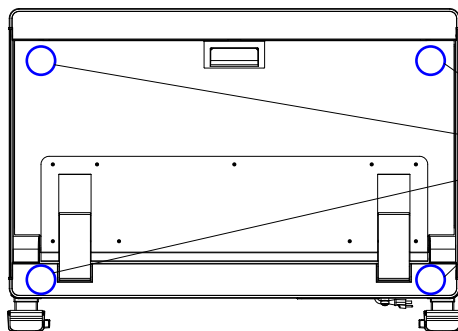

Four people should carry the table by holding these four points.

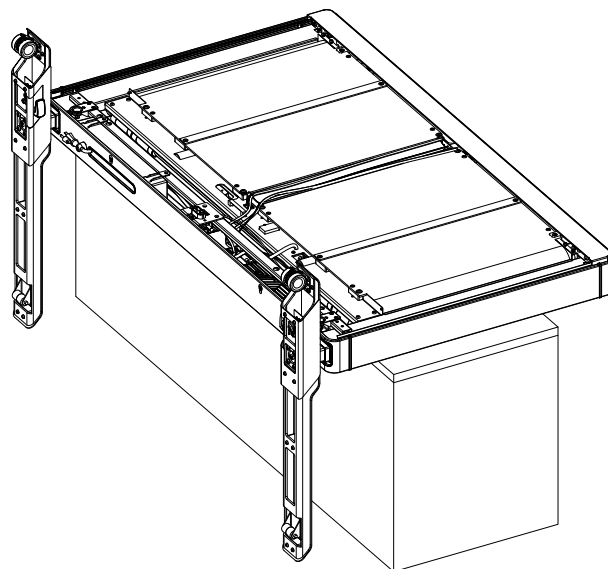
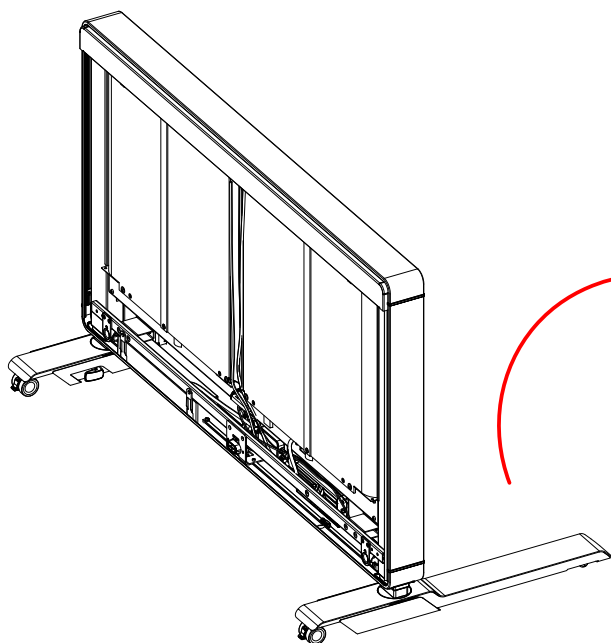

WARNING

Make sure the Amobi Desk is in a stabile position before beginning work.

FRONT & REAR CASTORS REPLACEMENT

Step 6

Use a 4mm hex key to remove the four M6x10 screws on the Rear Casters.

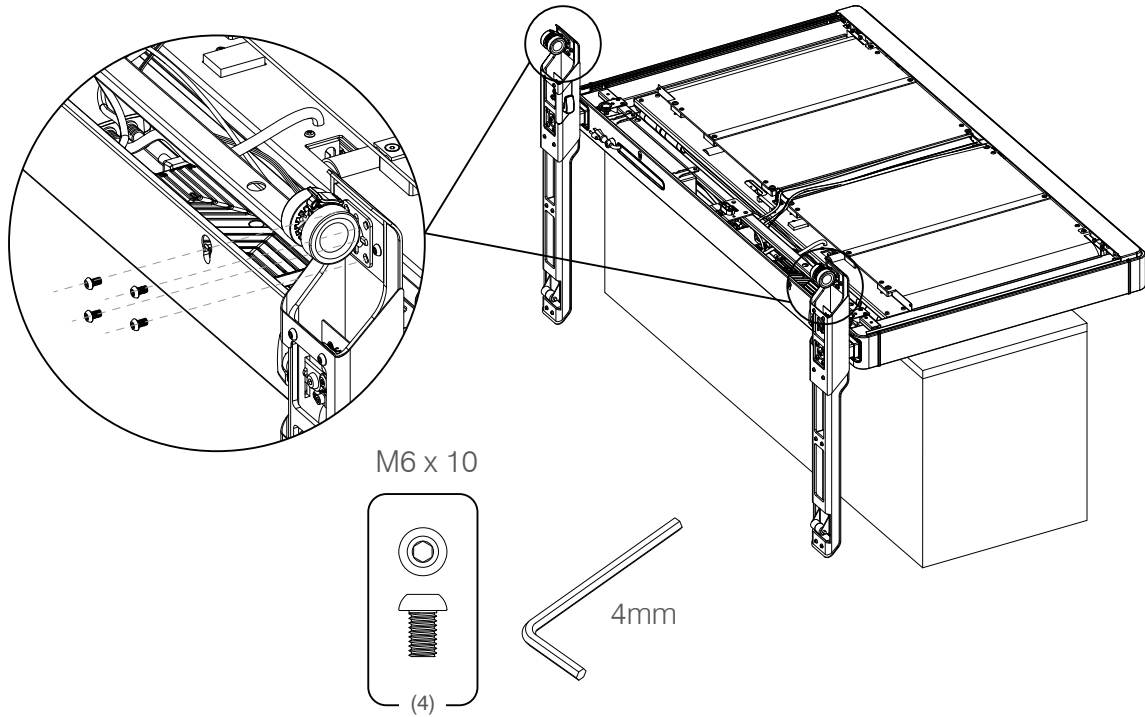

Step 7

Replace the damaged Rear Caster.

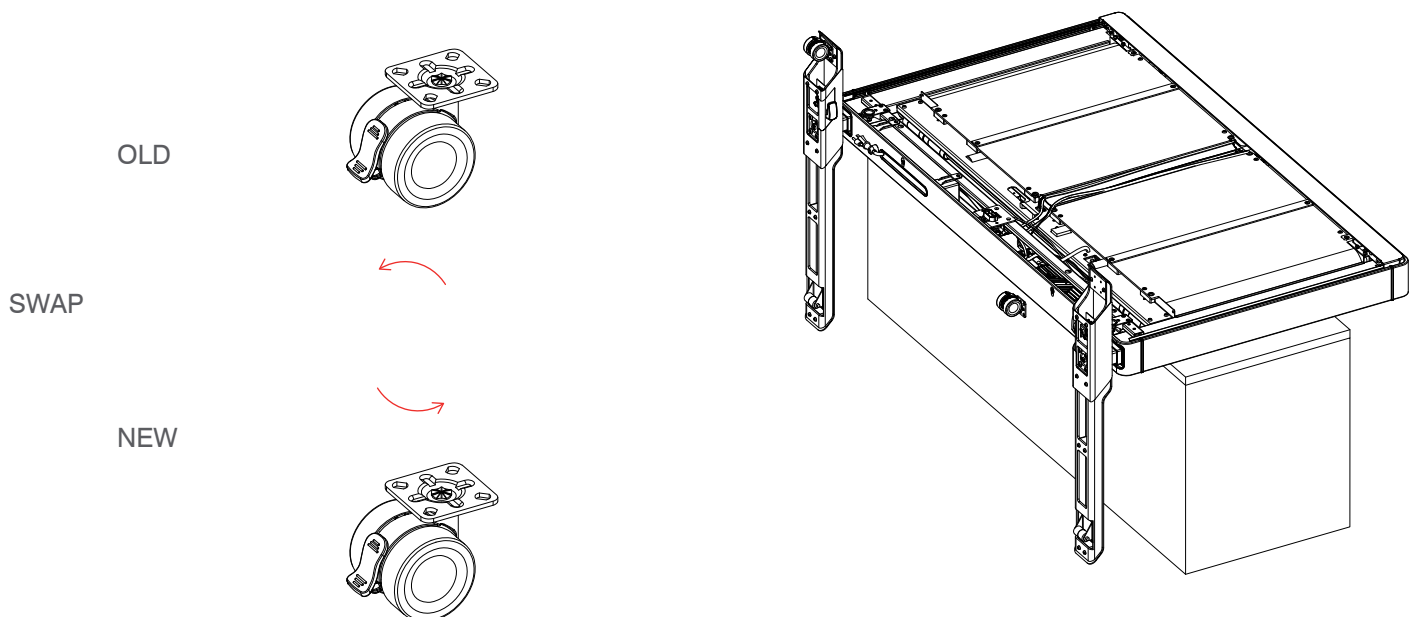

FRONT & REAR CASTORS REPLACEMENT

Step 8

Use a 4mm hex key to tightly the four M6x10 screws.

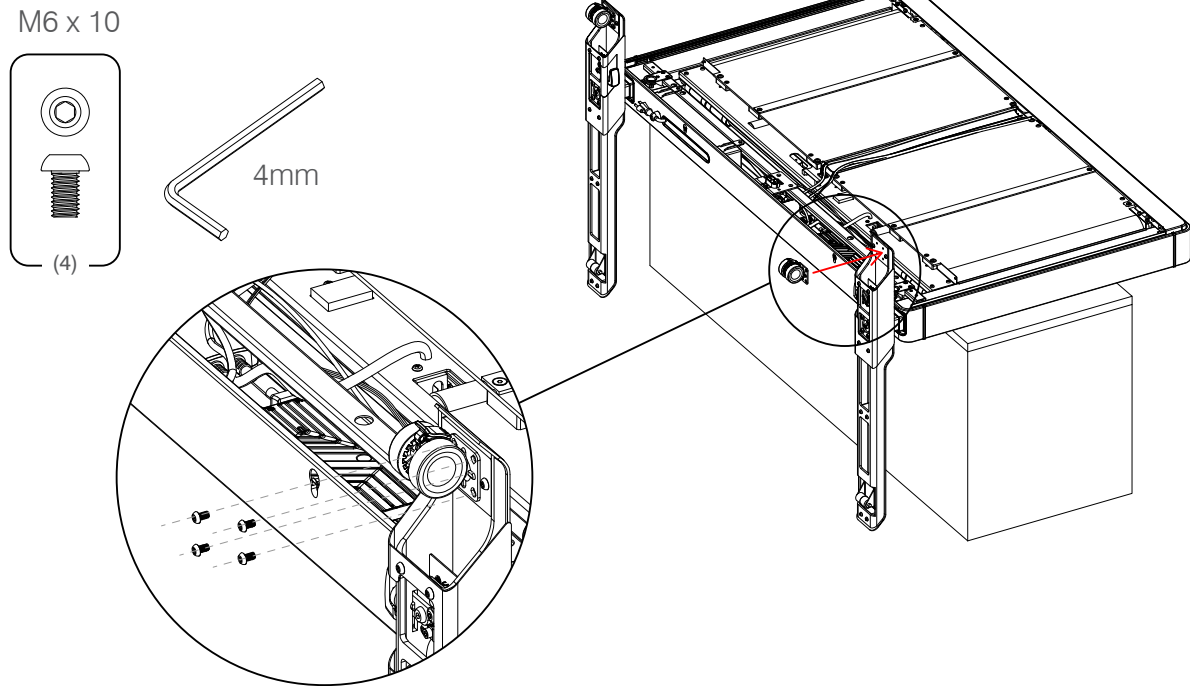

Step 9

Use a 4mm hex key to remove the four M6x10 screws on the Front Casters.

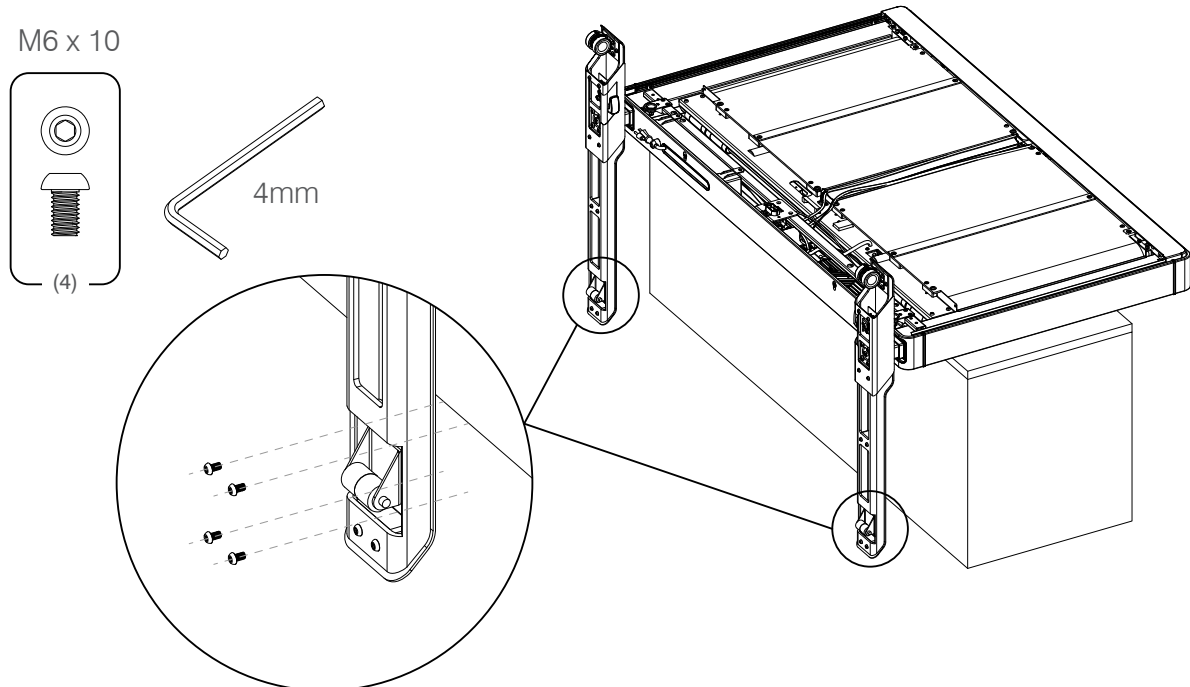

FRONT & REAR CASTORS REPLACEMENT

Step 10

Replace the damaged Front Caster.

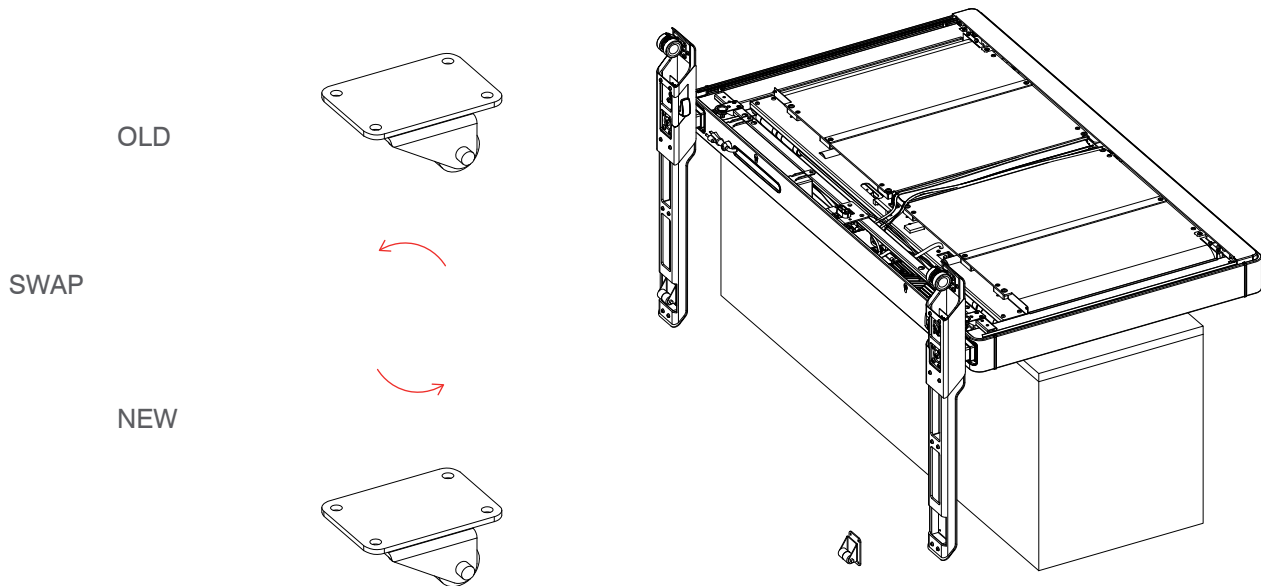

Step 11

Use a 4mm hex key to tightly the four M6x10 screws.

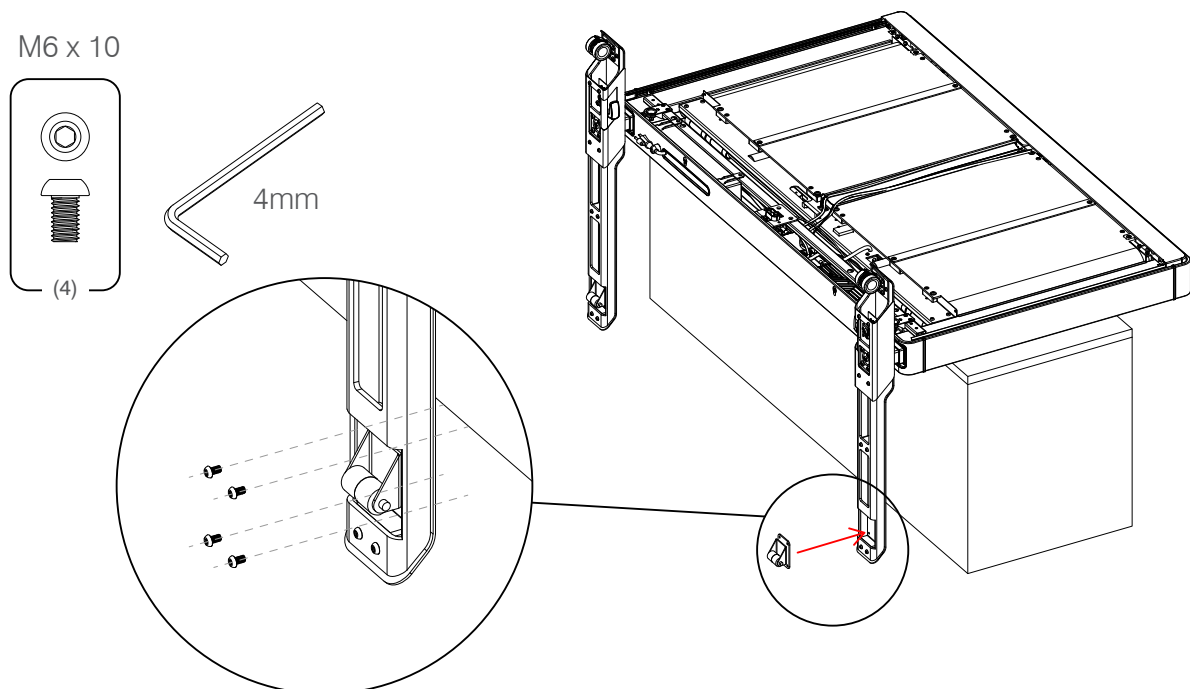

FRONT & REAR CASTORS REPLACEMENT

Step 12

After making sure all castors are properly installed and screws tighten, rotate the Amobi Desk back to its upright position.

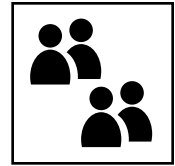

4 person

Notice: It will take 4 person to tilt the Amobi Desk into a horizontal position like the diagram below.

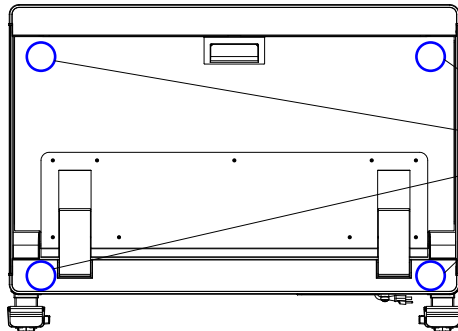

Four people should carry the table by holding these four points.

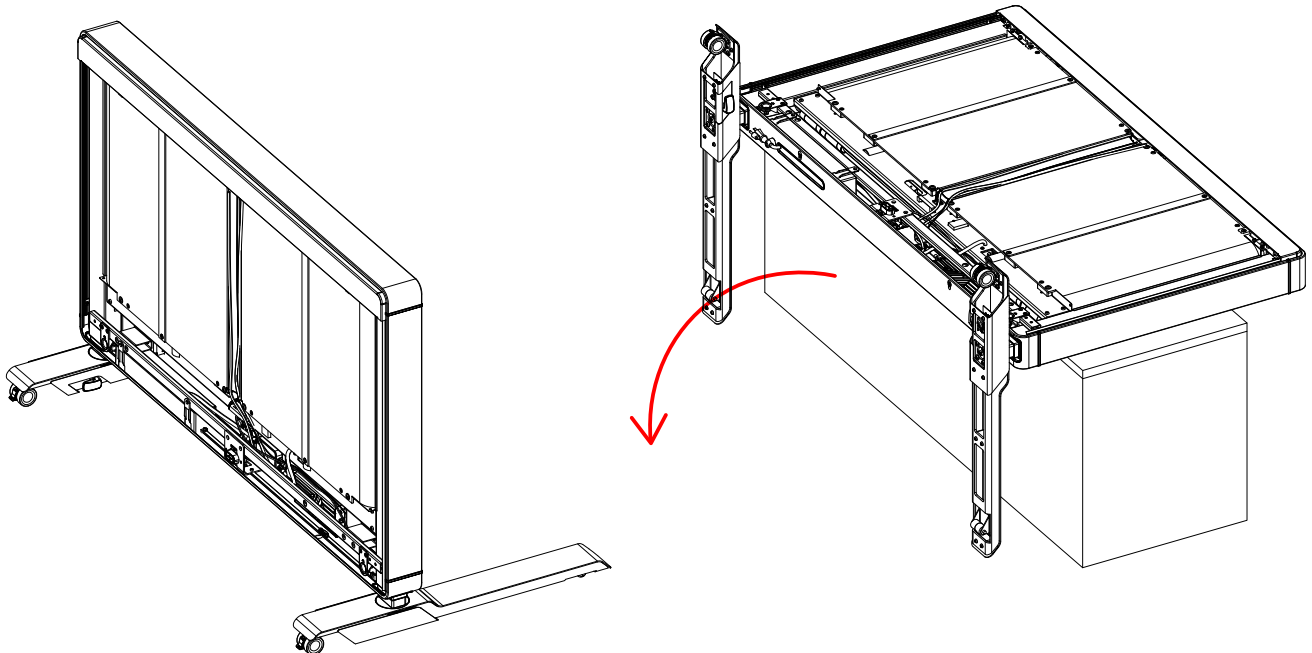

FRONT & REAR CASTORS REPLACEMENT

Step 13

Connect the power supply and raise the table to a height suitable for Whiteboard/Felt Tackboard installation.

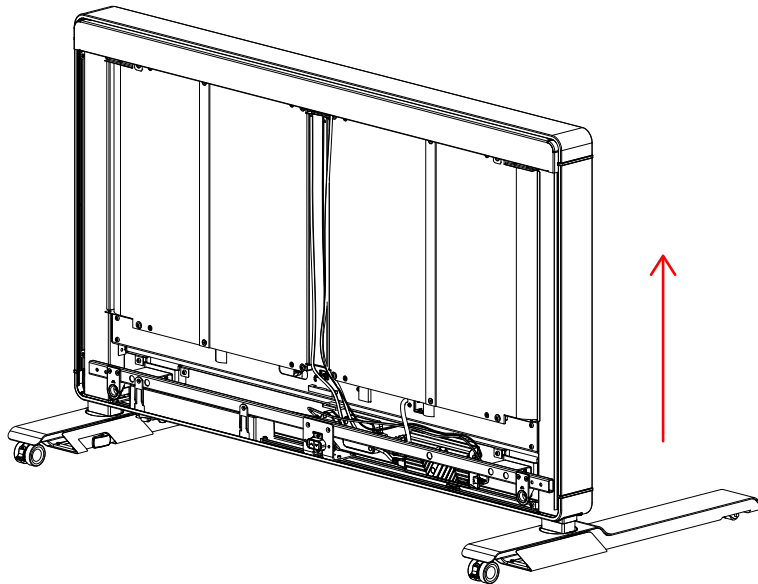

Step 14

Align the Whiteboard/Felt Tackboard into the Rear Panel Slot above at a slightly tilted angle.

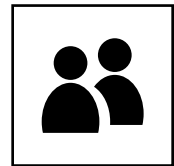
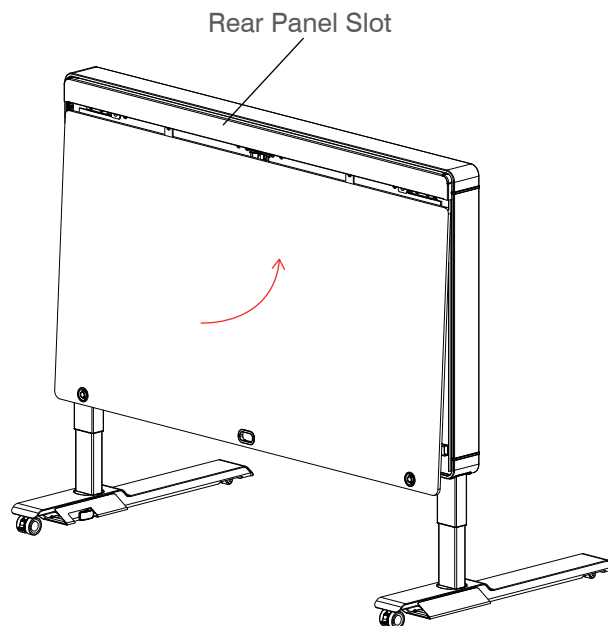

2 person

Notice: To avoid damage, 2 person is required while installing/removing the Whiteboard or Felt Tackboard.

FRONT & REAR CASTORS REPLACEMENT

Step 15

Insert the Whiteboard/Felt Tackboard into the Rear Panel Slot at an angle with a straight trajectory.

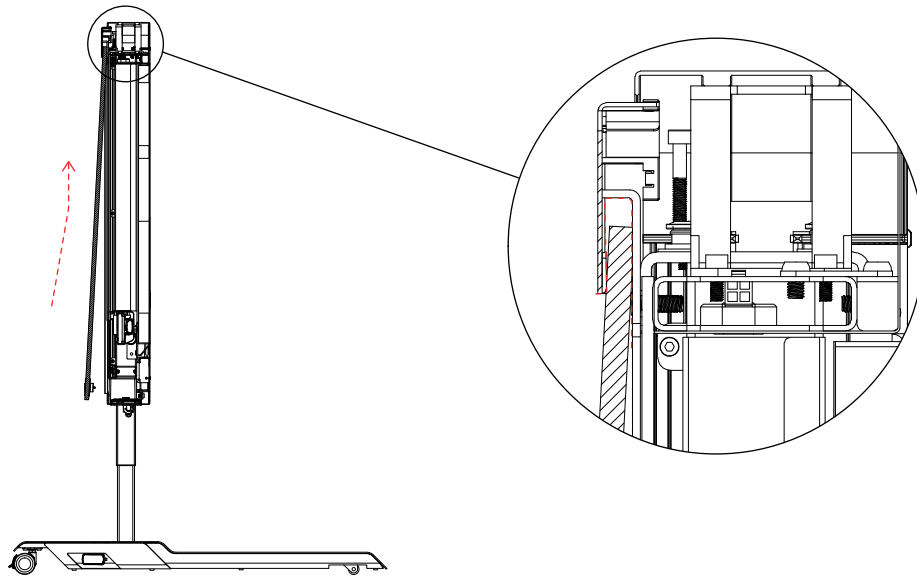

Step 16

1. Ensure that the Rear Handset is aligned to the Handset Bezel opening. Press the Handset Bezel against the frame to ensure that it is magnetically engaged.
2. Ensure that the Push-Lock is aligned with the Push-Lock Socket. Flatten the Whiteboard/Felt Tackboard against the frame then press the Push-Lock Button on both sides to lock it in place.

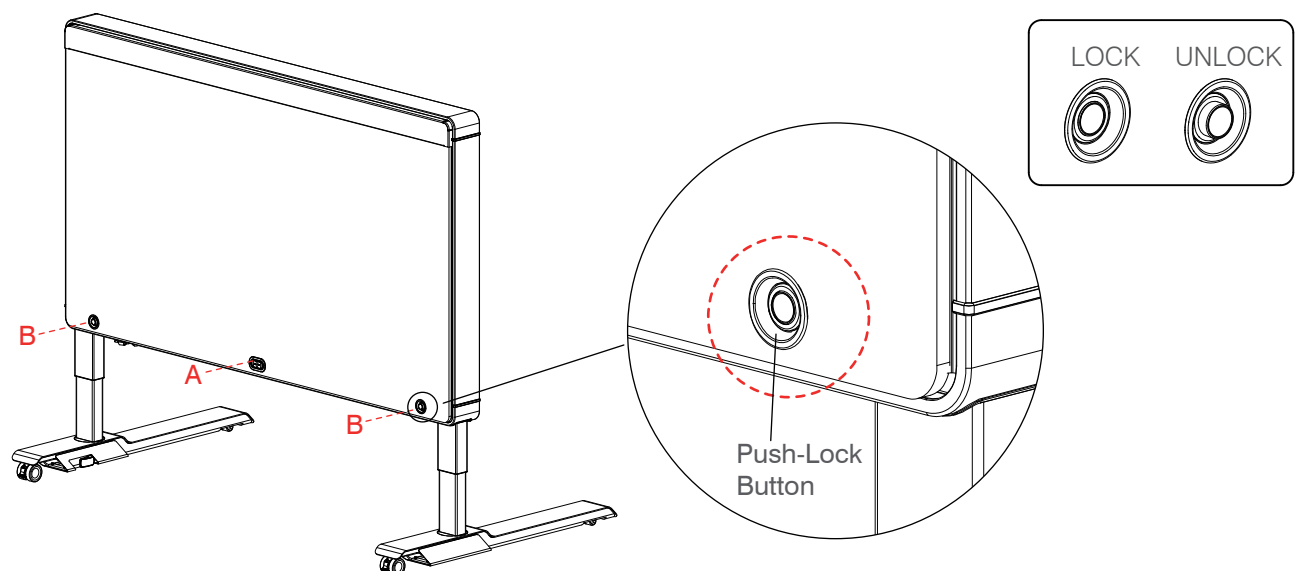

Whiteboard/Felt Tackboard can be locked or unlocked by pressing the Push-Lock Button.

FOOT LOCK SWITCH REPLACEMENT

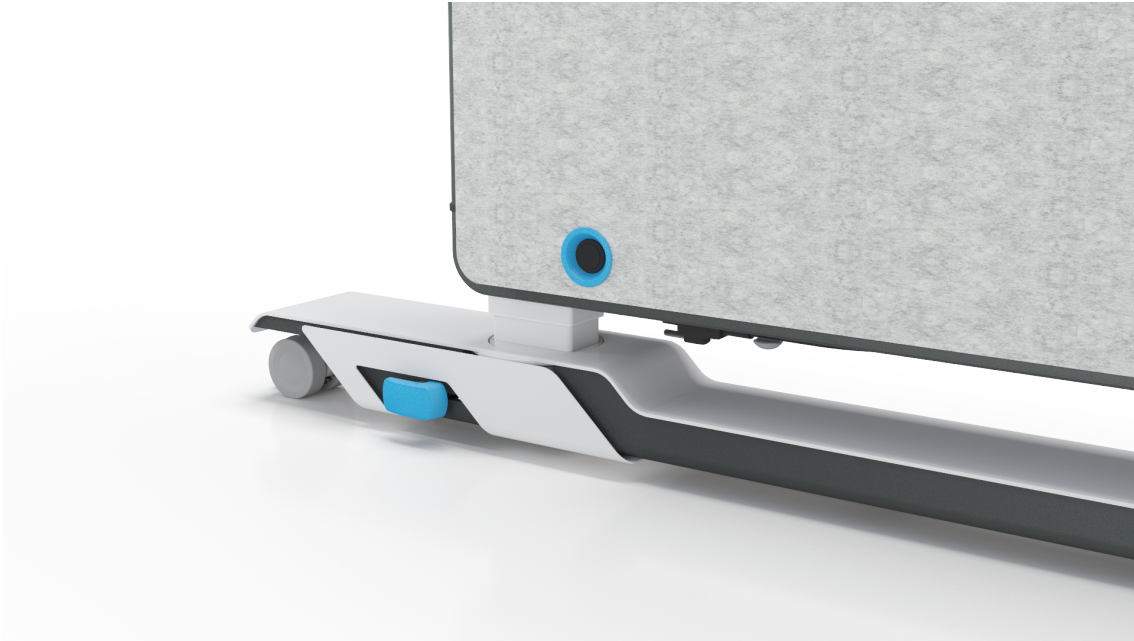

COMPONENTS

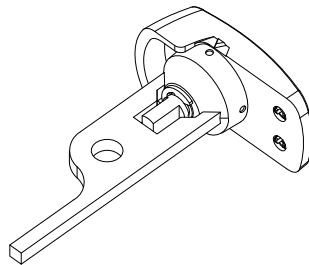

Foot Lock Switch

TOOL REQUIRED

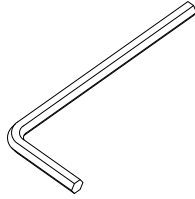

5mm Hex Key
x 1

FOOT LOCK SWITCH REPLACEMENT

Step 1

Whiteboard/Felt Tackboard can be unlocked by pressing the Push-Lock Buttons located on each side as indicated above.

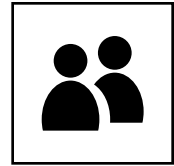

2 person

Notice: To avoid damage, 2 person is required while installing/removing the Whiteboard or Felt Tackboard.

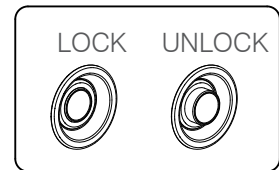
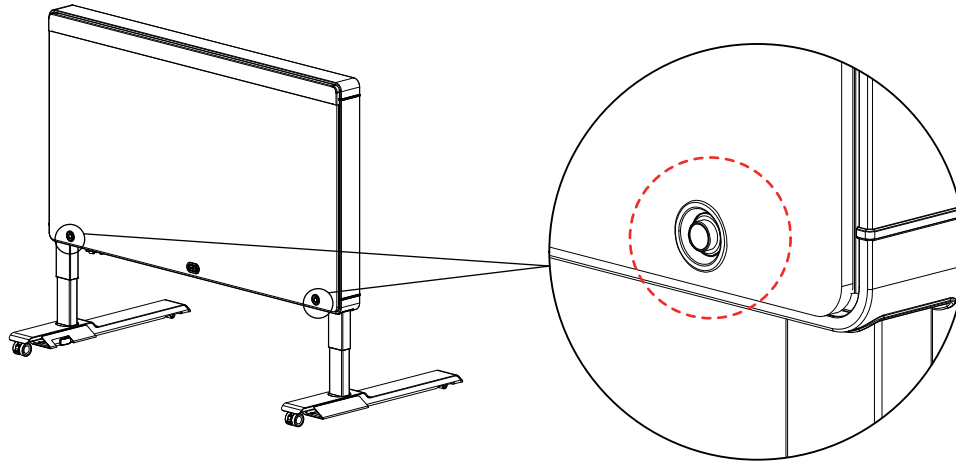

Step 2

Then pull the Whiteboard/Felt Tackboard outwards then downwards to remove it.

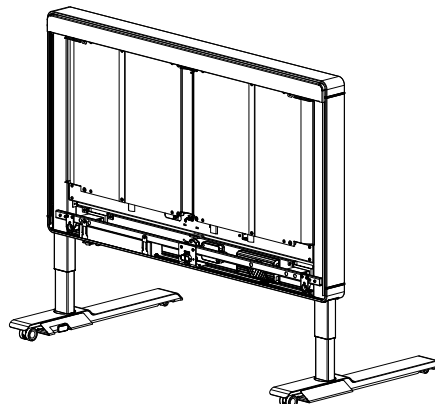
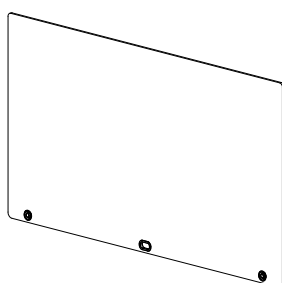
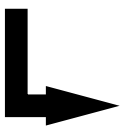
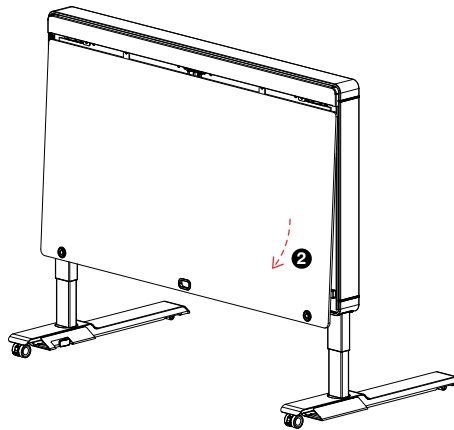
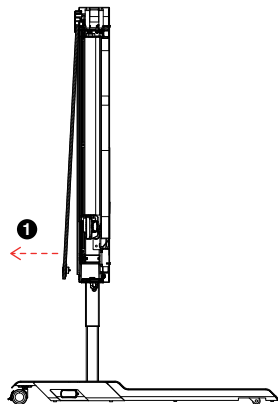

FOOT LOCK SWITCH REPLACEMENT

Step 3

Lower the Amobi Desk to its lowest position and unplug the power cable from the power supply.

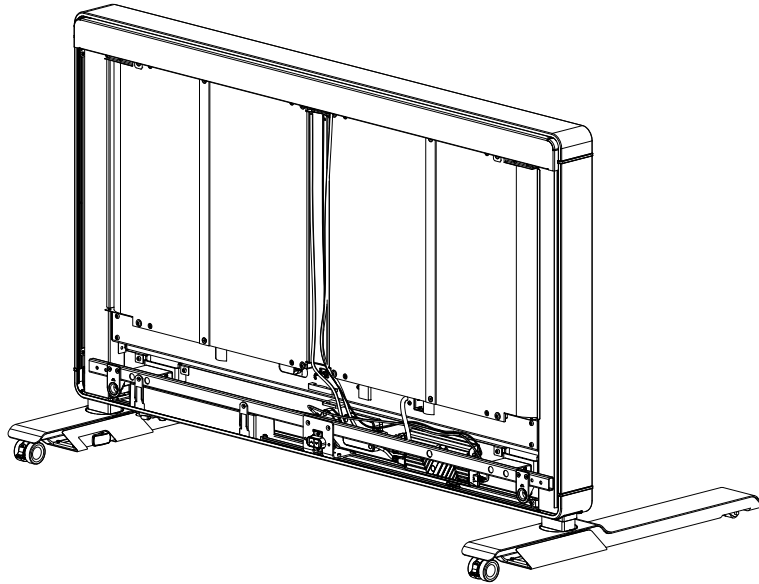

Step 4

Prepare a bench with soft cushion, as shown in the picture below.

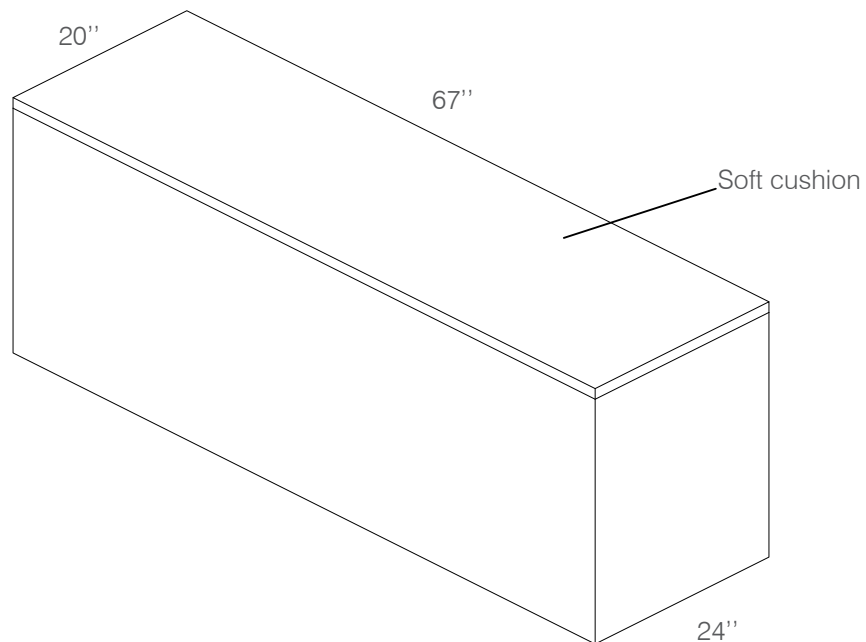

FOOT LOCK SWITCH REPLACEMENT

Step 5

Lay the Amobi Desk with its Worksurface facing downwards on the cushion, exposing the rear section of the Amobi Desk upwards.

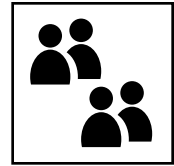

4 person

Notice: It will take 4 person to tilt the Amobi Desk into a horizontal position like the diagram below.

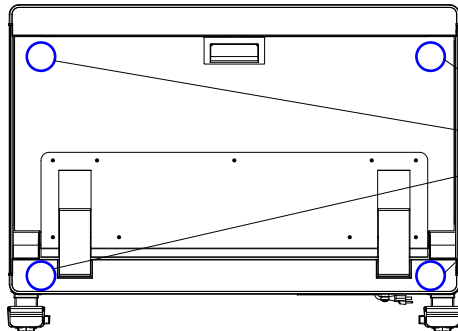

Four people should carry the table by holding these four points.

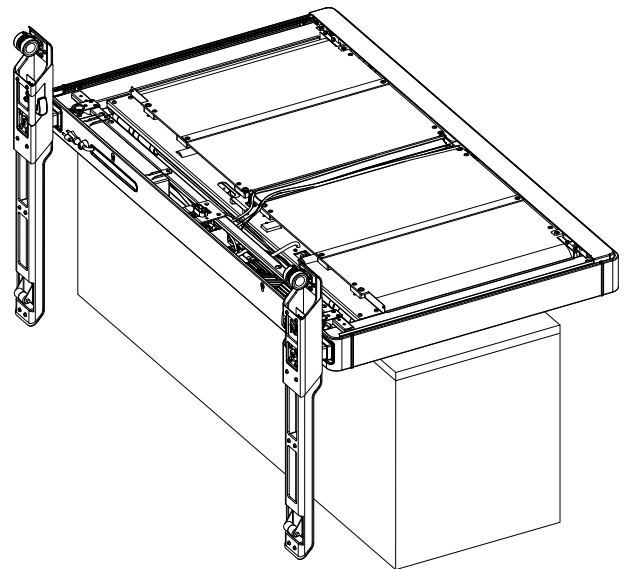
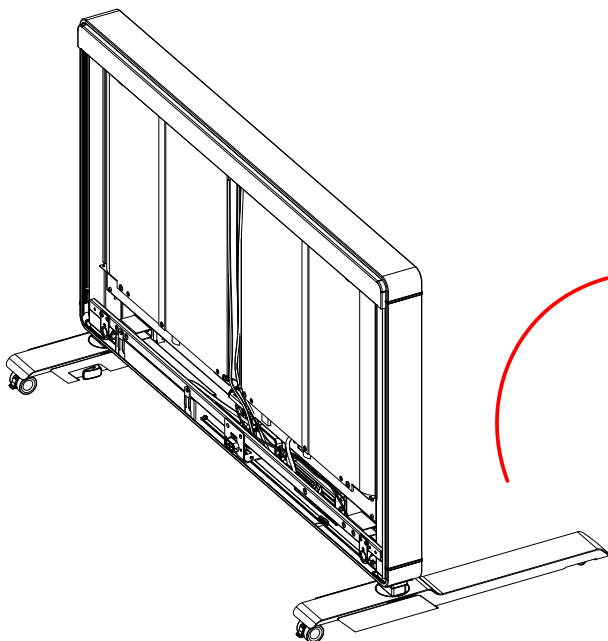

WARNING

Make sure the Amobi Desk is in a stabile position before beginning work.

FOOT LOCK SWITCH REPLACEMENT

Step 6

Use a 5mm hex key to remove the M8x12 screw on the Foot Lock Switch.

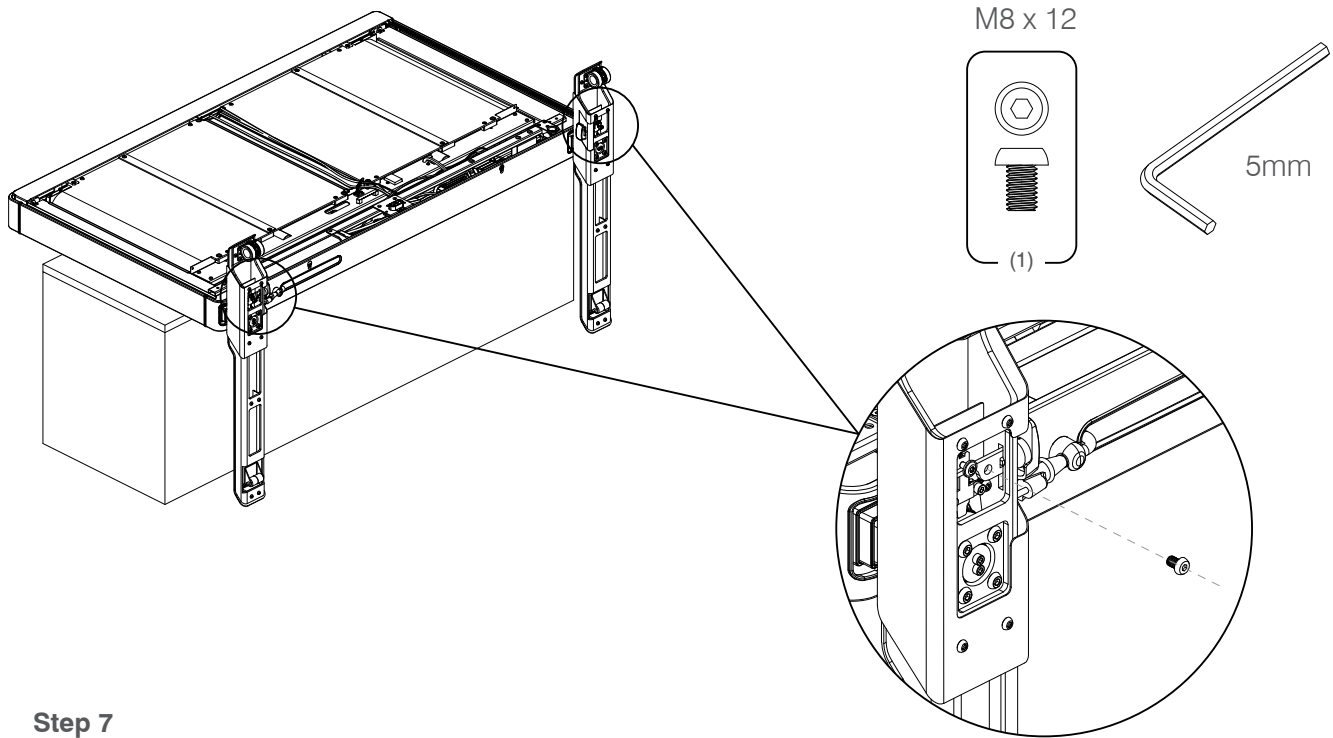

Step 7

Remove the damaged Foot Lock Switch.

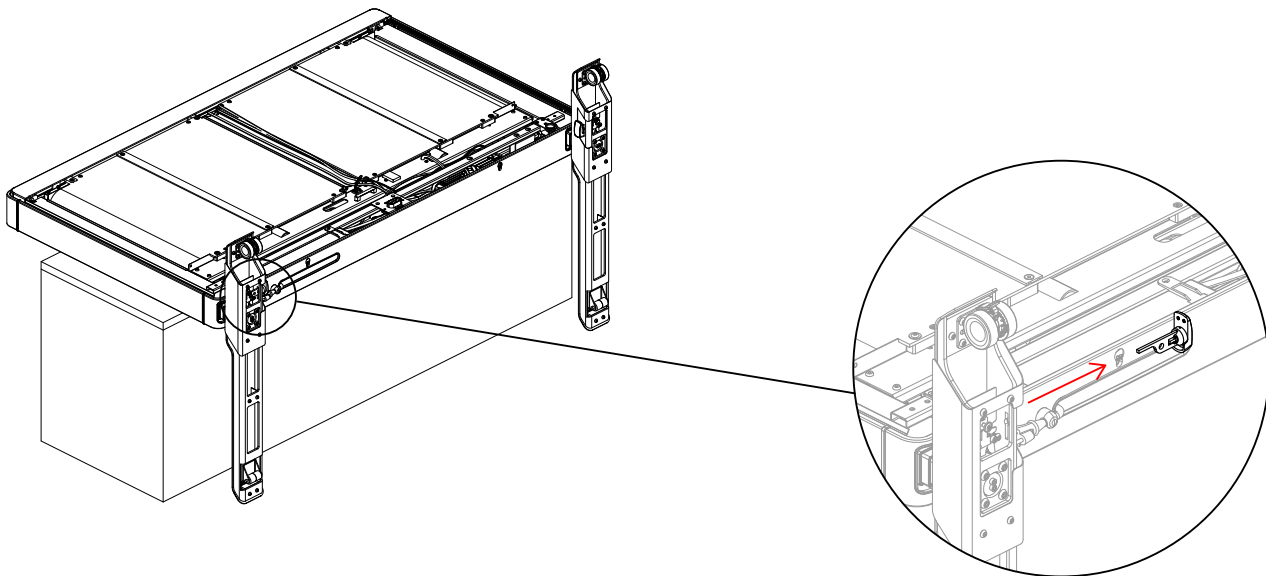

FOOT LOCK SWITCH REPLACEMENT

Step 8

Replace the damaged Foot Lock Switch.

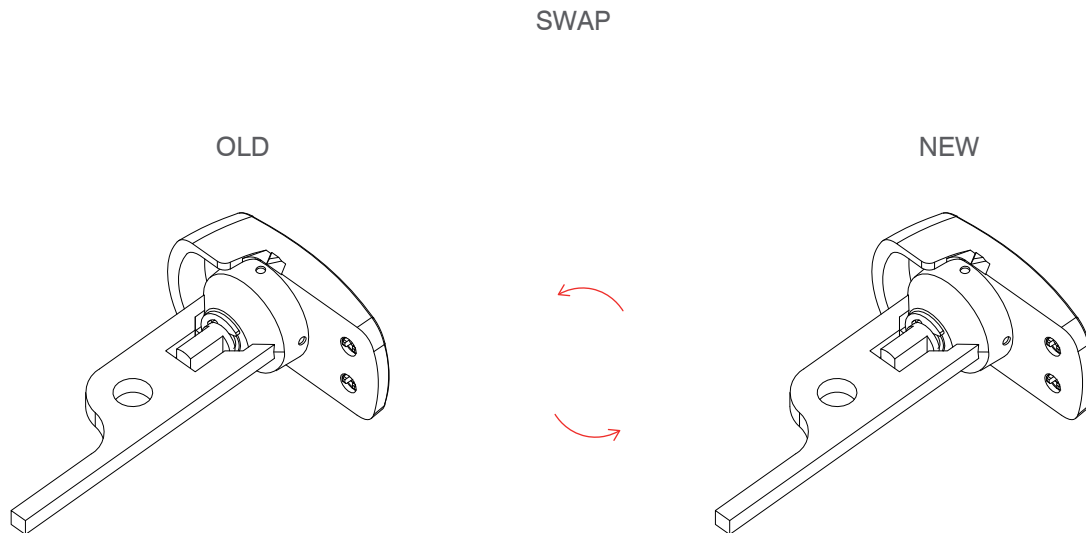

Step 9

Reinstall the Foot Lock Switch.

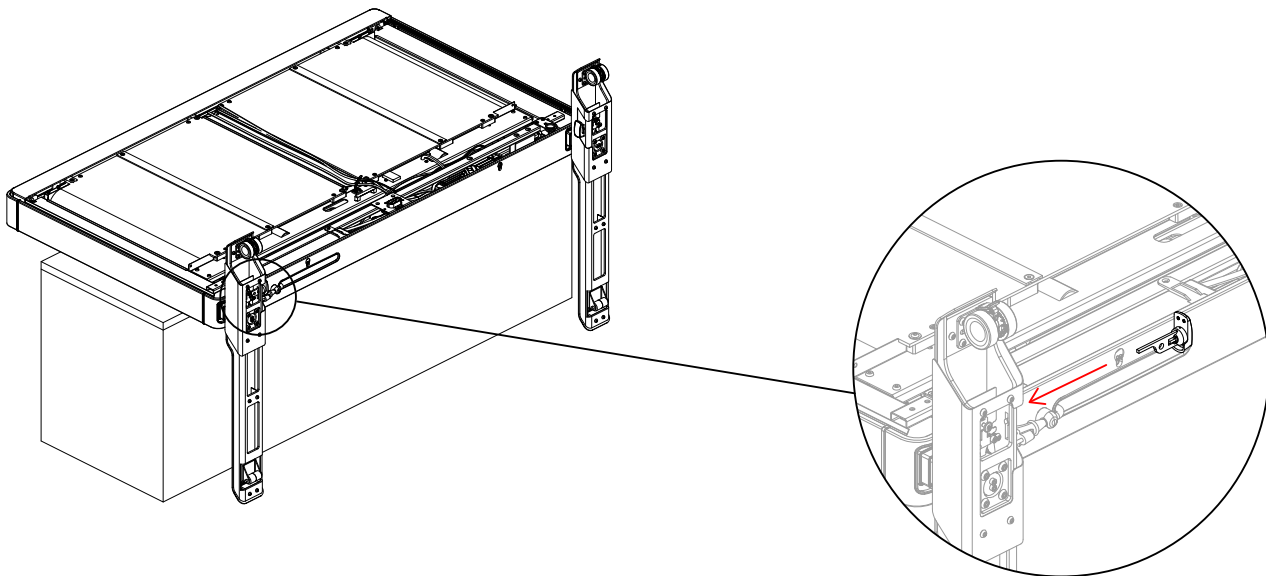

FOOT LOCK SWITCH REPLACEMENT

Step 10

Use a 5mm hex key to tightly the M8x12 screw on the Foot Lock Switch.

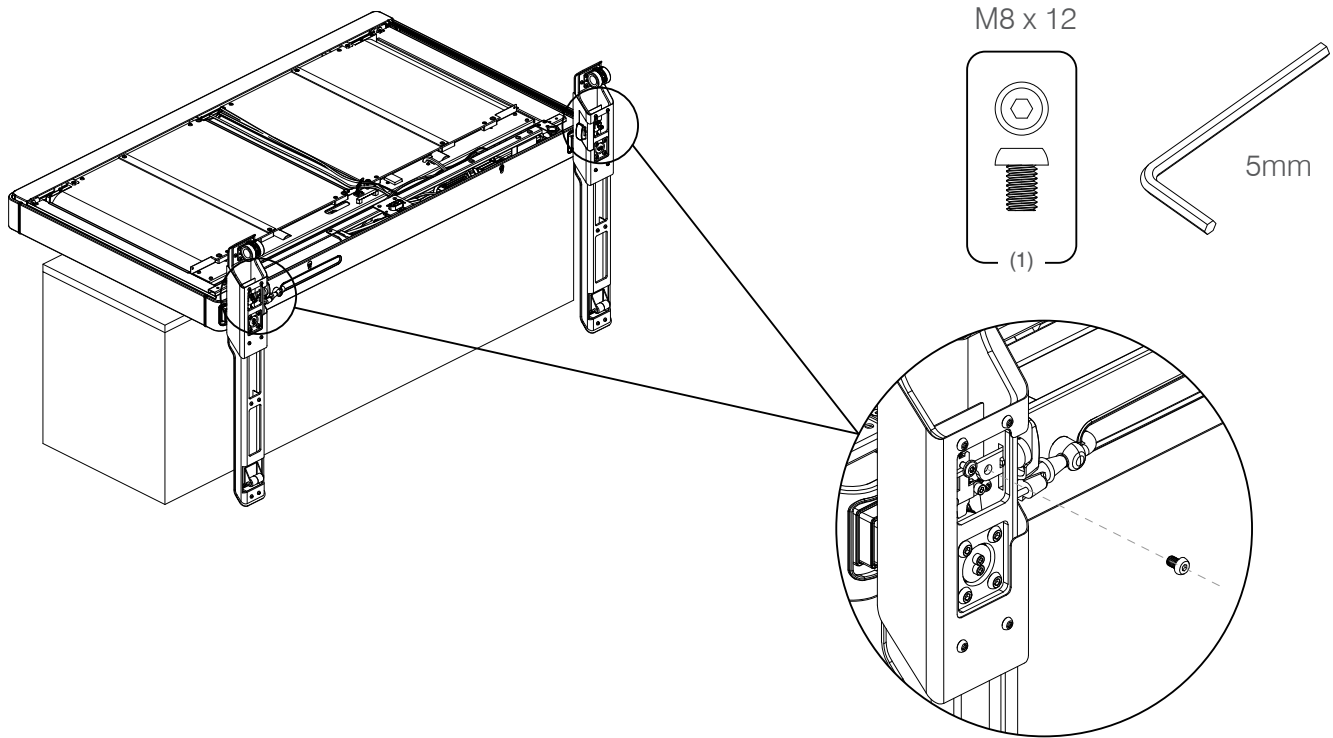

FOOT LOCK SWITCH REPLACEMENT

Step 11

After making sure the Foot Lock Switch is properly installed and screws tighten, rotate the Amobi Desk back to its upright position.

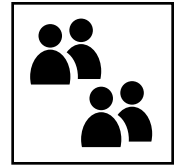

4 person

Notice: It will take 4 person to tilt the Amobi Desk into a horizontal position like the diagram below.

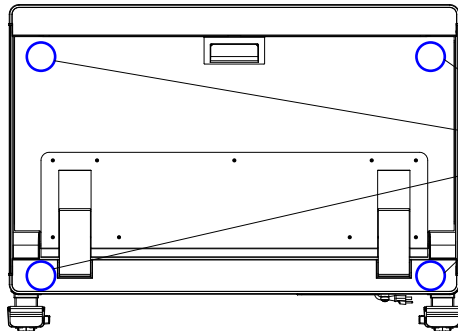

Four people should carry the table by holding these four points.

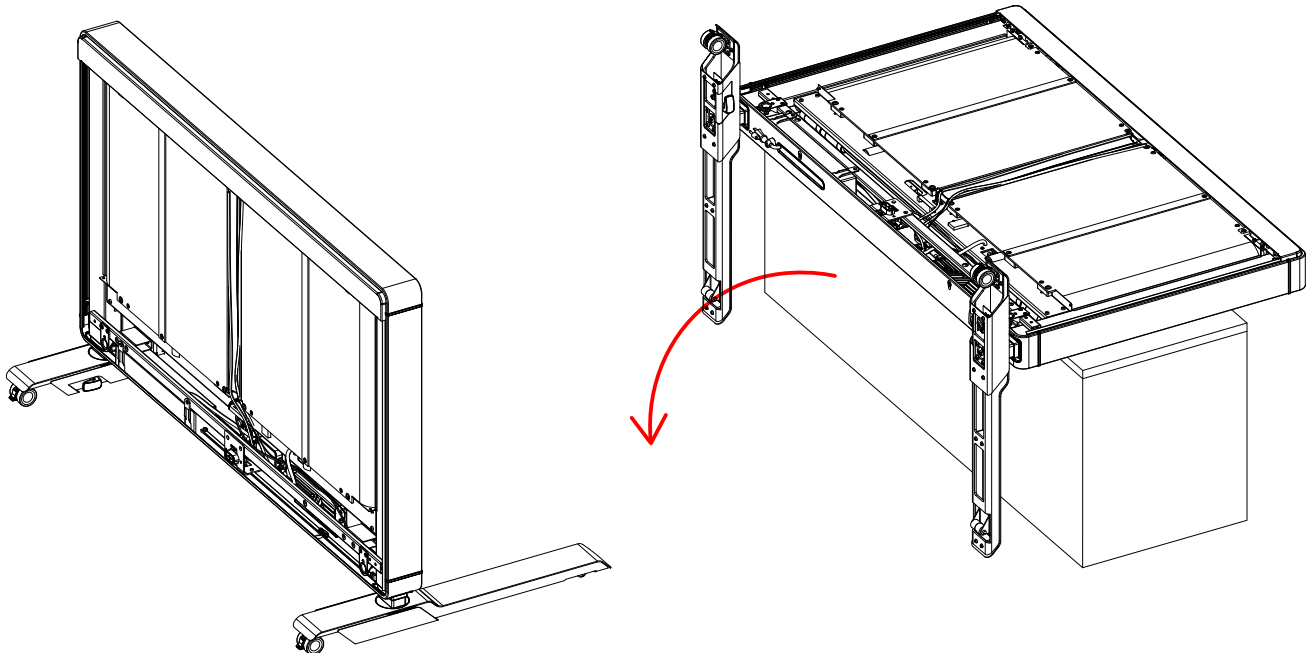

FOOT LOCK SWITCH REPLACEMENT

Step 12

Connect the power supply and raise the table to a height suitable for Whiteboard/Felt Tackboard installation.

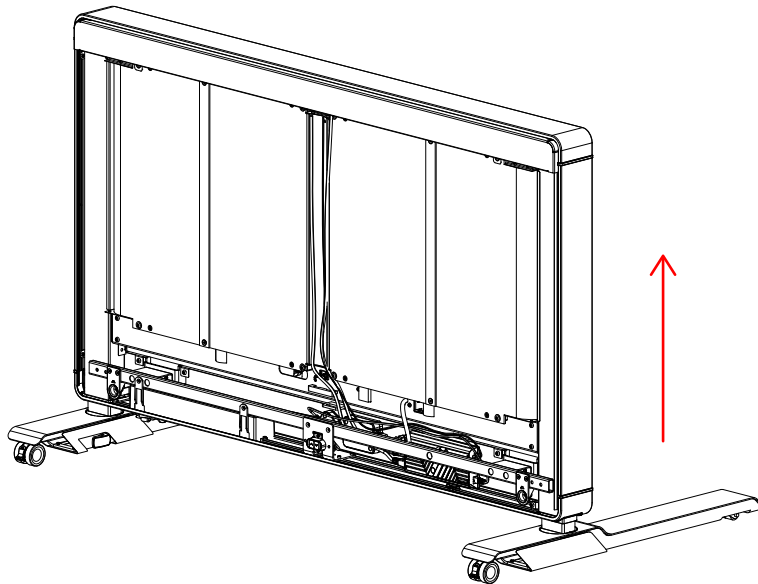

Step 13

Align the Whiteboard/Felt Tackboard into the Rear Panel Slot above at a slightly tilted angle.

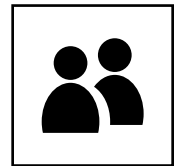
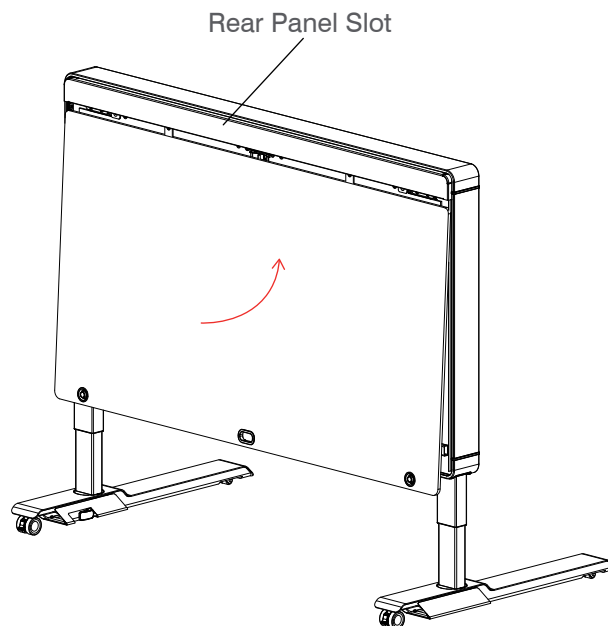

2 person

Notice: To avoid damage, 2 person is required while installing/removing the Whiteboard or Felt Tackboard.

FOOT LOCK SWITCH REPLACEMENT

Step 14

Insert the Whiteboard/Felt Tackboard into the Rear Panel Slot at an angle with a straight trajectory.

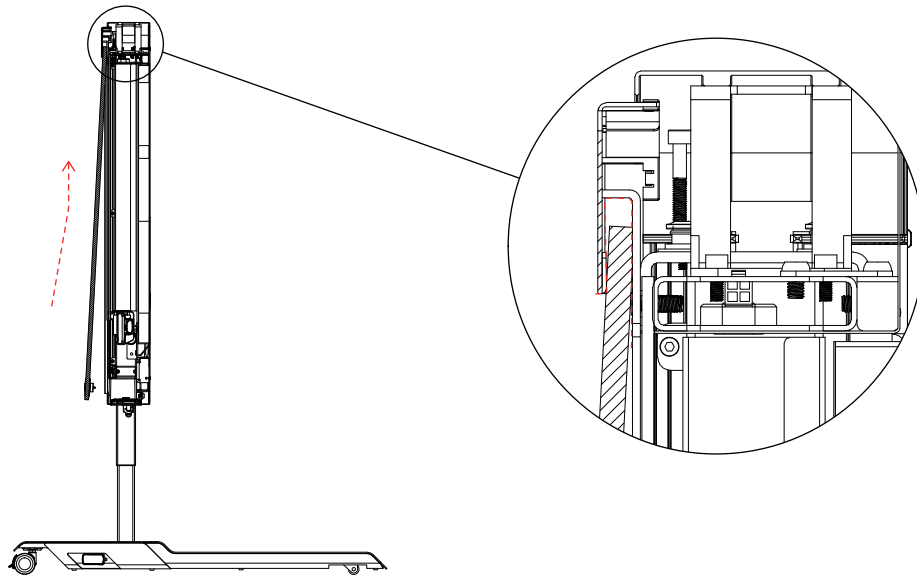

Step 15

1. Ensure that the Rear Handset is aligned to the Handset Bezel opening. Press the Handset Bezel against the frame to ensure that it is magnetically engaged.
2. Ensure that the Push-Lock is aligned with the Push-Lock Socket. Flatten the Whiteboard/Felt Tackboard against the frame then press the Push-Lock Button on both sides to lock it in place.

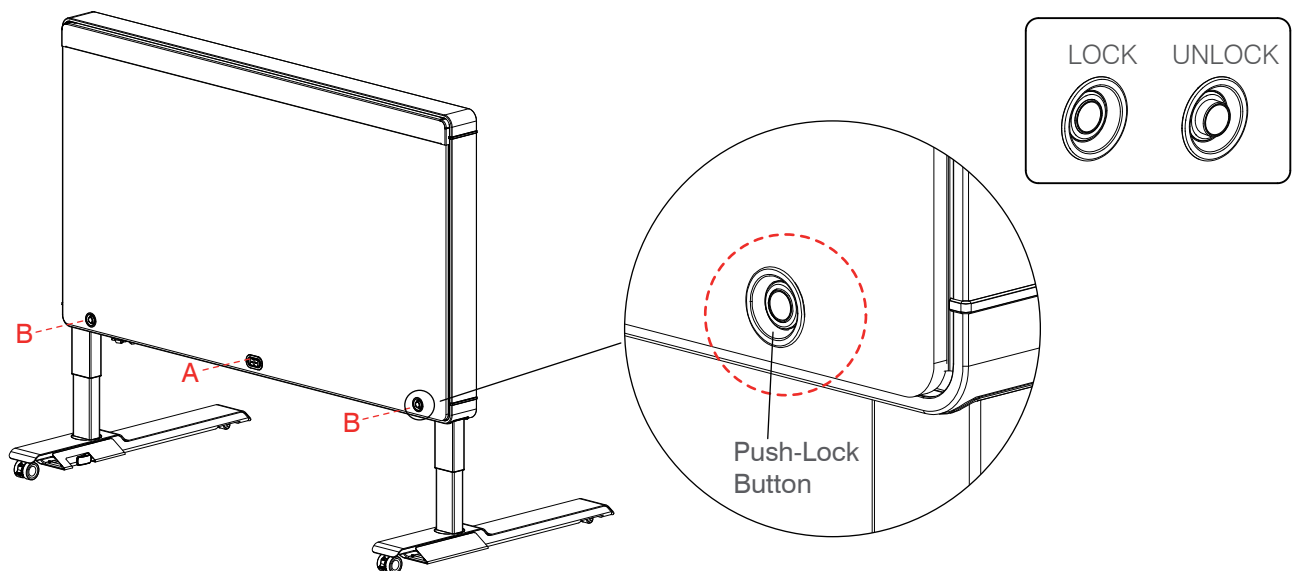

Whiteboard/Felt Tackboard can be locked or unlocked by pressing the Push-Lock Button.

POWER CORD REPLACEMENT

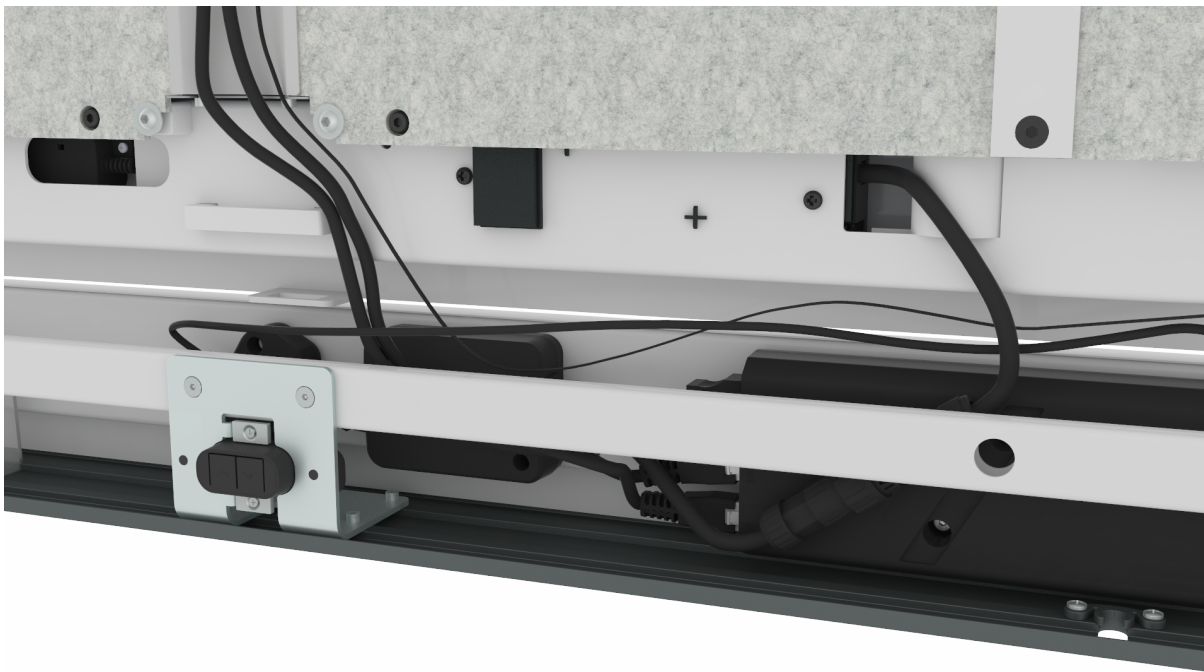

COMPONENTS

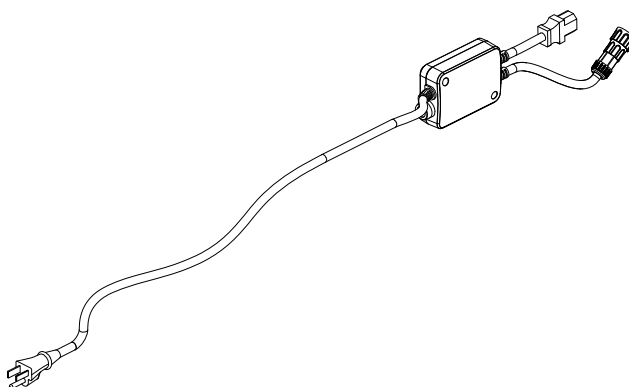

Power Cord

TOOLS REQUIRED

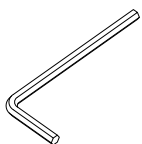

3mm Hex Key
x 1

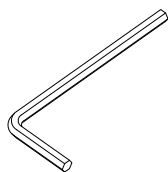

4mm Hex Key
x 1

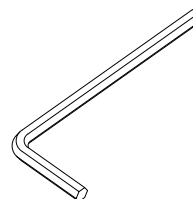

5mm Hex Key
x 1

POWER CORD REPLACEMENT

Step 1

Whiteboard/Felt Tackboard can be unlocked by pressing the Push-Lock Buttons located on each side as indicated above.

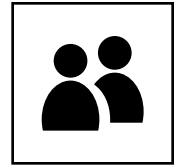
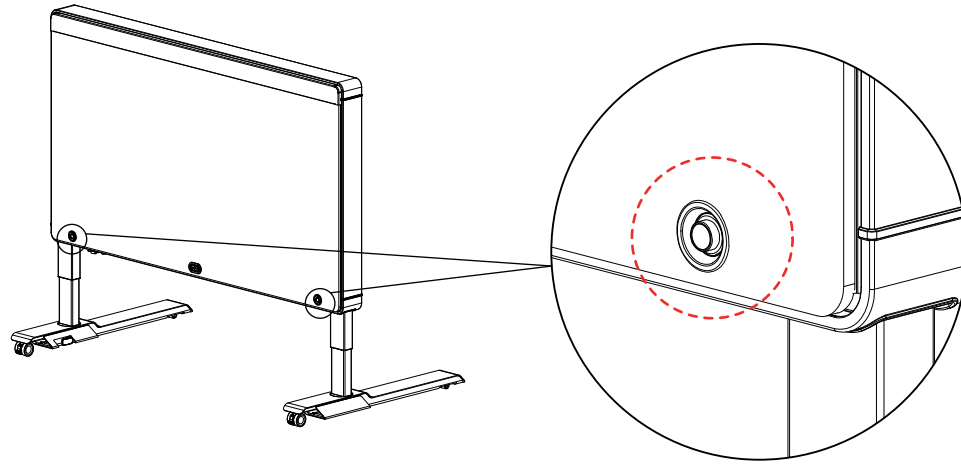

2 person

Notice : To avoid damage, 2 person is required while installing/removing the Whiteboard or Felt Tackboard.

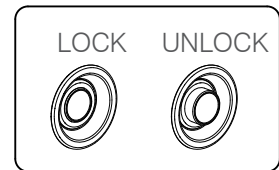

Step 2

Then pull the Whiteboard/Felt Tackboard outwards then downwards to remove it.

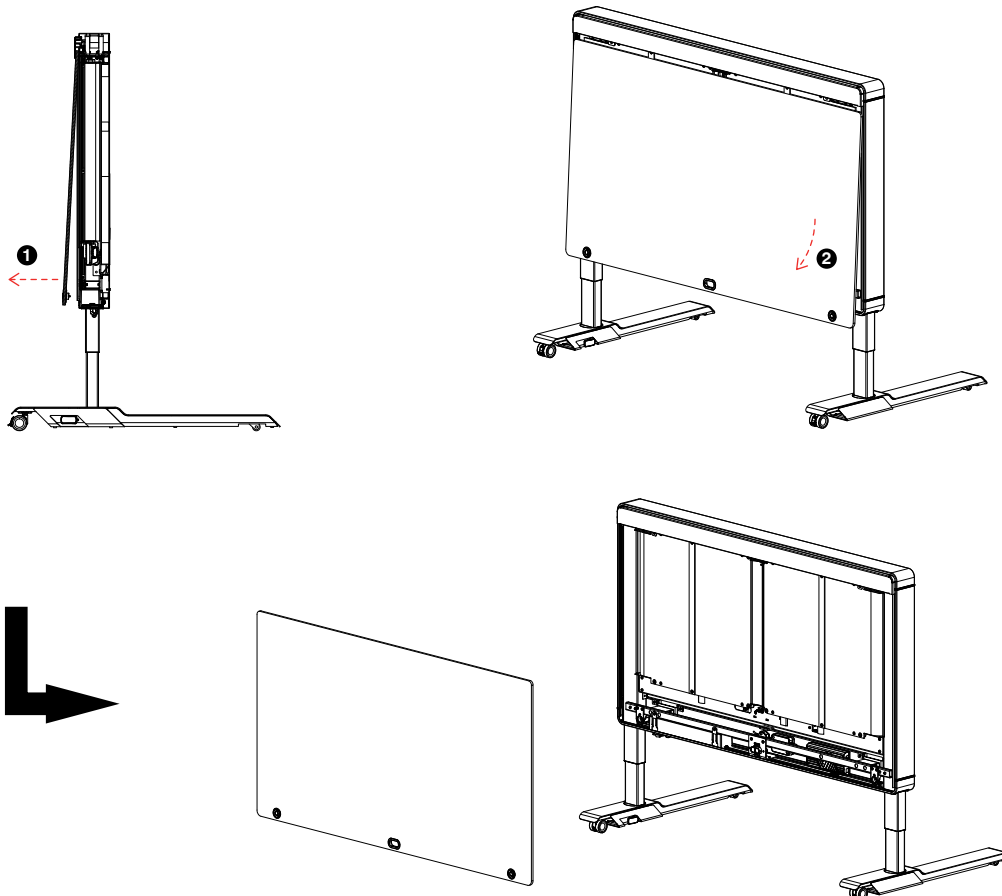

POWER CORD REPLACEMENT

Step 3

Remove the 12 screws from the Rear Beam as shown in the figure below.

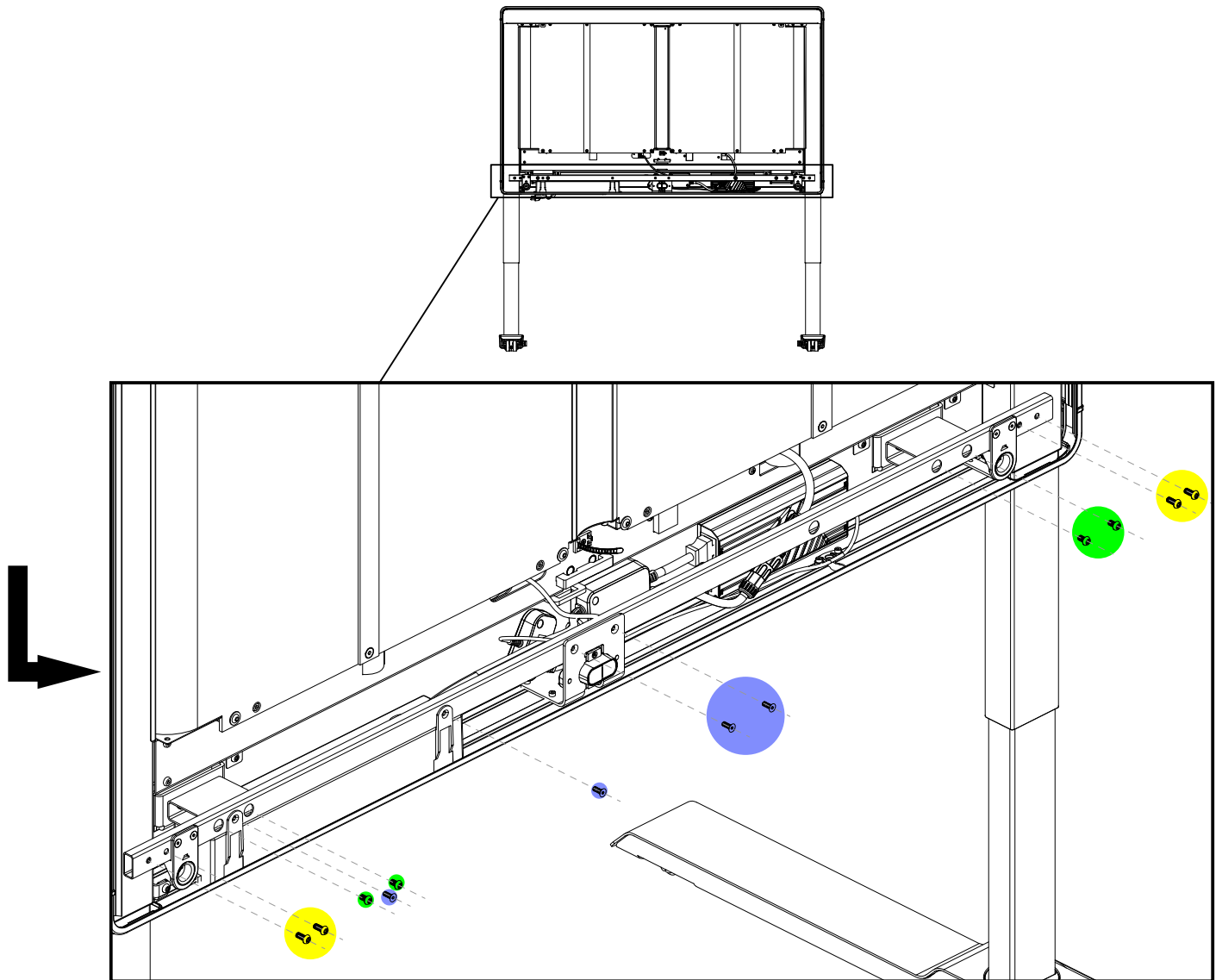

M6 x 14

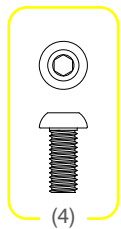

(4)

M5 x 14

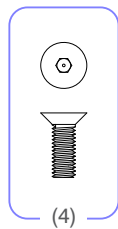

(4)

M6 x 10

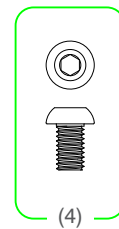

(4)

POWER CORD REPLACEMENT

Step 4

Remove the Rear Beam.

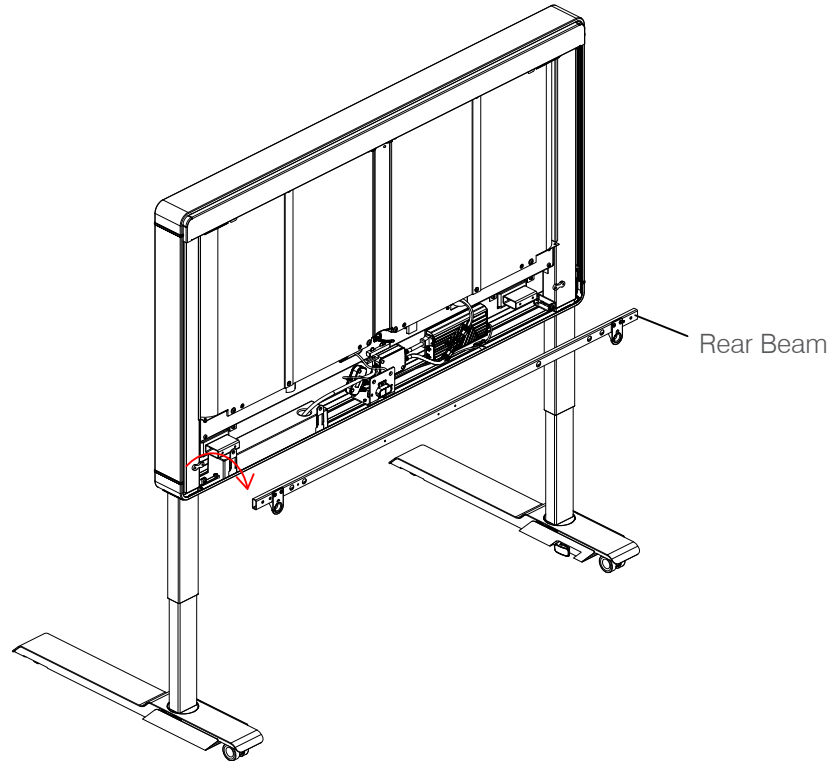

Step 5

Use a 3mm hex key to remove the two M4x16 screws.

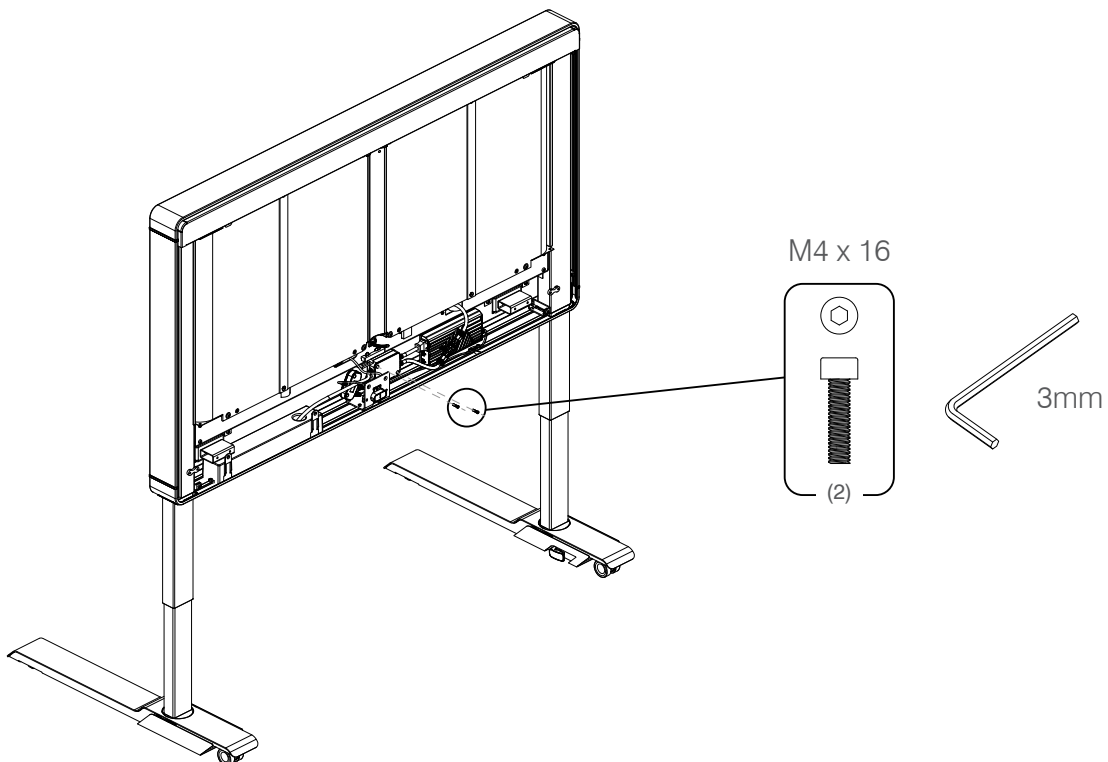

POWER CORD REPLACEMENT

Step 6

Unplug the Power Cord connector.

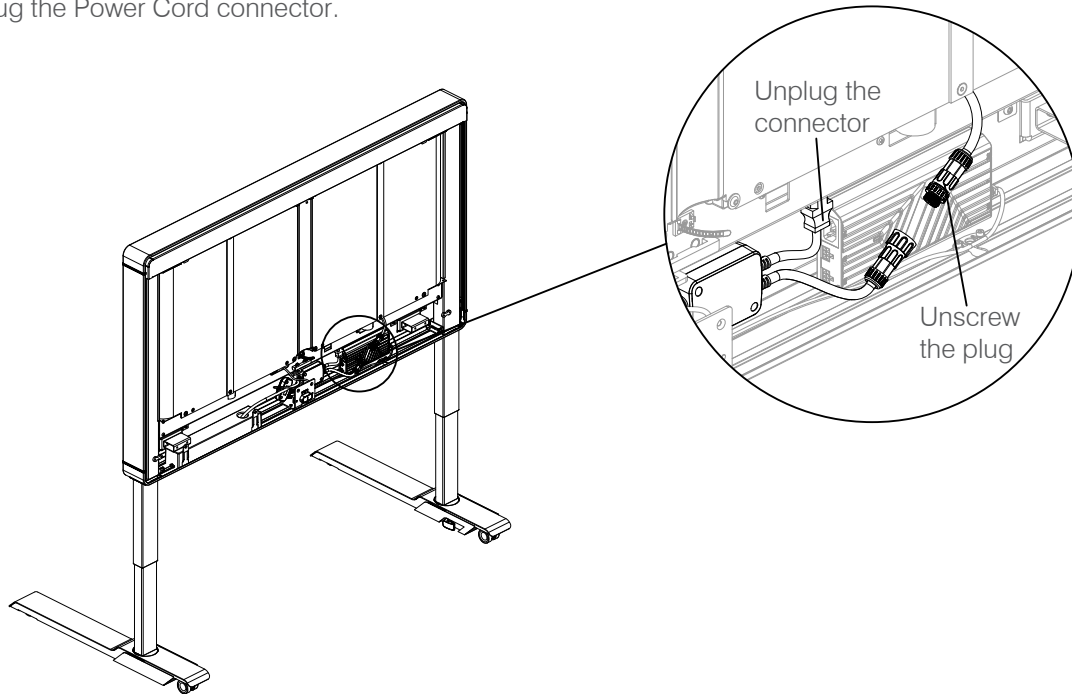

Step 7

Remove the Protective Cover.

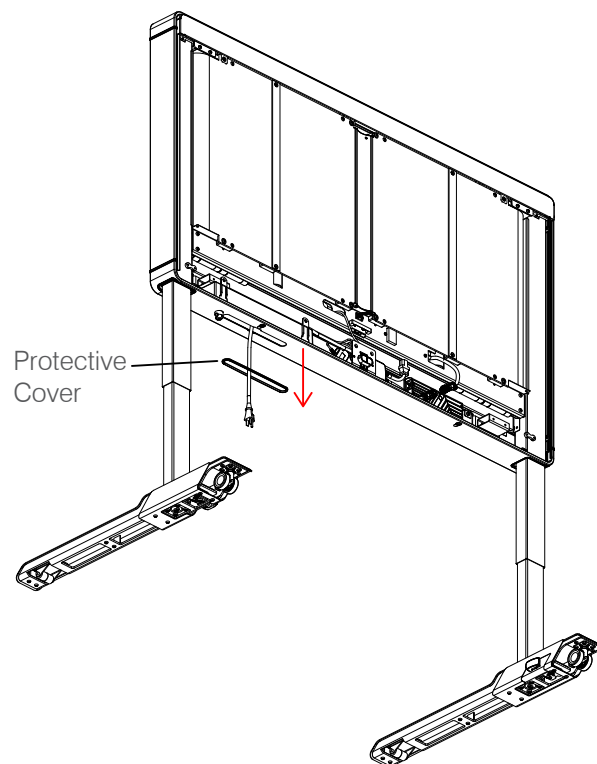

POWER CORD REPLACEMENT

Step 8

Replace the damaged Power Cord.

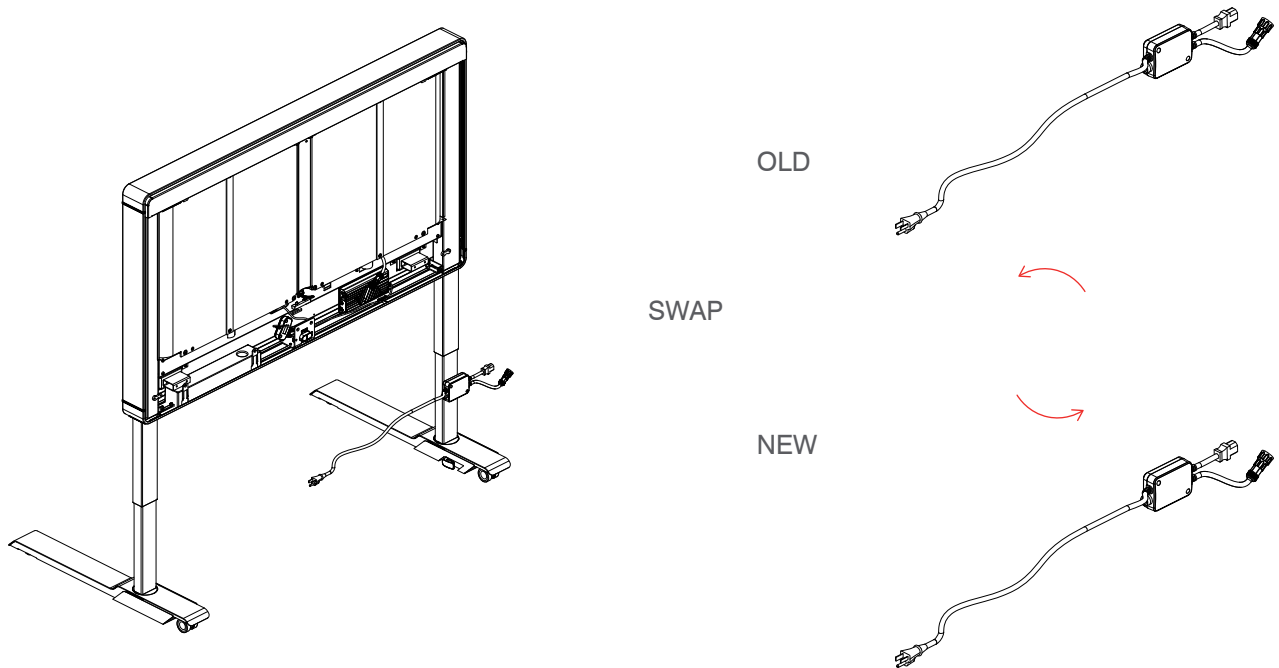

Step 9

Reinstall the Protective Cover.

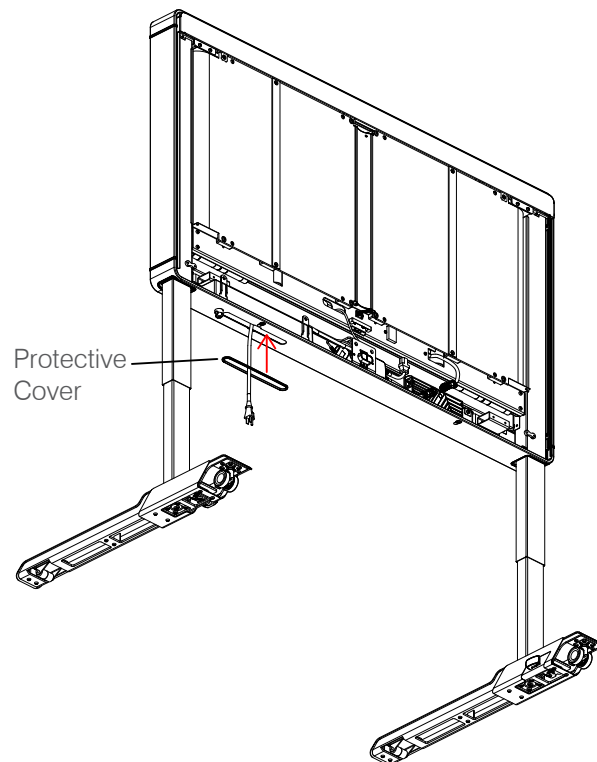

POWER CORD REPLACEMENT

Step 10

Use a 3mm hex key to tightly the two M4x16 screws.

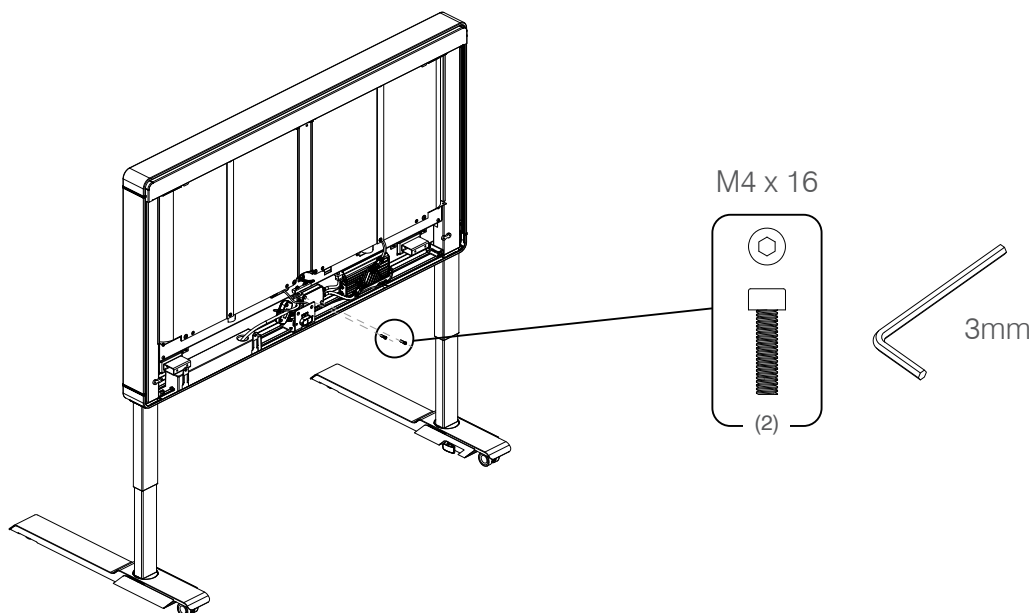

Step 11

Reconnect the wires.

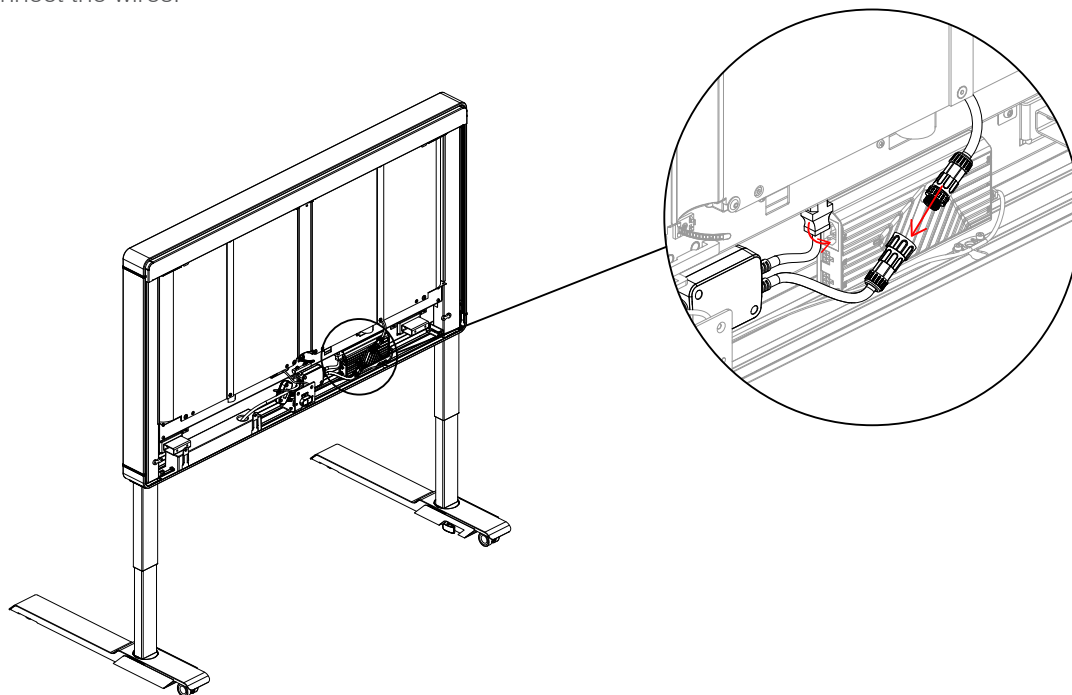

POWER CORD REPLACEMENT

Step 12

Connect the power supply and check if the Amobi Desk can operate normally.
When everything is ok, reinstall the Rear Beam.

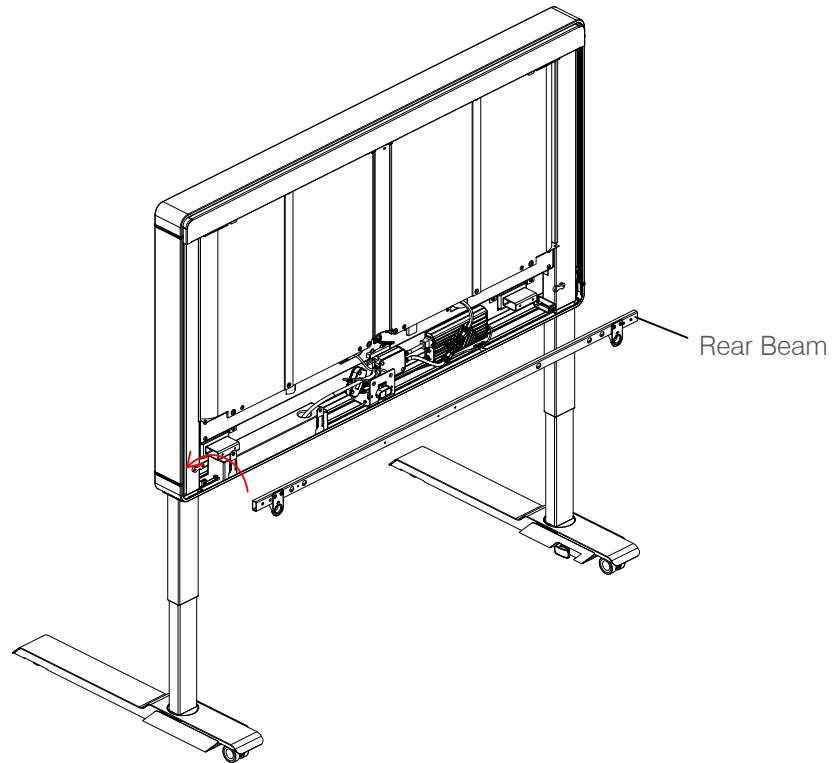

POWER CORD REPLACEMENT

Step 13

Use a 4mm hex key to tightly the four M6x14 screws and four M6x10 screws.
Use a 3mm hex key to tightly the four M5x14 screws.

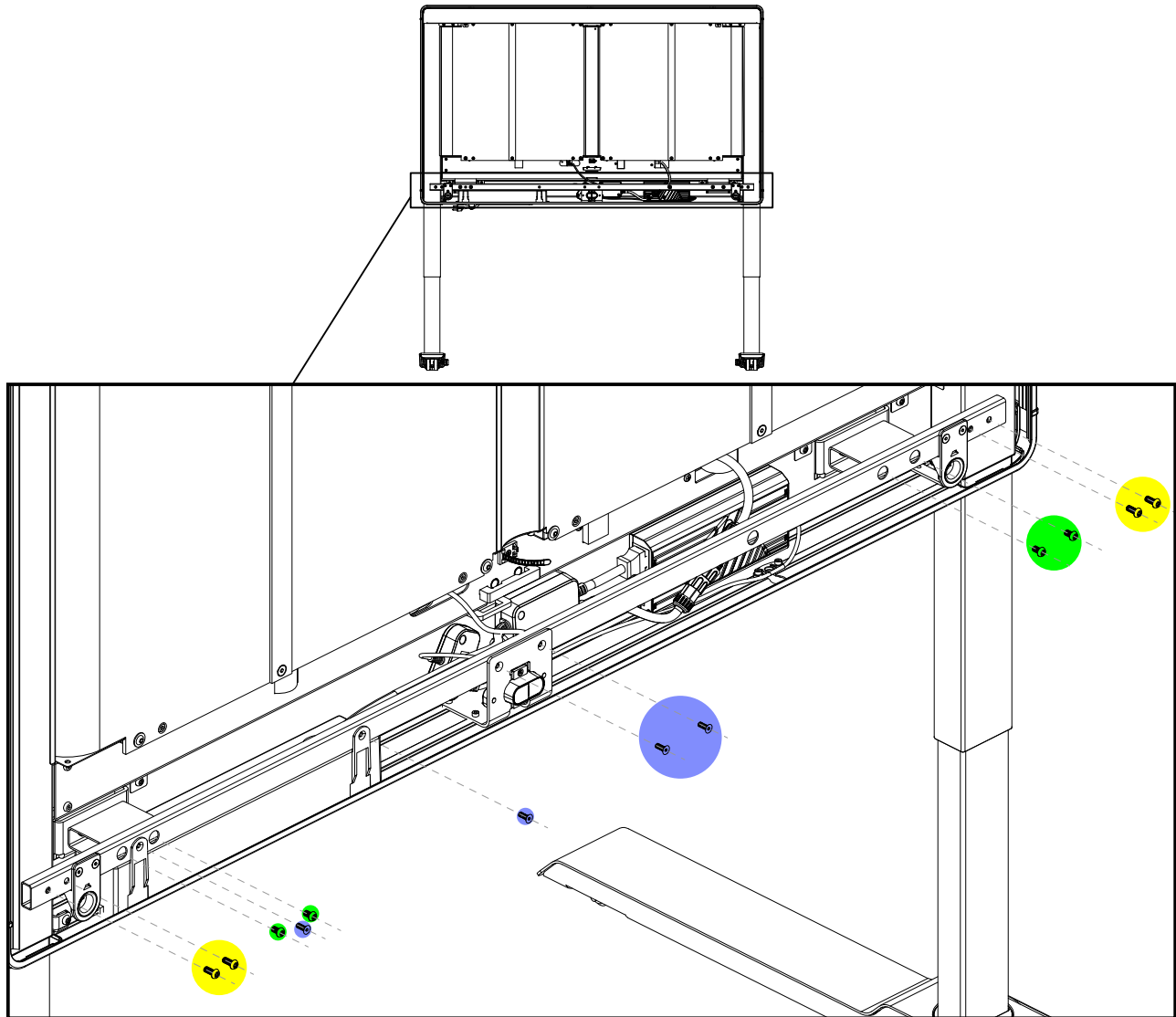

M6 x 14

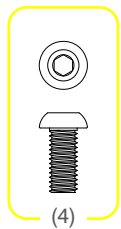

M5 x 14

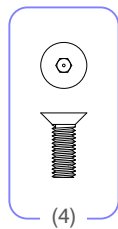

M6 x 10

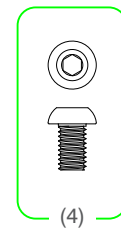

POWER CORD REPLACEMENT

Step 14

Align the Whiteboard/Felt Tackboard into the Rear Panel Slot above at a slightly tilted angle.

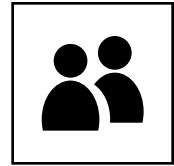

2 person

Notice : To avoid damage, 2 person is required while installing/removing the Whiteboard or Felt Tackboard.

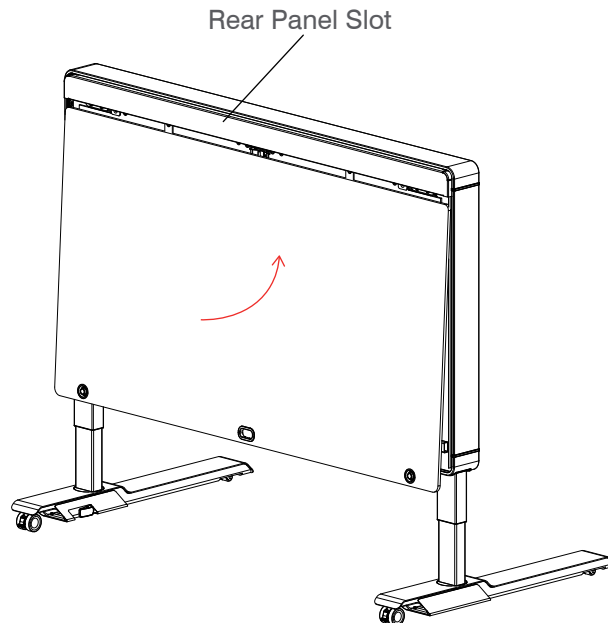

Step 15

Insert the Whiteboard/Felt Tackboard into the Rear Panel Slot at an angle with a straight trajectory.

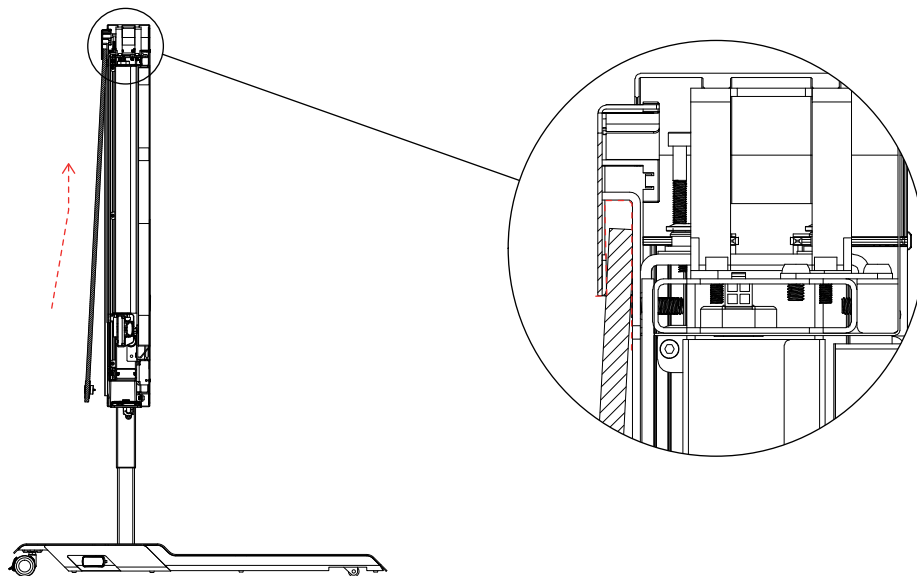

POWER CORD REPLACEMENT

Step 16

1. Ensure that the Rear Handset is aligned to the Handset Bezel opening. Press the Handset Bezel against the frame to ensure that it is magnetically engaged.
2. Ensure that the Push-Lock is aligned with the Push-Lock Socket. Flatten the Whiteboard/Felt Tackboard against the frame then press the Push-Lock Button on both sides to lock it in place.

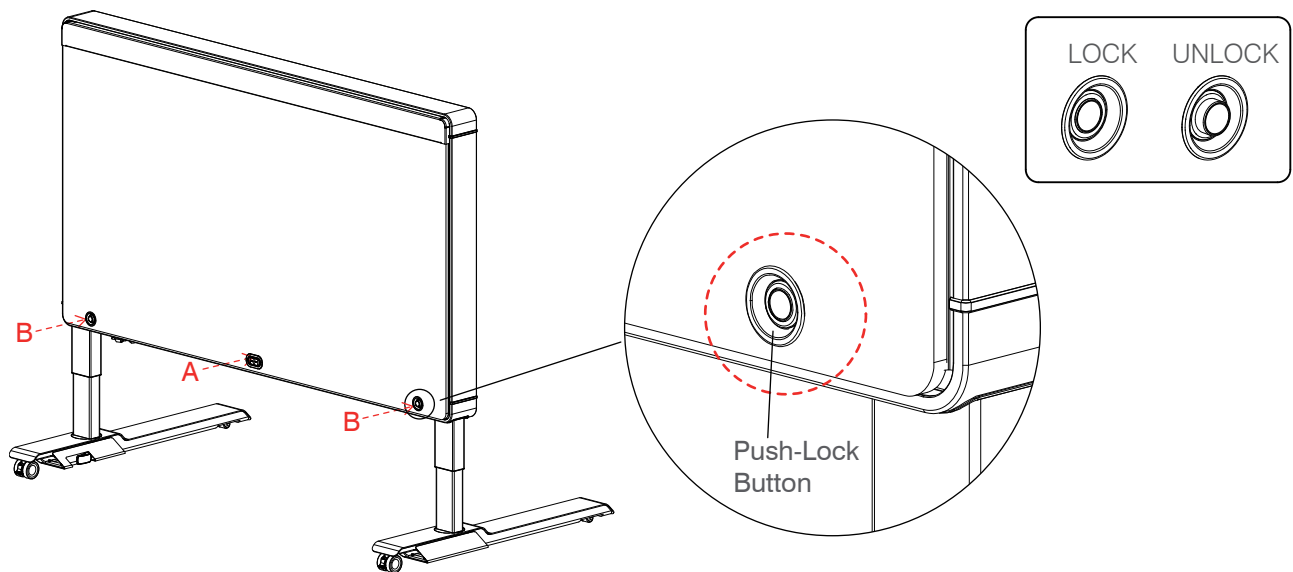

Whiteboard/Felt Tackboard can be locked or unlocked by pressing the Push-Lock Button.

Please contact cc@amqsolutions.com if you are missing any parts, have difficulty with assembly, or have any product related questions.