

Bodi

Assembly Guide

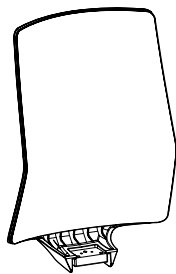

Components



Backrest

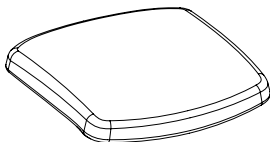

Seat

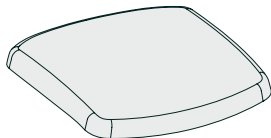

Seat Cover

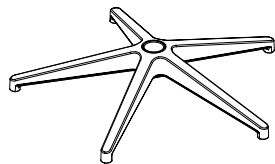

Base

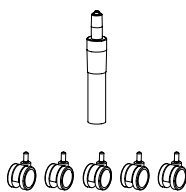

Gas Spindle/
Castor

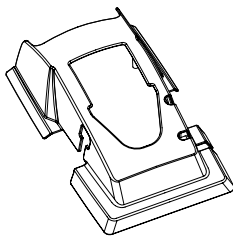

Mechanism Cover

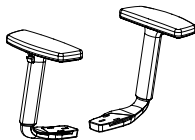

Armrest

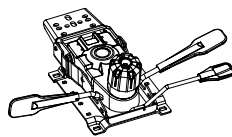

Mechanism

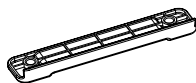

Mechanism Bar



M8X35
x3



M6X42
x2



M6X37
x6



M6X32
x2

Bolt Kit



Installation

Step 1

Insert seat shell into cover and zip closed.

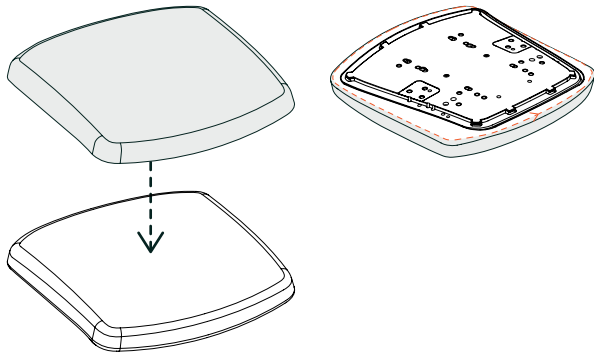

Step 2

Attach the armrest to the seat shell using six M6X37 bolts and tighten the six M6X37 screws.

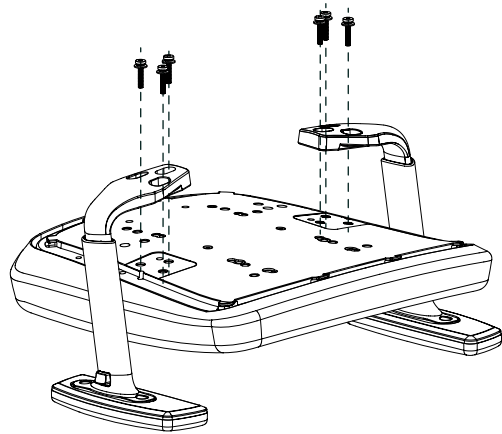

Step 3

Attach mechanism to seat shell using two M6X42 bolts and two M6X32 bolts with the mechanism bar as indicated below. Tighten the bolts.

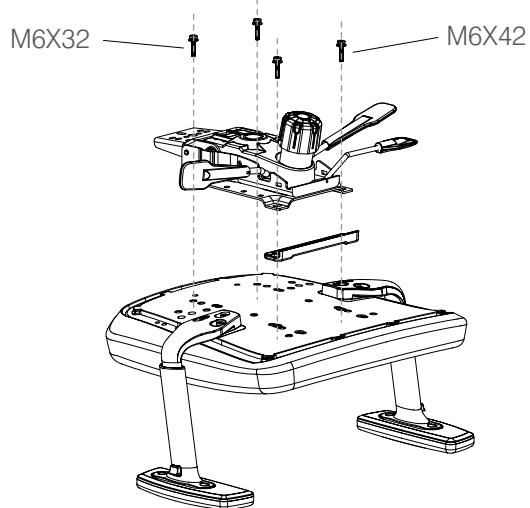

Step 4

Attach backrest to seat shell using three M8X35 bolts and tighten the bolts.

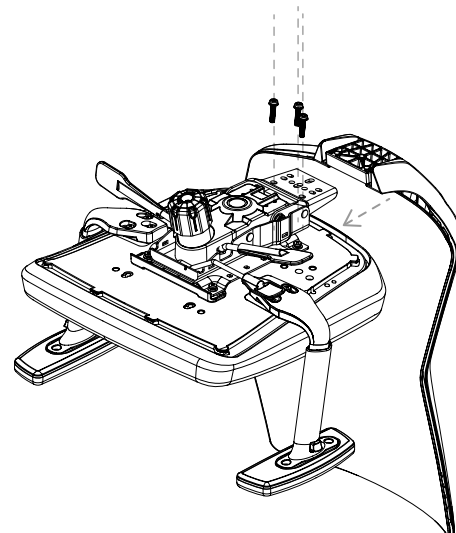

Installation

Step 5

Attach mechanism cover onto mechanism and make sure the four snaps indicated in red on mechanism cover fit into the four slots on mechanism.

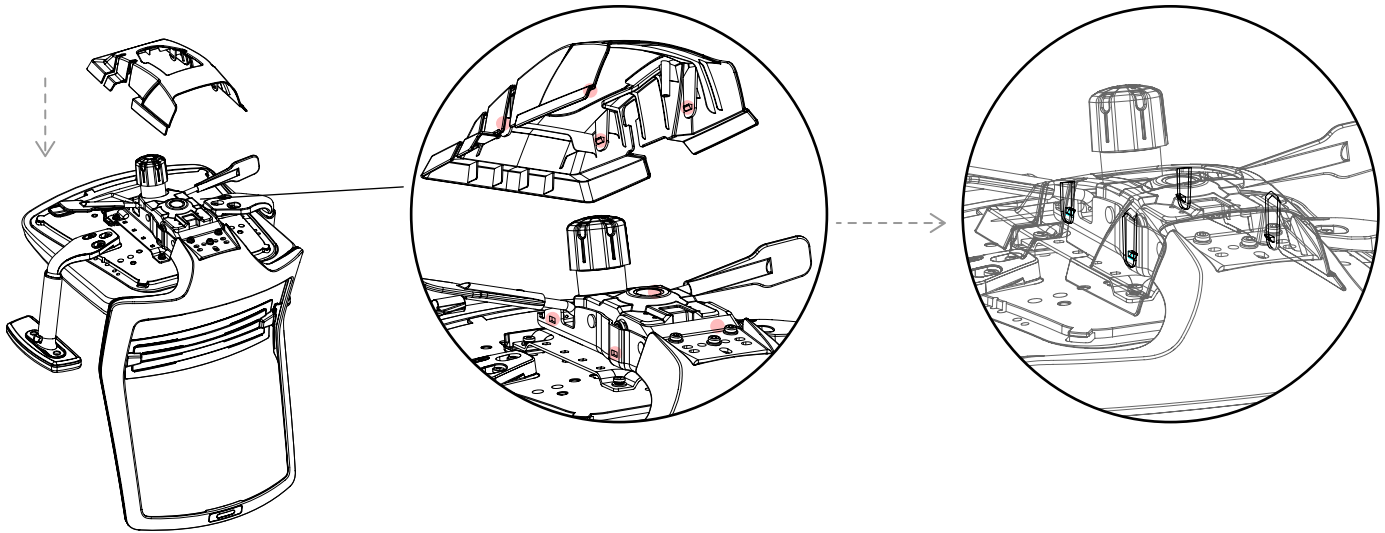

Step 6

Insert the castors onto leg base, then insert gas lifter onto top of leg base.

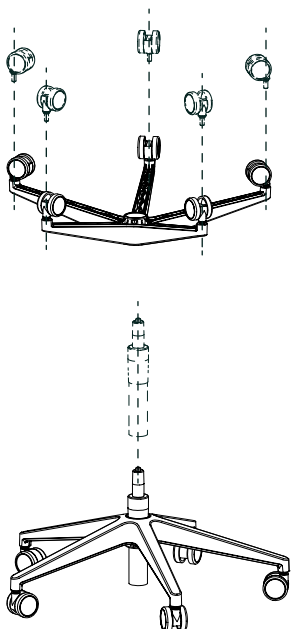

Step 7

Combine chair body with gas lifter via hole in mechanism.

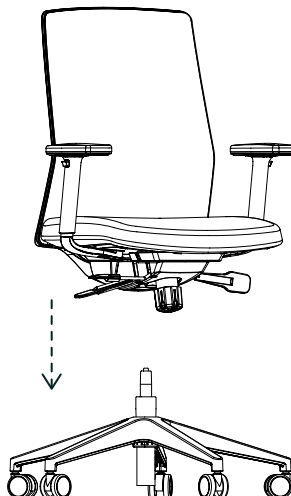

Step 8

Your Bodi chair is now ready to use.

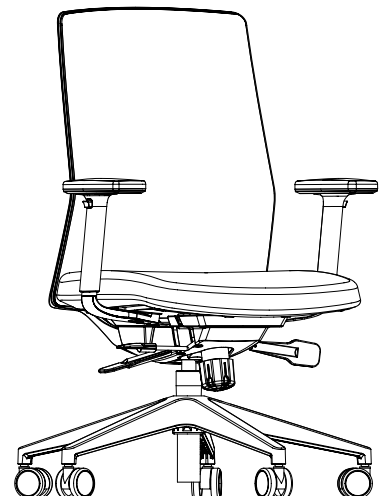

Changing Removable Seat Covers

Step 1

Pull the seat forward while pushing the lever under the seat.

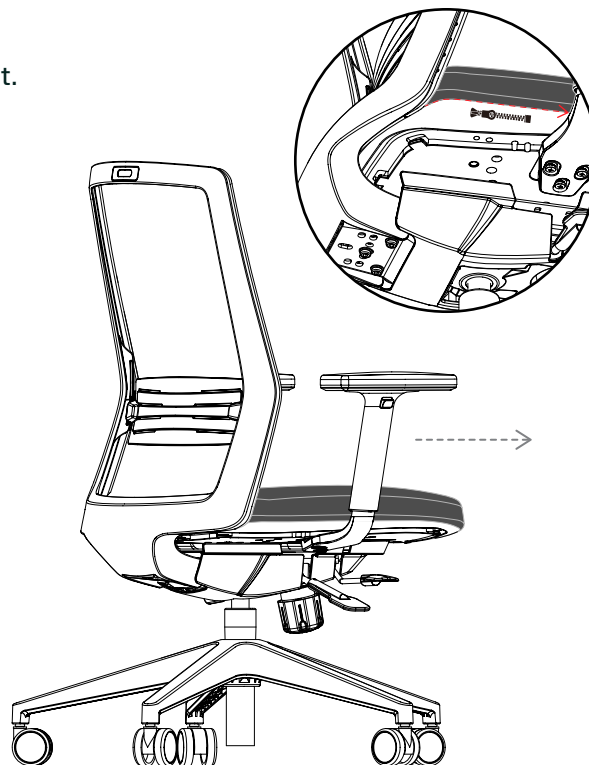

Step 2

Unzip the zipper on the back side and remove seat cover from the seat shell. Install new seat cover and zip to close.

